

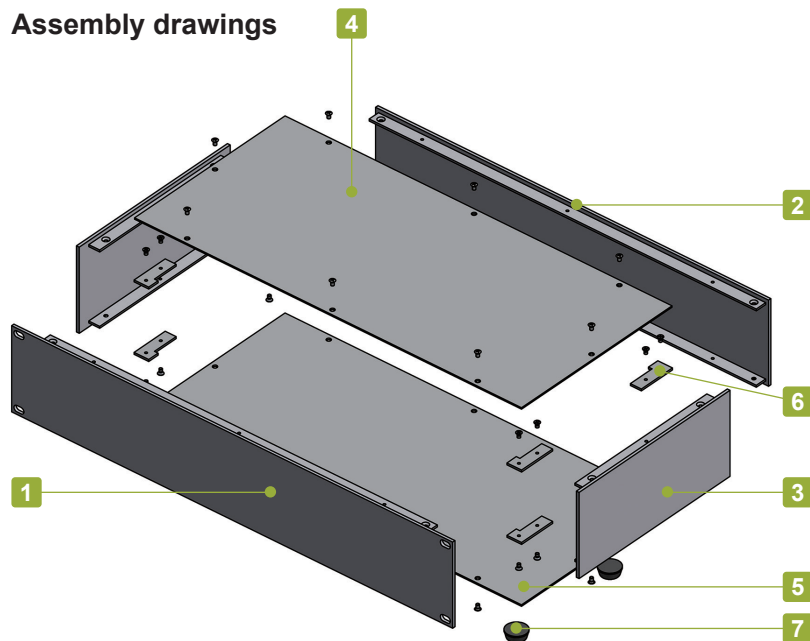

### Assembly drawings



- YER series is a rack-mount case with an effective width of 424mm and a large internal effective area.
- 19" rack case with reinforced panel with wide internal dimensions.
- 2 different color types available - Silver and Black.
- Flat panels allow a wide range of customization to be performed easily, such as milling, inkjet printing, engraving and more.

### Components

No.	Part name	Pcs	Material	Color / Finish
1	Panel	1	Extruded aluminium A6063S-T5	Silver • Black / Hairline brushed & Anodized
2	Rear panel	1	Extruded aluminium A6063S-T5	Silver / Hairline brushed & Anodized
3	Side plate	2	Extruded aluminium A6063S-T5	Silver / Hairline brushed & Anodized
4	Top cover	1	Aluminium A1100P t = 1.5	Metallic Silver / Painted (Conductive inside)
5	Bottom cover	1	Aluminium A1100P t = 1.5	Metallic Silver / Painted (Conductive inside)
6	Support bracket	8	Steel SPCC t = 2.0	Trivalent chromate
7	Rubber feet	4	Synthetic rubber	Black

Included screws  
M3-5 countersunk • Trivalent chromate x 17 pcs  
M3-5 original trapezoid head (plus) • Nickel plated x 17 pcs

■ Note: Top and Bottom covers are covered with a protective film on one side. Remove before assembly.

## YER dimensions

■ DXF/DWG/PDF/STP drawings available on our website.

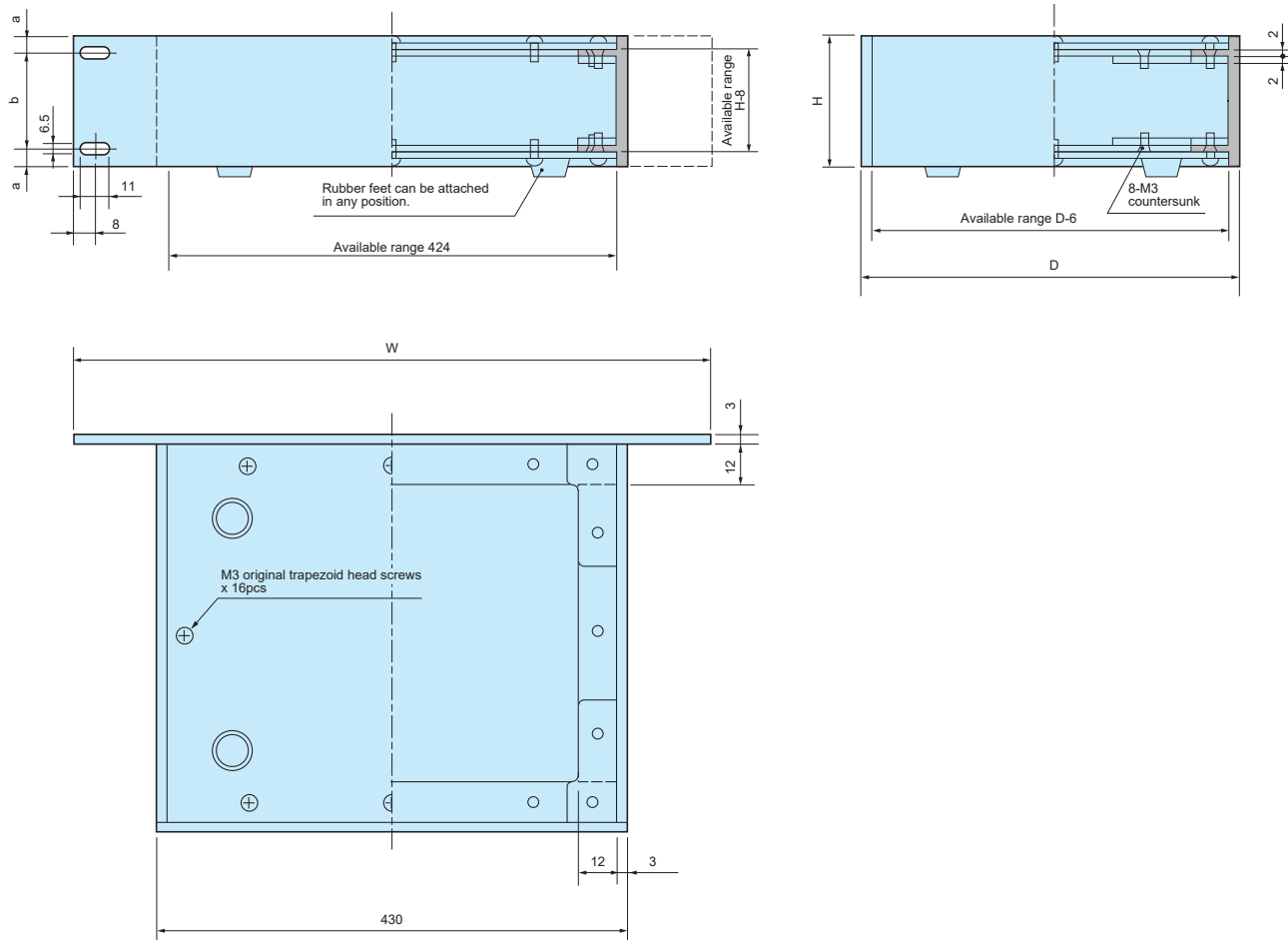

## Product no. / Details

Product no.		H	W	D	a	b	Weight (kg)
● Silver	● Black						
YER 44-20S	YER 44-20B	44	482.6	200	6.1	31.8	1.38
YER 44-32S	YER 44-32B	44	482.6	320	6.1	31.8	1.94
YER 88-20S	YER 88-20B	88	482.6	200	5.9	76.2	1.85
YER 88-32S	YER 88-32B	88	482.6	320	5.9	76.2	2.49
YER133-20S	YER133-20B	132.5	482.6	200	37.7	57.1	2.23
YER133-32S	YER133-32B	132.5	482.6	320	37.7	57.1	2.93