

- Simple structure and tough case with extruded aluminium covers
- 36 sizes and 2 different colors for a total of 72 different combinations.
- 2 or 3 grooves available on top/bottom covers for adjusting front/rear panel positions or PCB insertion.
- Optional mounting plate, mounting bracket, panel retainer, and TORX screw are available.
- Custom length is available

Components

No.	Part name	Pcs	Material	Color / Finish
1	Top cover	1	Extruded aluminium A6063S-T5	Light gray • Black / Painted
2	Bottom cover	1	Extruded aluminium A6063S-T5	Light gray • Black / Painted
3	Panel	2	Aluminium A1100P t=1.5	Light gray • Black / Painted
4	Joint plate	2	Steel SPCC t=2.0	Trivalent chromate
5	Screw (M3 flat head)	12	Steel	Black trivalent chromate
6	Rubber feet	4	Synthetic rubber	Black

■ Panels are covered with a protective film on one side.

Accessories (Optional parts)



Mounting plate UCC series
See page 261



Mounting bracket UCK-P series
See page 262



Panel retainer UCF-26
See page 262

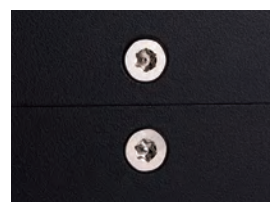

TORX screw MR-1
See page 123



Aluminium isolation feet AFS • AFM series
See page 293 ~ 294

UC dimensions

■ DXF/DWG/PDF/STP drawings available on our website.

Color Type

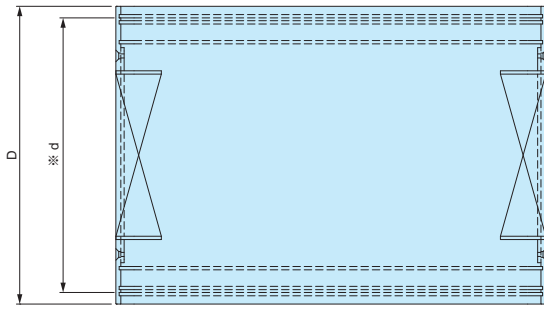

*d dimension varies depending on panel mount position. Dimensions listed are based on outermost mount position.

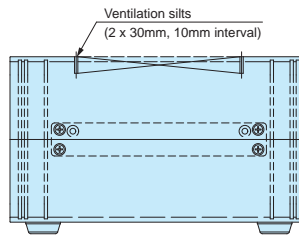
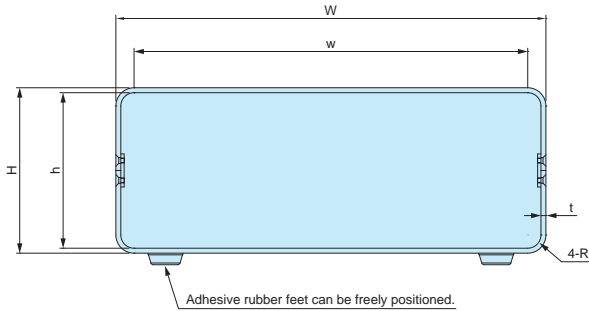

● GG



Cover	Light gray
Panel	Light gray

● BB



Cover	Black
Panel	Black

Product no. / Dimensions

- Please suffix color code at the end of the product number.
- See below chart for ventilation slits availability.

Product no.	External dimensions			Internal dimensions			R	t	Ventilation slits	Weight (kg)
	W	H	D	w	h	d				
UC 6- 3- 8□	60	35	80	50	31	72	3	2	—	0.12
UC 7- 3-10□	75	30	100	65	26	92	3	2	—	0.16
UC 7- 8-14□	75	85	140	60	80	130	5	2.5	—	0.37
UC 8- 3- 6□	80	30	60	70	26	52	3	2	—	0.10
UC 9- 5-12□	90	50	120	75	45	112	5	2.5	—	0.29
UC10- 4-14□	100	40	140	85	35	130	5	2.5	—	0.32
UC10-11-18□	100	110	180	78	104	166	8	3	—	0.72
UC11- 3- 8□	110	30	80	100	26	72	3	2	—	0.17
UC11- 5- 8□	110	50	80	100	46	72	3	2	—	0.20
UC12- 7-16□	120	70	160	98	64	146	8	3	—	0.56
UC12-14-22□	120	140	220	98	134	206	8	3	○	1.08
UC13- 4-18□	130	40	180	108	34	166	8	3	—	0.56
UC14- 4-10□	140	40	100	130	36	92	3	2	—	0.27
UC14- 6-10□	140	60	100	130	56	92	3	2	—	0.31
UC15- 8-20□	150	80	200	128	74	186	8	3	○	0.86
UC15-10-12□	150	100	120	135	95	112	5	2.5	—	0.53
UC15-18-28□	150	180	280	128	174	266	8	3	○	1.74
UC16- 5-22□	165	50	220	143	44	206	8	3	○	0.84
UC17- 5-12□	170	50	120	155	45	112	5	2.5	—	0.45
UC17- 7-12□	170	70	120	155	65	112	5	2.5	—	0.51
UC18-10-24□	180	100	240	158	94	226	8	3	○	1.26
UC18-21-34□	180	210	340	157.6	203.6	326	8	3.2	○	2.63
UC20- 5-14□	200	50	140	185	45	130	5	2.5	—	0.56
UC20- 8-14□	200	80	140	185	75	130	5	2.5	—	0.67
UC20-12-16□	200	120	160	178	114	146	8	3	—	0.82
UC22-12-26□	220	120	260	198	114	246	8	3	○	1.70
UC24-14-34□	240	140	340	217.6	133.6	326	8	3.2	○	2.54
UC26- 5-18□	260	50	180	238	44	166	8	3	○	1.02
UC26- 7-20□	260	70	200	238	64	186	8	3	○	1.23
UC26-10-18□	260	100	180	238	94	166	8	3	○	1.26
UC32- 5-22□	320	50	220	298	44	206	8	3	○	1.45
UC32- 8-24□	320	80	240	298	74	226	8	3	○	1.76
UC32-12-22□	320	120	220	298	114	206	8	3	○	1.88
UC35-13-26□	350	130	260	328	124	246	8	3	○	2.45
UC43- 5-28□	430	50	280	408	44	266	8	3	○	2.37
UC43-14-28□	430	140	280	408	134	266	8	3	○	3.05

UCC series

MOUNTING PLATE for UC

■ DXF/DWG/PDF drawings available on our website.



Type A

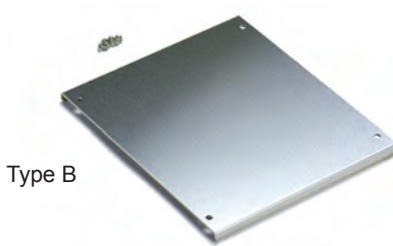
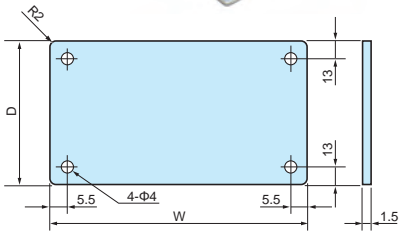

Type B

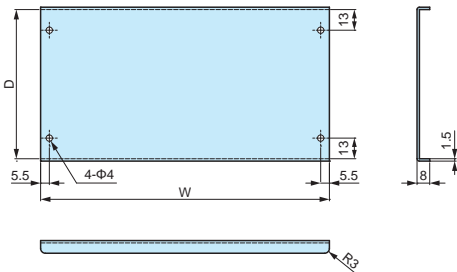

Type C

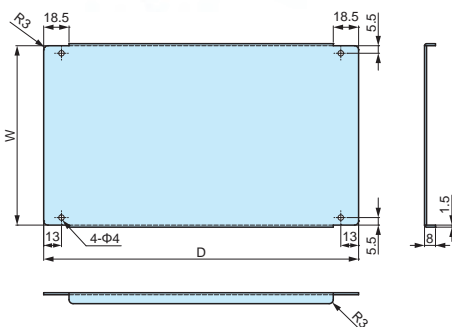

Components

Part name	Pcs	Material	Color / Finish
Mounting plate	1	Aluminium A1050P t=1.5	Unfinished
Screw	4	Steel M3-5	Trivalent chromate

Product no. / Dimensions (Type A)

Product no.	Suitable models	W	D
UCC 6- 8	UC 6- 3- 8	43	58
UCC 7-10	UC 7- 3-10	58	78
UCC 8- 6	UC 8- 3- 6	63	38
UCC11- 8	UC 11- 3- 8	93	58
	UC 11- 5- 8		
UCC 9-12	UC 9- 5-12	72	94
UCC10-14	UC 10- 4-14	82	94
UCC12-16	UC 12- 7-16	101	110
UCC13-18	UC 13- 4-18	111	130
UCC15-20	UC 15- 8-20	131	150
	UCG15- 9-20		
UCC14-10	UC 14- 4-10	123	78
	UC 14- 6-10		
UCC15-12	UC 15-10-12	132	94
UCC17-12	UC 17- 5-12	152	94
	UC 17- 7-12		
UCC 7-14	UC 7- 8-14	57	94
UCC10-18	UC 10-11-18	81	130
UCC12-22	UC 12-14-22	101	170

Product no. / Dimensions (Type B)

Product no.	Suitable models	W	D
UCC16-22	UC 16- 5-22	146	170
UCC18-24	UC 18-10-24	161	190
	UCG18-10-24		
UCC20-14	UC 20- 5-14	182	94
	UC 20- 8-14		
	UCG20- 9-14		
UCC22-26	UC 22-12-26	201	210
UCC20-16	UC 20-12-16	181	110
UCC26-18	UC 26- 5-18	241	130
	UC 26-10-18		
	UCG26-10-18		
UCC26-20	UC 26- 7-20	241	150
UCC32-22	UC 32- 5-22	301	170
	UC 32-12-22		
	UCG32-12-22		
UCC32-24	UC 32- 8-24	301	190
UCC35-26	UC 35-13-26	331	210
UCC43-28	UC 43- 5-28	411	230
	UC 43-14-28		

Product no. / Dimensions (Type C)

Product no.	Suitable models	W	D
UCC15-28	UC 15-18-28	131	230
UCC18-34	UC 18-21-34	160.6	290
UCC24-34	UC 24-14-34	220.6	290

UCK-P series MOUNTING BRACKET for UC



Components

Product name	Material	Finish	Pack of
Mounting bracket	Steel SPCC t=1.6	Trivalent chromate	4

Product no. / Dimensions

Product no.	Type	H1	C	C1	C2	Pack of
UCK-P 13	A	13	3	—	—	4
UCK-P 17	A	17	7	—	—	4
UCK-P 27	B	27	12	17	—	4
UCK-P 42	C	42	22	27	32	4
UCK-P 57	C	57	37	42	47	4
UCK-P 72	C	72	52	57	62	4
UCK-P 87	C	87	67	72	77	4
UCK-P102	C	102	82	87	92	4

■ DXF/DWG/PDF drawings available on our website.

UCK-P assembly drawings

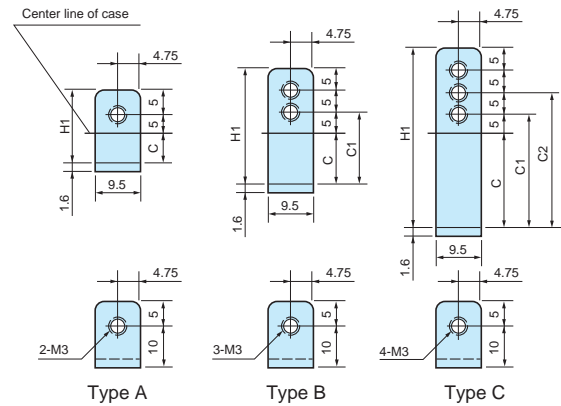
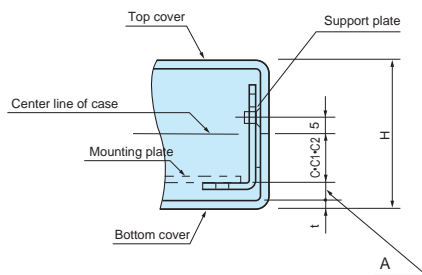

Bracket matching chart / A dimension

Product no.	Bracket no.	A	Product no.	Bracket no.	A	Product no.	Bracket no.	A
UC 6- 3- 8	UCK-P 13	12.5	UC 14- 4-10	UCK-P 13	15	UC 26-10-18	UCK-P 42	20 15
	UCK-P 17	8.5		UCK-P 17	11		UCK-P 57	10
UC 7- 3-10	UCK-P 13	10		UCK-P 27	6	UCG 26- 7-20	UCK-P 27	15
	UCK-P 17	6	UC 14- 6-10	UCK-P 27	16 11		UCK-P 42	10
UC 9- 5-12	UCK-P 17	15.5		UCK-P 42	6	UC 18-10-24	UCK-P 42	20 15
	UCK-P 27	10.5 5.5	UC 15- 9-20		UCK-P 42		10	UCK-P 57
UC 10- 4-14	UCK-P 13	14.5		UCK-P 57	20.5 15.5	UC 18-10-24	UCK-P 57	10
	UCK-P 17	10.5	UC 15-10-12		UCK-P 57		10.5 5.5	UC 22-12-26
	UCK-P 27	5.5		UCK-P 17	15.5	UC 32- 5-22	UCK-P 13	
UC 12- 7-16	UCK-P 27	15	UCK-P 27		10.5 5.5		UCK-P 17	15
	UCK-P 42	10		UC 17- 5-12	UCK-P 27	10.5 5.5		UCK-P 27
UC 13- 4-18	UCK-P 13	14	UCK-P 42		15.5	UC 32-12-22	UCK-P 57	
	UCK-P 17	10		UC 17- 7-12	UCK-P 42		10.5 5.5	UCG 32-12-22
UC 15- 8-20	UCK-P 42	15 10 5	UCK-P 13		19.5	UC 32- 8-24	UCK-P 57	
	UCK-P 13	19		UCK-P 17	15.5		UCK-P 72	10 5
	UCK-P 17	15			UCK-P 27			10.5 5.5
UC 16- 5-22	UCK-P 27	10	UC 20- 5-14	UCK-P 27		20.5	UCK-P 17	15
	UCK-P 27	5.5		UCK-P 42	15.5 10.5	UCK-P 27		10
	UC 24-14-34	UCK-P 57	19.8		UC 20- 8-14		UCK-P 42	15.5 10.5
UCK-P 72		14.8 9.8	UCK-P 42	5		UCK-P 57	20	
UC 8- 3- 6	UCK-P 13	10		UCG 20- 9-14	UCK-P 57		5	UCK-P 72
	UCK-P 17	6	UC 20-12-16		UCK-P 57	20 15 10	UCK-P 13	
UC 11- 3- 8	UCK-P 13	10		UC 26- 5-18	UCK-P 13	19		UCK-P 17
	UCK-P 17	6	UCK-P 17		15	UCK-P 27	10	
UC 11- 5- 8	UCK-P 17	16		UCK-P 27	10		UC 7- 8-14	UCK-P 42
	UCK-P 27	11 6	UC 26- 5-18		UCK-P 27	10		UC 10-11-18
UC 11- 5- 8	UCK-P 17	16		UCK-P 27	10	UC 12-14-22	UCK-P 72	
	UCK-P 27	11 6	UC 15-18-28		UCK-P 87		20 15 10	UC 18-21-34

UCF-26 PANEL RETAINER for UC



UCF-26 drawings

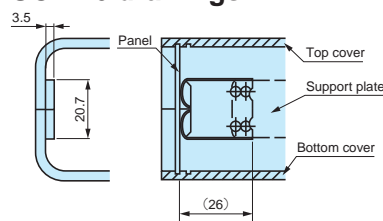

■ DXF/DWG/PDF drawings available on our website.

Product no.

Product no.	Material	Finish	Pack of
UCF-26	Stainless steel t=0.3	Unfinished	2

■ Not applicable for use on 60, 80, 100 and 120 "D" dimension cases.

EM series

PCB MOUNTING SCREW

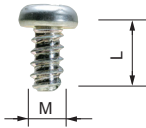

- Self-tapping screws for mounting PCB on bosses or standoffs.
- EM-3-6 self-tapping screws are suitable for mounting 1.6mm or thicker PCB.

Product no. / Dimensions

Product no.	M	L	Material	Finish	suitable models	Pack of
EM-1.6	1.6	4	Steel	Trivalent chromate	CSS • CS WC • PS (M1.6 boss models)	50
EM-2	2	5	Steel	Trivalent chromate	SIC • SIM • WC • PS • TW • TWN • TWF WC • WP (M2 boss models)	50
EM-2.3	2.3	6	Steel	Trivalent chromate	WH • LC • LCT • LCS • LCE • PFE WSC (Top cover bosses) PF • PFF (M2.3 boss models) TW • TWN • TWF (M2.3 boss models) WP (M2.3 boss models)	50
EM-2.3-8	2.3	8	Steel	Trivalent chromate	WSC (Bottom base bosses)	50
EM-2.6	2.6	6	Steel	Trivalent chromate	PF • PFF • WP (M2.6 boss models)	50
EM-3	3	5	Steel	Trivalent chromate	TWS • TW • TWN • TWF (M3 boss models)	50
EM-3-6	3	6	Steel	Trivalent chromate		50

MR series

TORX SCREW

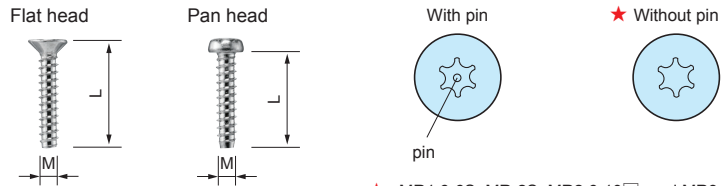

★ : MR1.6-6S, MR-2S, MR2.6-10□, and MR3-14□ are without pin.

Product no. / Dimensions

★ Mark = Without pin

Product no.	M	L	head no.	Head style	Material	Finish	Suitable models	Pack of
MR1.6-6S★	1.6	6	T3	Pan	Steel	Nickel plated	CSS • CS	20
MR2.5-8PS	2.5	8	T8	Pan	Steel	Nickel plated	PF • PFE • PFF (M2.5 boss models)	20
MR2.6-10S★	2.6	10	T8	Flat	Steel	Nickel plated	TW • TWN (M2.6 boss models) TWF (M2.6 boss models)	20
MR2.6-10B★	2.6	10	T8	Flat	Steel	Black trivalent chromate	MX • MXA • MXB • MXF (M2.6 boss models)	20
MR2.6-12PS	2.6	12	T8	Pan	Steel	Nickel plated	LCT • LCS • LC115-F2 / F3 LCT • LCS • LC145S-F6	20
MR2.6-14PS	2.6	14	T8	Pan	Steel	Nickel plated	LCT • LCS • LC115H-F2 / F3 / M2 / 9V LCT • LCS • LC135-F4 / M2 / M3 / 9V LCT • LCS • LC135H-F4 / M2 / M3 / 9V LCT • LCS • LC145-F6 / M2 / M4 LCT • LCS • LC145H-F6 / M2 / M4 LCT • LCS • LC165-M4 LCT • LCS • LC165H-M4	20
MR2.6-14S	2.6	14	T8	Flat	Steel	Nickel plated	LCT • LCS • LC115-N / F2 / F3 LCT • LCS • LC145S-F6 / 145S-N LCE115-N TW • TWN7-2-11 / 7-4-11 / 7-5-11 TWF7-2-11 / 7-4-11 / 7-5-11 / 8-2-8 / 8-4-8	20
MR2.6-18S	2.6	18	T8	Flat	Steel	Nickel plated	LCT • LCS • LC115H-N / F2 / F3 / M2 / 9V LCT • LCS • LC135-N / F4 / M2 / M3 / 9V LCT • LCS • LC135H-N / F4 / M2 / M3 / 9V LCT • LCS • LC145-N / F6 / M2 / M4 LCT • LCS • LC145H-N / F6 / M2 / M4 LCT • LCS • LC165-N / M4 LCT • LCS • LC165H-N / M4 LCE115H-N • LCE135-N • LCE145H-N • LCE165H-N	20
MR3-8PS	3	8	T10	Pan	Steel	Nickel plated	PF • PFE • PFF (M3 boss models)	20
MR3-14S★	3	14	T10	Flat	Steel	Nickel plated	TW • TWN (M3 boss models) TWF (M3 boss models)	20
MR3-14B★	3	14	T10	Flat	Steel	Black trivalent chromate	MX • MXA • MXB • MXF (M3 boss models)	20
MR-1S	3	5	T10	Flat	Steel	Nickel plated	UC	20
MR-1B	3	5	T10	Flat	Steel	Black trivalent chromate		20

AFS•AFM series

ALUMINIUM ISOLATION FEET



- The surface treatment and finish allows the feet to exhibit a polished and luxurious feel.
- Non-slip NBR O-ring is present on the underside of the feet.
- Suitable for use in audio devices.

Available in both internal and external screw installation type.

External type / Shot blast finish (AFS series)



The external type is secured via screws from the underside / base of the feet to the enclosure. A thread hole is required for direct securing, while a circular hole is required for lock nut securing.

The shot blast finish provides a high quality surface finish look, and pairing well with various types of enclosure surfaces.

Available in both silver and black.

Internal type / Reflective finish (AFM series)



The internal type is secured via screws from the inside of the enclosure. A circular hole is required for securing into the pre-made threads in the top-side of the feet.

The reflective surface finish adds a high quality touch to the unit, allow it to have a luxurious look.

Available only in Silver.

Accessories (Optional parts)

Product no. / Dimensions

Product no.		D	H	Installation type	C	a	b	Pack of
● Silver	● Black							
AFS20- 8S	AFS20- 8B	20	8	External	Φ3.4	3	9	4
AFS25-10S	AFS25-10B	25	10	External	Φ4.5	4	12	4
AFS30-12S	AFS30-12B	30	12	External	Φ4.5	5	12	4
AFS35-14S	AFS35-14B	35	14	External	Φ4.5	5	12	4
AFS39-16S	AFS39-16B	39	16	External	Φ4.5	5	15	4
AFS44-18S	AFS44-18B	44	18	External	Φ4.5	5	20	4
AFS55-20S	AFS55-20B	55	20	External	Φ5.5	5	20	4
AFM15- 7S	-	15	7	Internal	M3	4	-	4
AFM20- 9S	-	20	9	Internal	M3	5	-	4
AFM25-12S	-	25	12	Internal	M4	7	-	4
AFM30-14S	-	30	14	Internal	M4	8	-	4
AFM35-16S	-	35	16	Internal	M4	10	-	4
AFM39-18S	-	39	18	Internal	M4	10	-	4
AFM44-20S	-	44	20	Internal	M4	10	-	4
AFM55-22S	-	55	22	Internal	M5	15	-	4

AFS • AFM dimensions

■ DXF/DWG/PDF/STP drawings available on our website.

AFS SERIES

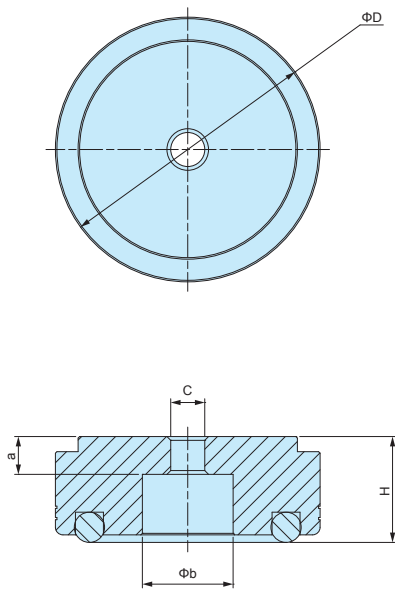

AFM SERIES

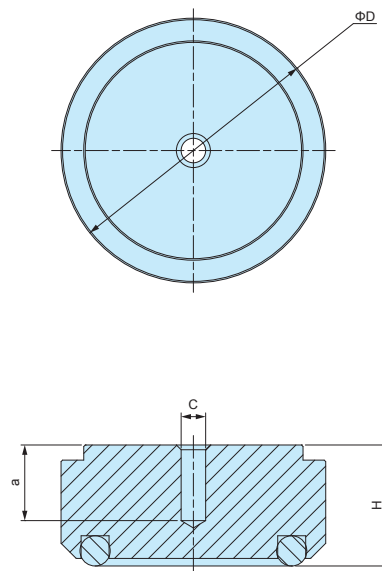

APPLICATION EXAMPLE



TLW series TILT LEG



APPLICATION EXAMPLE

- Double shot injection molded feet with soft and well-designed rounded shape.
- Non-slip design with Elastomer (TPE) pad.
- Available in 3 different color patterns (2 color patterns for TLW-70 models).
- TLW-70E models are exclusively for use with width 185mm or larger bottom covers of EXP • EXPE • EXW • EX • EXH • EXHE aluminium enclosures.

Technical Data
Max load : 7kg

Components

No.	Part name	Pcs	Material	Color / Finish
1	Front foot	2	PC + ABS UL94V-0 • TPE	Black & Black • Navy & Gray • Light gray & Gray
2	Rear foot	2	PC + ABS UL94V-0 • TPE	Black & Black • Navy & Gray • Light gray & Gray
-	Screw	4	Steel M3-8 pan head	Black trivalent chromate
-	Nut	4	Steel M3	Black trivalent chromate

TLW dimensions

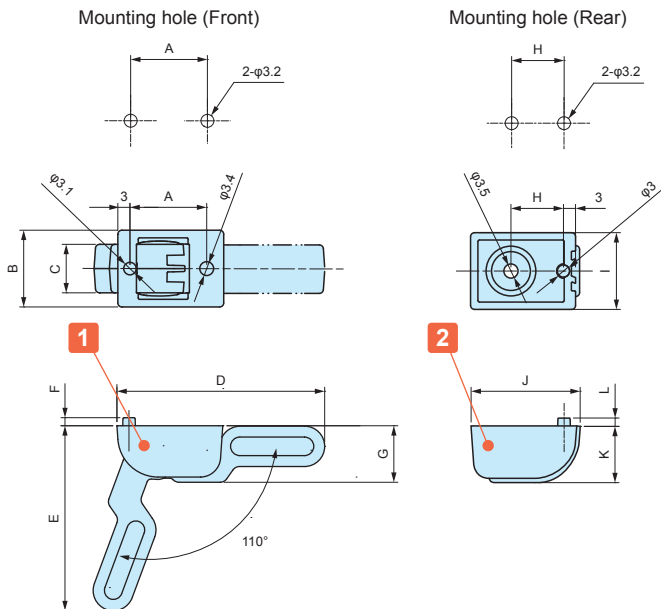

- DXF/DWG/PDF/STP drawings available on our website.

- TLW-70E□□ models are for installation (with M3 nut) into the built-in grooves on bottom-covers of EXP • EXPE 20-6, EXH • EXHE • EX 19-4 or larger models.
- Hole milling is required to install TLW-46□□ and TLW-70□□ models.
- Max installation panel thickness : t = 3.5mm

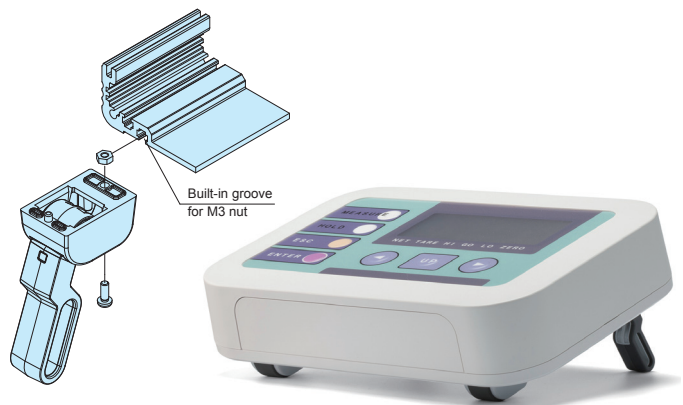

Product no. / Dimensions

Product no.	A	B	C	D	E	F	G	H	I	J	K	L	Color (plastic)	Color (TPE)	Weight (g)
TLW-46BB	19	19	12	51.2	45.9	2	14	13	19	27	14	2	Black	Black	23
TLW46-NG	19	19	12	51.2	45.9	2	14	13	19	27	14	2	Navy	Gray	23
TLW-46LG	19	19	12	51.2	45.9	2	14	13	19	27	14	2	Light gray	Gray	23
TLW-70EBB	-	25	16	75.4	69	3	21.5	-	25	39	21.5	3	Black	Black	59
TLW-70ENG	-	25	16	75.4	69	3	21.5	-	25	39	21.5	3	Navy	Gray	59
TLW-70ELG	-	25	16	75.4	69	3	21.5	-	25	39	21.5	3	Light gray	Gray	59
TLW-70BB	30	25	16	75.4	69	2	21.5	20	25	39	21.5	2	Black	Black	59
TLW-70LG	30	25	16	75.4	69	2	21.5	20	25	39	21.5	2	Light gray	Gray	59