

THB390•400 series

IP68 RELAY CONNECTOR



- IP68 relay connector with screw type wiring connection for easy installation and removal.
- 3P, 6P, 2WP and 3WP pole models and no terminal model are available.
- No terminal model can be used to protect the connector.
- Possible to adopt wide cable range with the optional sealing insert.
(See page Sealing insert - 2 for the details.)
- Screws may be screwed in firmly. Use a screwdriver with proper grip handles to loosen it.



Technical Data
Protection class : IP68 5bar/1h (1 hour / 50m depth)
Operating temperature : -40°C ~ +125°C
EN60529 : 1991+A1 : 2000, EN60998-1 : 2004, EN60998-2-1 : 2004 compliant

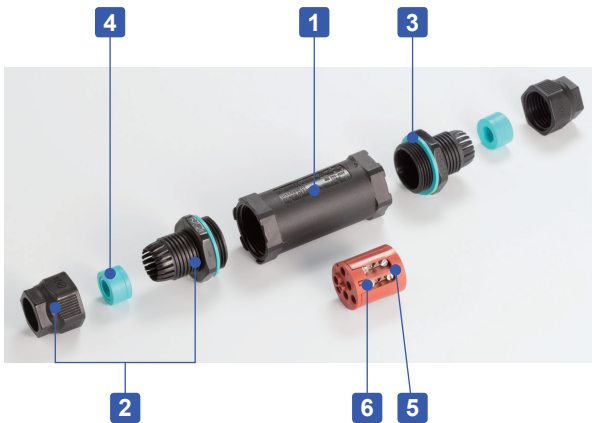

Specifications

3P • 4P • 6P models

Rated voltage	AC450V
Rated current	24A
Applicable wire	Stranded wire 0.5mm ² ~ 2.5mm ²

2WP • 3WP models

Rated voltage	AC250V
Rated current	32A
Applicable wire	Stranded wire 0.5mm ² ~ 4.0mm ²

D4P model

Rated voltage	AC750V
Rated current	41A
Applicable wire	Stranded wire 2.5mm ² ~ 6.0mm ²

Components

■ PA66 = Polyamide 66
■ PA66GF = Glass fiber filled polyamide 66

No.	Part name	Pcs	Material	Color / Finish
1	Body	1	PA66GF (UL94V-0)	Black
2	Cable gland	2	PA66 (Φ7 ~ Φ13.5, Φ13.5 ~ Φ15.5, Φ16 ~ Φ20) • PA6 (Φ8 ~ Φ17)	Black
3	Gasket	2	Silicone	Green
4	Sealing insert	2	TPE (Φ7 ~ Φ13.5, Φ13.5 ~ Φ15.5, Φ16 ~ Φ20) • NBR (Φ8 ~ Φ17)	Green • Black
5	Terminal block	1	PA66GF (UL94V-0)	Black • Brown
6	Terminal screw (M3 slotted)	6 ~ 12	Steel	Zinc plated

Accessories (Optional parts)

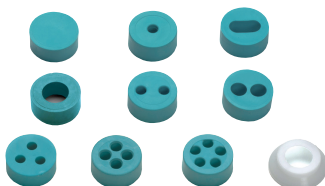

Sealing insert
See page Tool-5



Exclusive bracket
See page Tool-6



Exclusive tightening tool
See page Tool-5

Product no. / Details

Product no.	L	D	Cable range	Number of poles
THB390-3P-13	90	32	Φ7 ~ Φ13.5	3P
THB400-N-13	134	35	Φ7 ~ Φ13.5	None
THB400-4P-13	134	35	Φ7 ~ Φ13.5	4P
THB400-6P-13	134	35	Φ7 ~ Φ13.5	6P
THB400-2WP-13	134	35	Φ7 ~ Φ13.5	2WP
THB400-3WP-13	134	35	Φ7 ~ Φ13.5	3WP
THB400-D4P-13	134	35	Φ7 ~ Φ13.5	D4P
THB400-N-17	137	35	Φ8 ~ Φ17	None
THB400-4P-17	137	35	Φ8 ~ Φ17	4P
THB400-6P-17	137	35	Φ8 ~ Φ17	6P
THB400-D4P-15	134	37	Φ13.5 ~ Φ15.5	D4P
THB400-N-20	134	37	Φ16 ~ Φ20	None
THB400-D4P-20	134	37	Φ16 ~ Φ20	D4P

THB390 • 400 dimensions

■ DXF/DWG/PDF drawings available on our website.

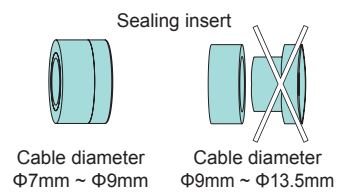
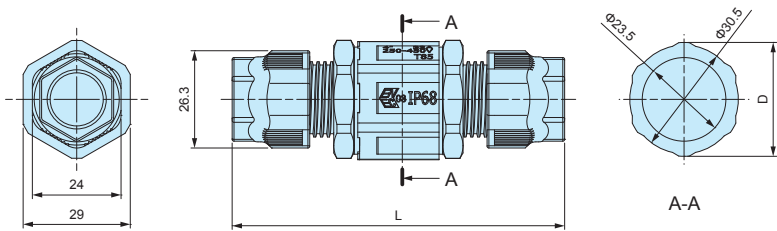

Product no.	Cable range	Number of poles
THB390-3P-13	Φ7 ~ Φ13.5	3P

■ Applicable cable size range can be expanded by removing the inner sealing insert.

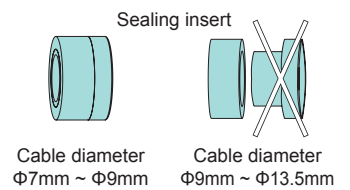
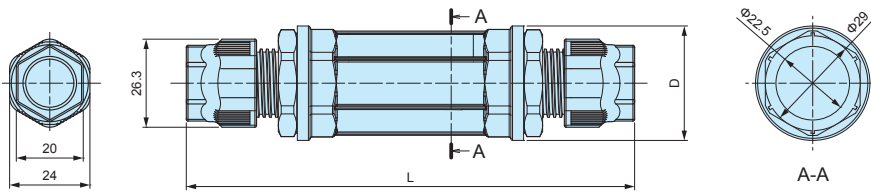

Product no.	Cable range	Number of poles
THB400-□-13	Φ7 ~ Φ13.5	N (No terminal) • 4P • 6P • 2WP • 3WP • D4P

■ Applicable cable size range can be expanded by removing the inner sealing insert.

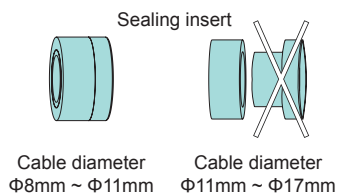
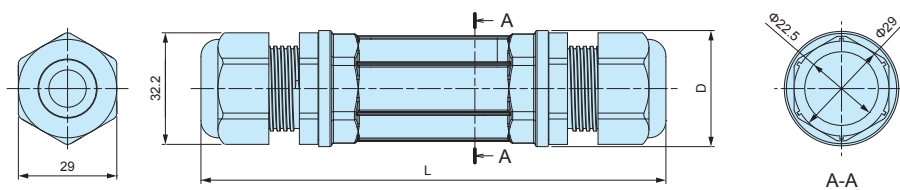

■ Optional sealing insert and exclusive tightening tool is not usable for this model.

Product no.	Cable range	Number of poles
THB400-□-17	Φ8 ~ Φ17	N (No terminal) • 4P • 6P

■ Applicable cable size range can be expanded by removing the inner sealing insert.

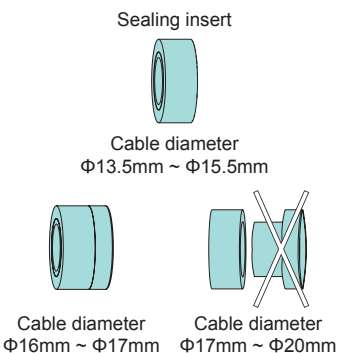
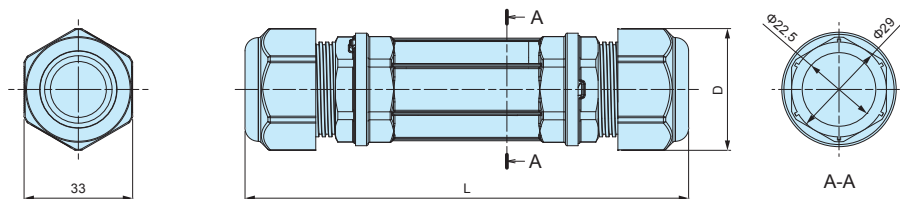

■ Optional sealing insert and exclusive tightening tool is not usable for this model.

Product no.	Cable range	Number of poles
THB400-D4P-15	Φ13.5 ~ Φ15.5	D4P
THB400-□-20	Φ16 ~ Φ20	N (No terminal) • 4P

■ Applicable cable size range can be expanded by removing the inner sealing insert.

Terminal block diagram

No Terminal Model (N type)

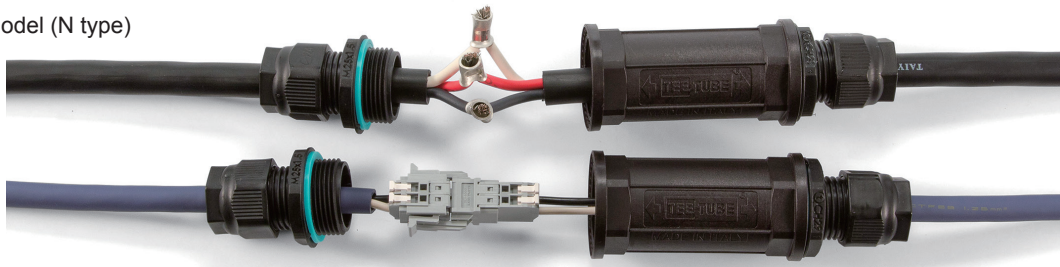

- No terminal model.
- Use when utilizing other terminals or connecting without terminal.

3P Terminal

Wire Connection Diagram

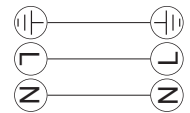
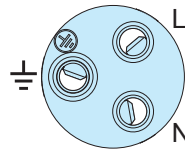
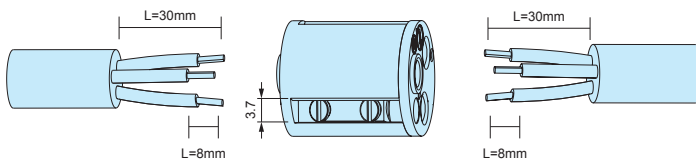

- A flathead (minus) screwdriver of tip width 3mm is recommended to be used.

4P Terminal

Wire Connection Diagram

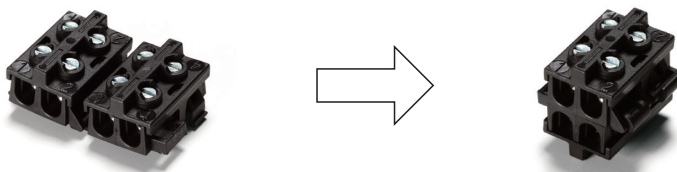
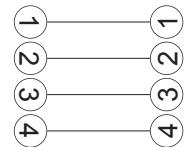
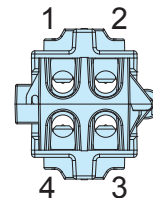
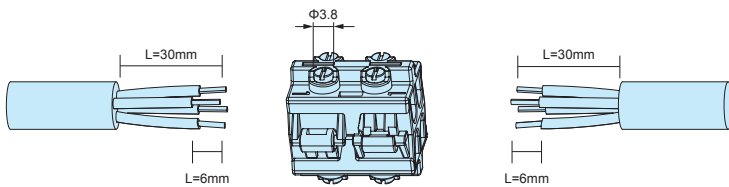

- A hinged structure on the 4P terminal block allows wiring to be performed easily.
- Easily closed for installation.
- A flathead (minus) screwdriver of tip width 3mm is recommended to be used.

6P Cable diameter

Cable diameter

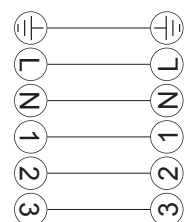
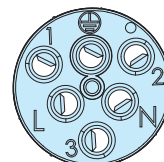
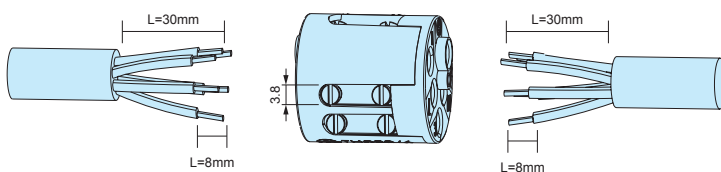

- A flathead (minus) screwdriver of tip width 3mm is recommended to be used.

2WP Terminal

Wire Connection Diagram

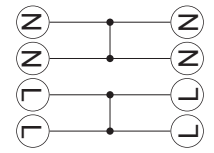
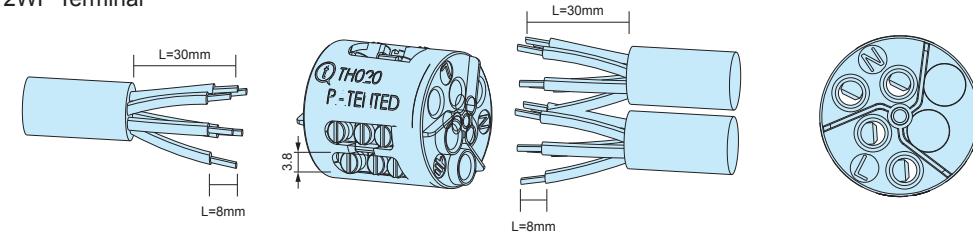

Two poles are divided into two.
(Each is common)



- Wiring can be branched.
Use optional sealing insert for branch wiring.(See page Sealing Insert-1 for optional sealing inserts.)
- A flathead (minus) screwdriver of tip width 3mm is recommended to be used.

3WP Terminal

Wire Connection Diagram

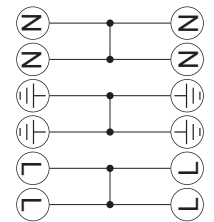
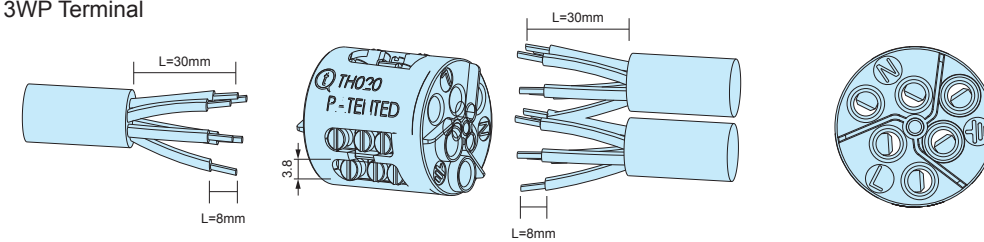

Two poles are divided into three.
(Each is common)



- Wiring can be branched.
Use optional sealing insert for branch wiring.(See page Sealing Insert-1 for optional sealing inserts.)
- A flathead (minus) screwdriver of tip width 3mm is recommended to be used.

D4P Terminal

Wire Connection Diagram

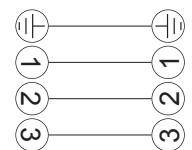
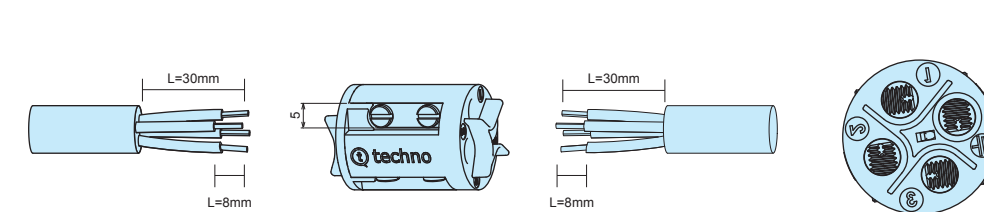

- A flathead (minus) screwdriver of tip width 3mm is recommended to be used.

SEALING INSERT for THA • THB • THS

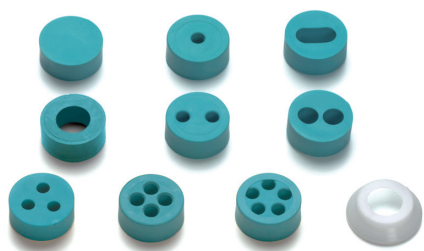

- Optional sealing insert for THA209, THB387L, 387LE, 389, 389E, 390, 399Y, 400, 402T, 405, 406, THS389 and 389E.
(Not applicable to be used for THB381, 381E, 387, 387E, 391 and 392 series.)
- Recommended to be used to change the compatible wire diameter, or for installation of multiple wires.
- 6000087LF cap can be used to prevent the rubber bushing from protruding, as well as stabilizing the waterproof performance when using wire of diameter 7.0mm or smaller.

Product no. / Details

Product no.	Appearance	Cable range	Material	Pack of
600013700		Blind insert without hole	TPE	10
600012700		11mm x 5.5mm	TPE	10
600037000		Φ4.0 ~ Φ6.5mm	TPE • POM	10 each
604001100		Φ5.5 ~ Φ9.5mm Use fixing cap for cables sized Φ7.0mm or smaller	TPE • POM	10 each
600013600		Φ2.0 ~ Φ4.0mm	TPE • POM	10 each
600012500		Φ2.0 ~ Φ4.0mm	TPE • POM	10 each
600030600		Φ4.5 ~ Φ6.0mm	TPE	10
600012600		Φ2.0 ~ Φ4.0mm	TPE	10
600018200		Φ2.0 ~ Φ3.5mm	TPE	10
600022400		Φ2.5 ~ Φ3.5mm	TPE	10
6000087LF		Cap for cables sized Φ7.0mm or smaller	POM	10

6000087LF cap cannot be used with 600030600 and 600022400

EXCLUSIVE TIGHTENING TOOL for THB • THS



How to use

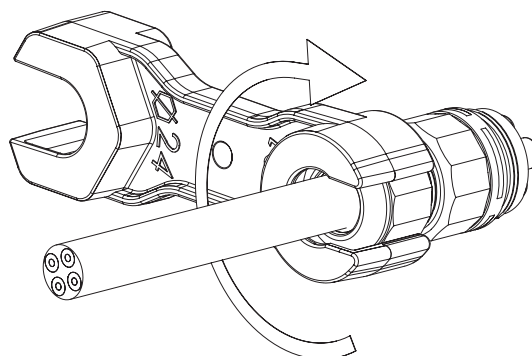

Dedicated locking tool for tightening of the cable gland cap.

Product no. / Details

Product no.	Material / Color	Suitable models
6000337BC	PA66GF / Black	THB387 • 387E • 387L • 387LE • 389 • 389E • 390 • 390T • 391 • 392 • 399Y • 400 • 402T • 405 • 406 • THS389 • 389E

PA66GF = Glass fiber filled polyamide 66

EXCLUSIVE BRACKET for THB

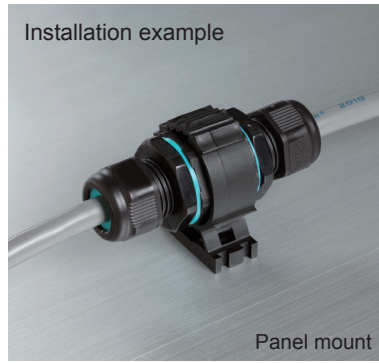

- Optional bracket for affixing onto panels, poles etc.
- Recommended for affixing / securing connectors onto a surface.

■ DXF/DWG/PDF drawings available on our website.

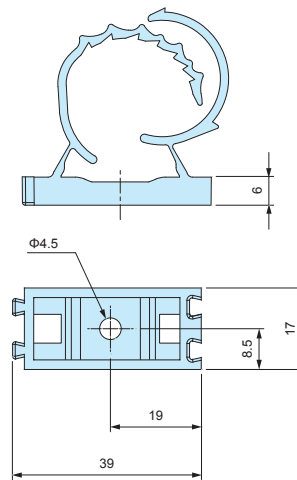

Product no. / Details

■ PA66 = Polyamide 66

Product no.	Material / Color	Suitable models
6000302CC	PA66 / Black	THB387 • 387L • 390 • 390T • 391 • 399Y • 400 • 402T • 405

Application Example - Waterproof Connector

Outdoor LED Lighting Connection

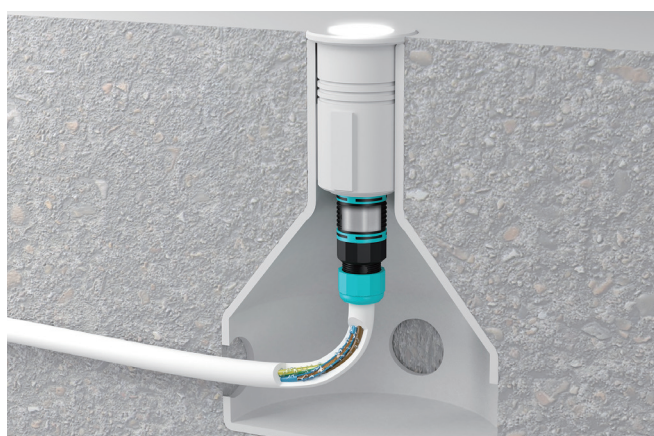
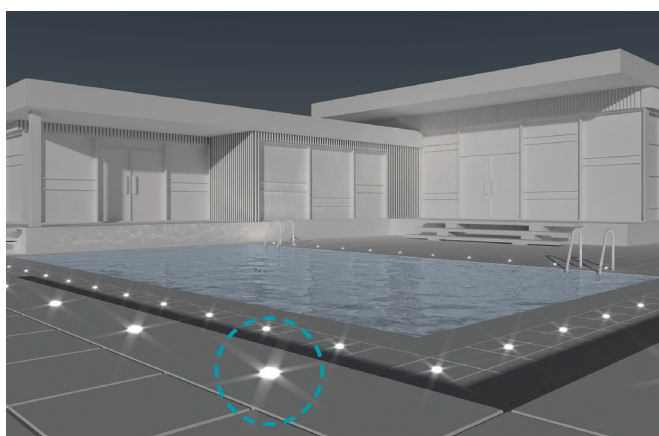
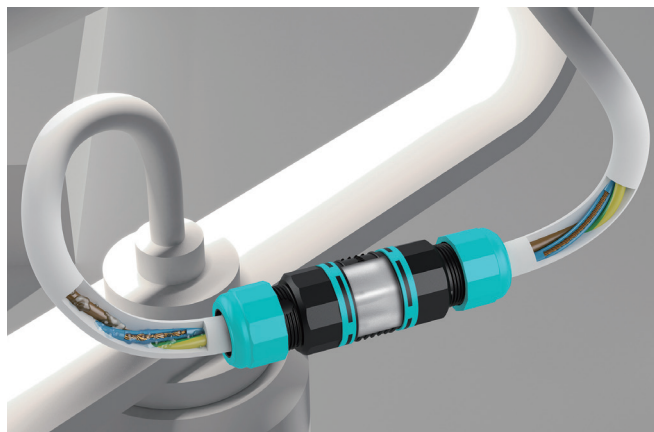
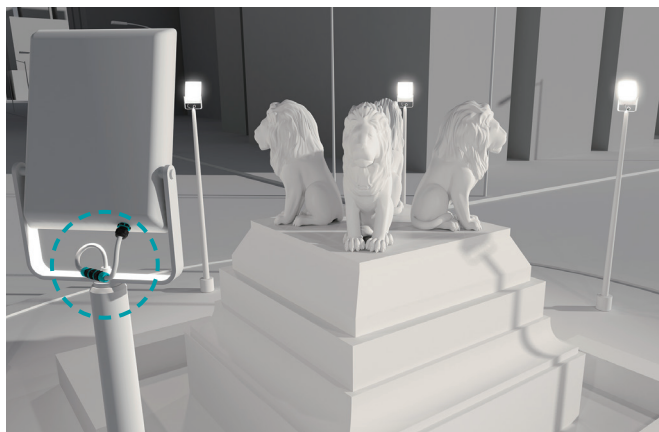

Application Example-1

Industrial Motor Connection

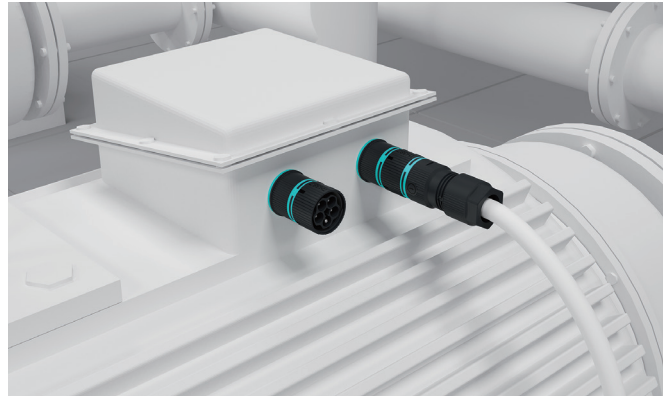
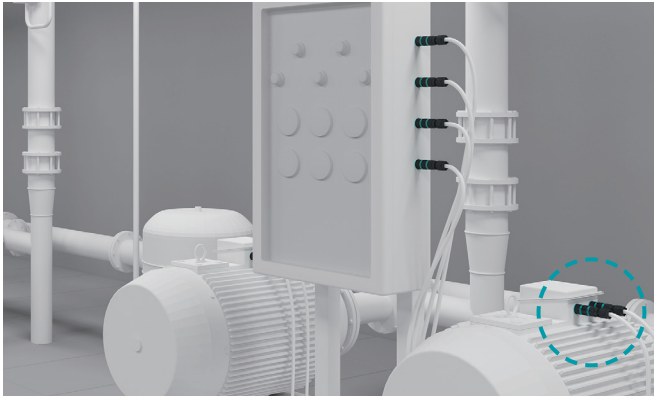

Sprinkler System Connection

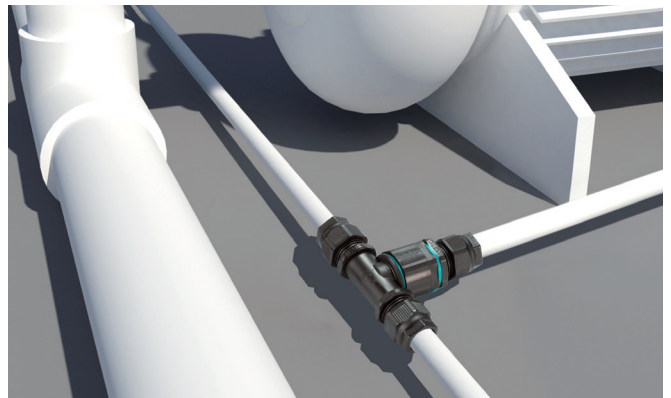
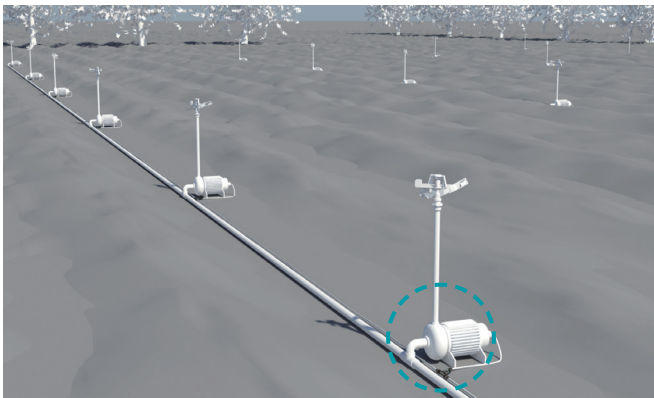

Power / Sensor Signal Relay in Factory Automation

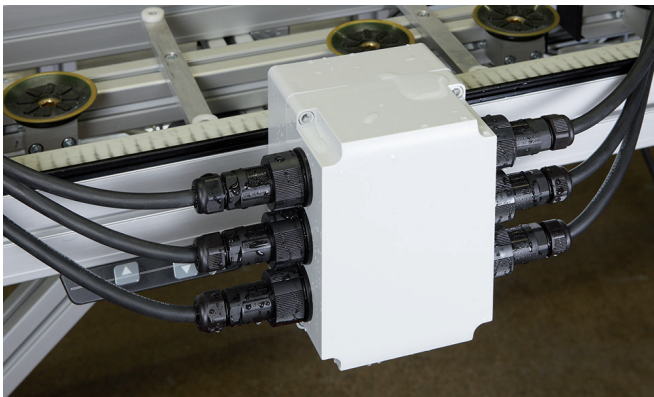

Machinery



Circuit Breaker Connector



Underground • Underfloor Wiring

