

FM200 series

ELASTOMER CARRYING HANDLE

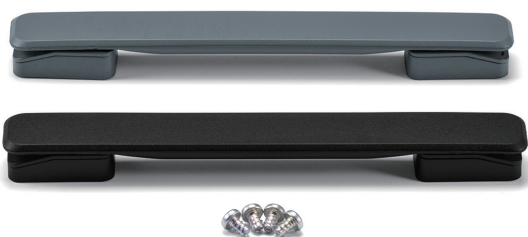

- Comfortable and easy to grip elastomer handle.

Product no. / Details

Product no.	
● Black	● Gray
FM200B	FM200G

Technical Data

Max load : 20kg

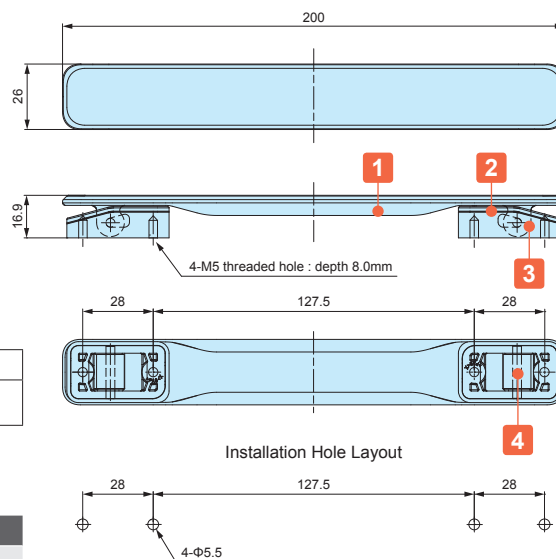

Components

No.	Part name	Pcs	Material	Color / Finish
1	Grip	1	PU	Black • Gray
2	Base	2	PA6	Black • Gray
3	Base cover	2	ABS	Black • Gray
4	Shaft	2	SWCH	Nickel plated
-	Self-tapping screw (Pan head M5-8)	4	Steel	Trivalent chromate

MH series

CARRYING HANDLE



- If chemicals, cutting fluid, etc. adhered to, or come into contact with areas where tensile stress is generated, there is a possibility that cracks may develop due to the synergistic effect of the chemicals and stress.

Technical Data

Max load : 20kg

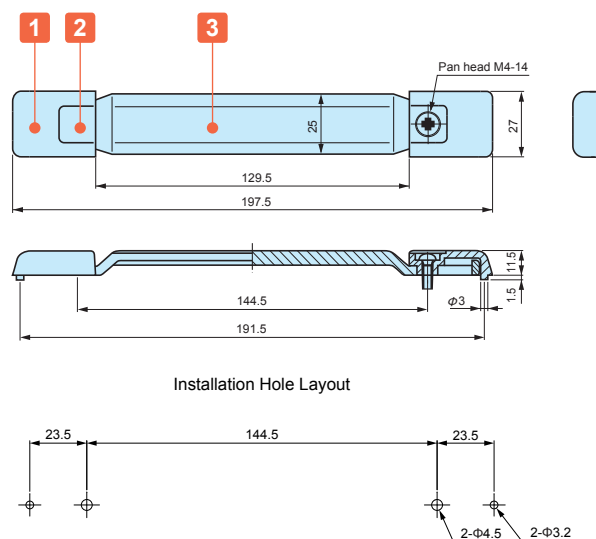

Components

No.	Part name	Pcs	Material	Color / Finish
1	Holder	2	PC + ABS • ABS	Gray • Black
2	Blind cap	2	PP + Elastomer • Elastomer	Gray • Black
3	Grip	1	PP + Elastomer • Elastomer	Gray • Black
-	Screw (Pan head M4-14)	2	Steel	Trivalent chromate
-	Nut (M4)	2	Steel	Trivalent chromate
-	Spring washer	2	Steel	Trivalent chromate

Product no. / Details

Product no.	
● Black	● Gray
MH-197B	MH-197G

HK SERIES**ELASTOMER CARRYING HANDLE**

■ DXF/DWG/PDF drawings available on our website.



■ Elastomer handle that is comfortable to grip.

Technical Data

Max load : 20kg

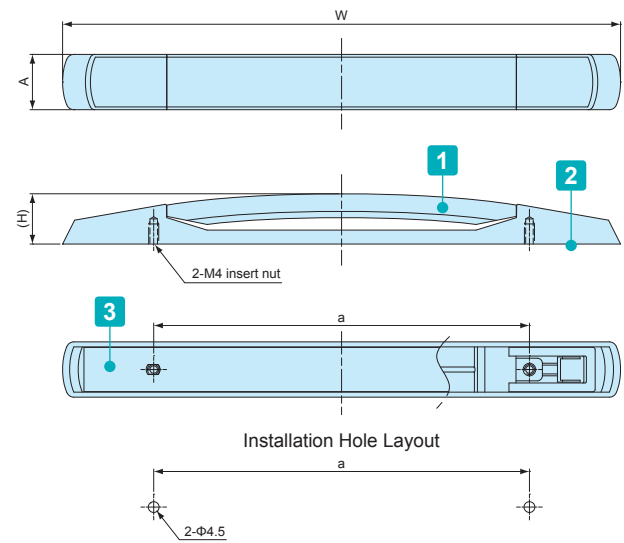
**Components**

No.	Part name	Pcs	Material	Color / Finish
1	Grip	1	Elastomer	Black
2	Base	1	Polyamide	Black
3	Reinforcement	1	Stainless steel	Unfinished
—	Screw (Pan head M4-10 with washer)	2	Steel	Trivalent chromate

Product no. / Dimensions

Product no.	W	A	H	a
HK-1	222.5	22	20	149.5
HK-3	183	22	17	110.7

OH SERIES

ALUMINIUM HANDLE

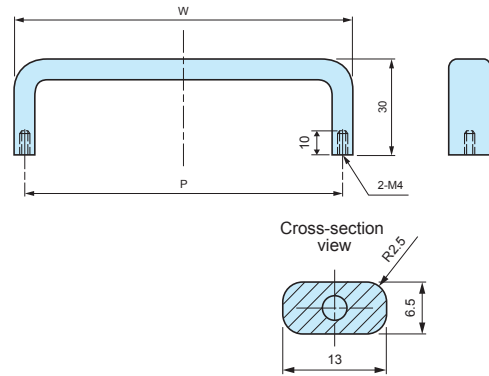
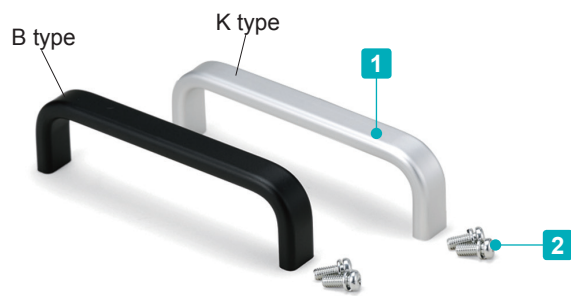

Components

No.	Part name	Pcs	Material	Color / Finish
1	Handle	1	Extruded aluminium A6063S-T5	Matte anodized
2	Screw (M4-10 Pan head with spring washer)	2	Steel	Trivalent chromate

Product no. / Dimensions

Product no.		P	W	Pack of
● Black matte anodized	● Silver matte anodized			
OH- 55B	OH- 55K	55	61.5	2
OH- 70B	OH- 70K	70	76.5	2
OH- 85B	OH- 85K	85	91.5	2
OH-100B	OH-100K	100	106.5	2
OH-120B	OH-120K	120	126.5	2
OH-140B	OH-140K	140	146.5	2
OH-170B	OH-170K	170	176.5	2

KH SERIES

ANGLED ALUMINIUM HANDLE

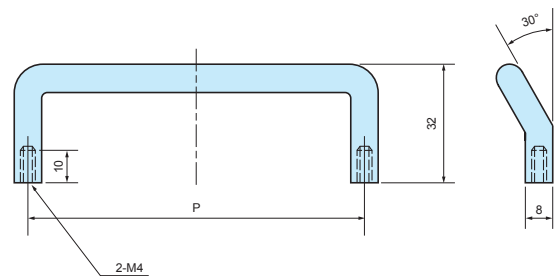
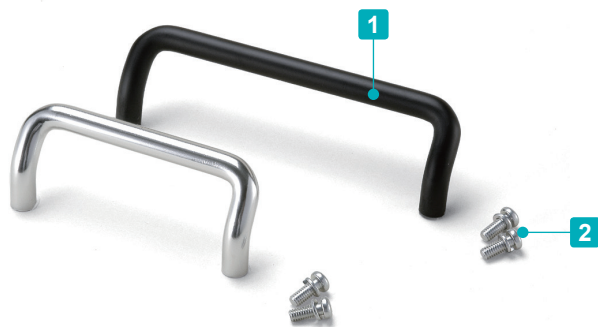

Components

No.	Part name	Pcs	Material	Color / Finish
1	Handle	1	Extruded aluminium A5056S	Polished • Matte anodized
2	Screw (M4-10 Pan head with spring washer)	2	Steel	Trivalent chromate

Product no. / Dimensions

Product no.		P	Pack of
● Silver polished	● Black matte anodized		
KH- 70S	KH- 70B	70	2
KH-100S	KH-100B	100	2

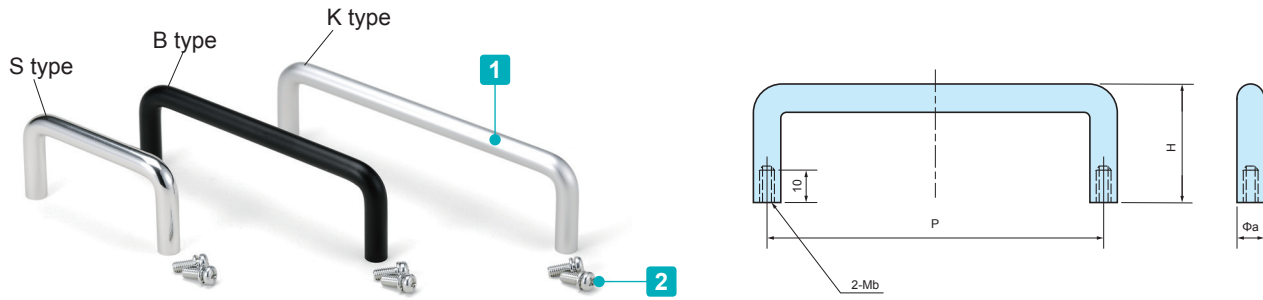
BH SERIES**ROUNDED ALUMINIUM HANDLE****Components**

No.	Part name	Pcs	Material	Color / Finish
1	Handle	1	Extruded aluminium A5056S	Polished • Matte anodized
2	Screw	2	Steel	Trivalent chromate

Product no. / Dimensions

■ K type only available on BH-100, 120, 150, and 180 models.

Product no.			P	H	a	b	Pack of
● Silver polished	● Black matte anodized	● Silver matte anodized					
BH- 26S	BH- 26B	–	26	25	6	3	2
BH- 30S	BH- 30B	–	30	35	8	4	2
BH- 50S	BH- 50B	–	50	35	8	4	2
BH- 60S	BH- 60B	–	60	35	8	4	2
BH- 70S	BH- 70B	–	70	35	8	4	2
BH- 80S	BH- 80B	–	80	35	8	4	2
BH-100S	BH-100B	BH-100K	100	35	8	4	2
BH-110S	BH-110B	–	110	35	8	4	2
BH-120S	BH-120B	BH-120K	120	35	8	4	2
BH-150S	BH-150B	BH-150K	150	35	8	4	2
BH-180S	BH-180B	BH-180K	180	35	8	4	2

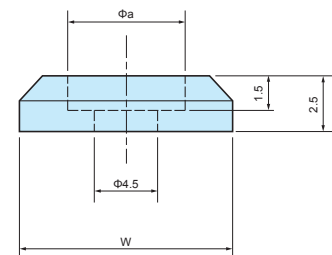
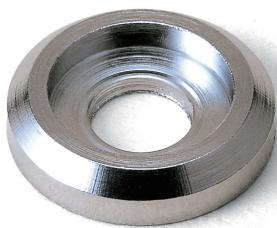
Z-P SERIES**WASHER for HANDLE**

■ Brass washer for BH • KH series.

Product no. / Dimensions

■ Material / Brass

Product no.		W	a	Pack of
Chrome plated	Black painted			
Z-P6S	Z-P6B	10	6.2	10
Z-P8S	Z-P8B	12	8.2	10

STPS series

STRAP

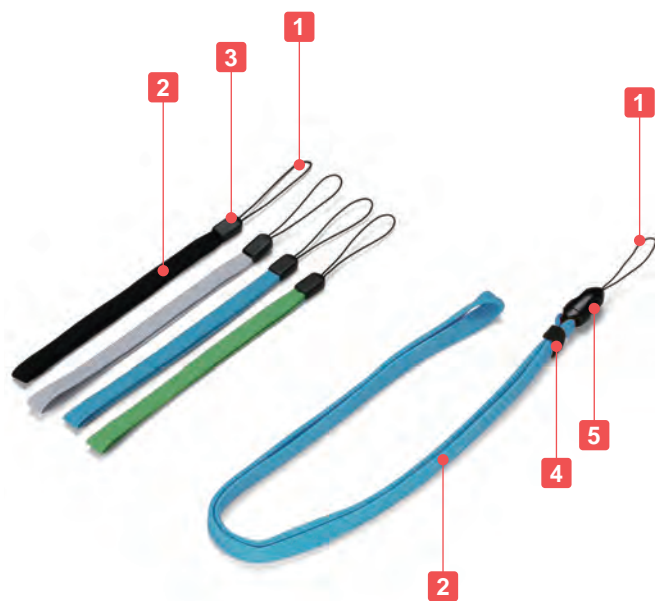

APPLICATION EXAMPLE

Wrist strap (STPS-140G)



Neck strap (STPS-450C)



- Colorful and sturdy straps best used with CSS, CS, PS, and WC series.
- Wrist and Neck straps are available in 4 unique colors.
- Neck strap comes with a quick-release joint, making removal and attachment quick and easy.

Color Type

Code	G Green	C Cyan	L Light gray	B Black
Color				

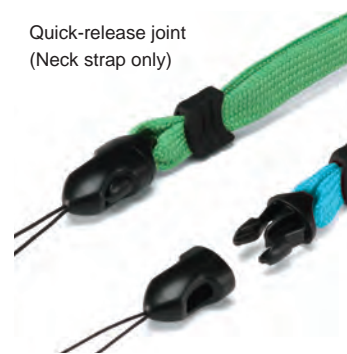
Quick-release joint
(Neck strap only)

Components

No.	Part name	Material	Color
1	String	Polyester	Black
2	Strap	Polyester	Green • Cyan • Light gray • Black
3	Cap (wrist strap only)	ABS	Black
4	Clamp (neck strap only)	Elastomer	Black
5	Joint (neck strap only)	Polyacetal	Black

Product no. / Details

Product no.				Strap width	Strap length
● Green	● Cyan	● Light gray	● Black		
STPS-140G	STPS-140C	STPS-140L	STPS-140B	8	140
STPS-450G	STPS-450C	STPS-450L	STPS-450B	10	450

STP series

STRAP

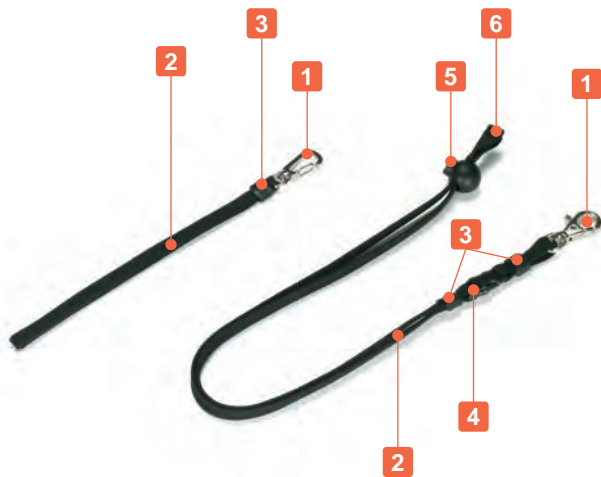

- Strap with a metal hook
- Recommended to be used with CR key ring.

Wrist strap (STP-200)



Neck strap (STP-450)



Neck strap detail



- Only the neck strap has a joint and an adjuster.

Components

No.	Part name	Pcs	Material	Color / Finish
1	Metal hook	1	Diecast zinc & steel	Nickel plated
2	Strap	1	Nylon / Polyester	Black
3	Cap	1 / 2	Polyurethane / Elastomer	Black
4	Joint (Neck strap only)	1	Polyacetal	Black
5	Adjuster (Neck strap only)	1	Nylon	Black
6	Clamp (Neck strap only)	1	PE	Black

Product no. / Details

Product no.	Strap width	Strap length	Strap material	Cap material
STP-200	8	200	Nylon	Polyurethane x 1
STP-450	10	450	Polyester	Elastomer x 2

CR-20

KEY RING



- Hole milling is required for case installation.

CR-20 dimensions

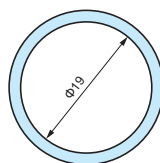

- DXF/DWG/PDF drawings available on our website.

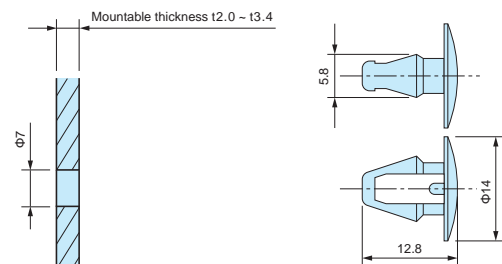

Components

Part name	Material	Color / Finish
Ring	SWRM 6 Steel	Nickel plated
Insert clip	Nylon	Black

Product no. / Details

Product no.	Ring Φ	Installation hole	Mounting thickness
CR-20	Φ19	Φ7	t2.0 ~ t3.4

GDH series

PLASTIC BELT CLIP



Installation example

GDH dimensions

■ DXF/DWG/PDF drawings available on our website.

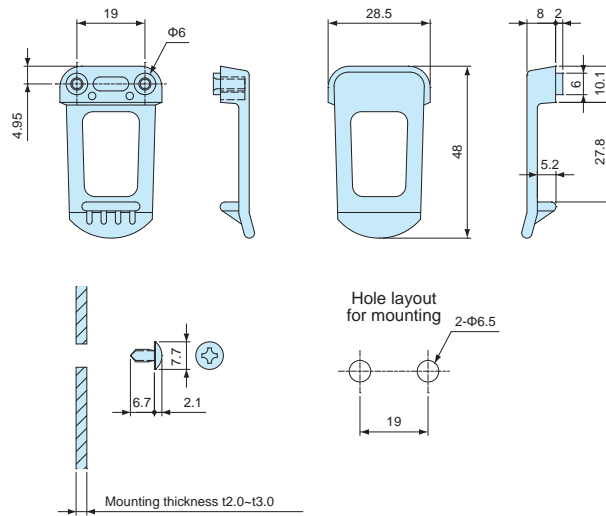

Components

No.	Part name	Pcs	Material	Color / Finish
1	Clip	1	ABS UL94HB	White • Black
2	Screw	2	Steel M3.5-6	Zinc plated

Product no. / Details

Product no.		W	H	D
● White	● Black			
GDH-1W	GDH-1B	28.5	10	48

DK series

STEEL BELT CLIP

DK dimensions

■ DXF/DWG/PDF drawings available on our website.



DK-1

DK-2

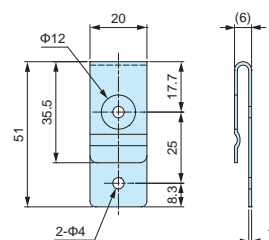

Hole layout for mounting

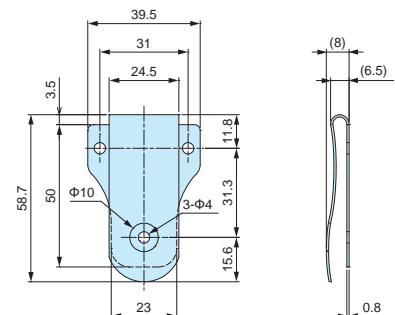
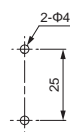

Hole layout for mounting

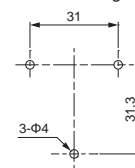

Product no. / Details

Product no.	Material	Finish
DK-1	Steel SPCC t=1.0	Chrome plated
DK-2	Steel SPCC t=0.8	Chrome plated