

GDH series

## PLASTIC BELT CLIP



Installation example

## GDH dimensions

■ DXF/DWG/PDF drawings available on our website.

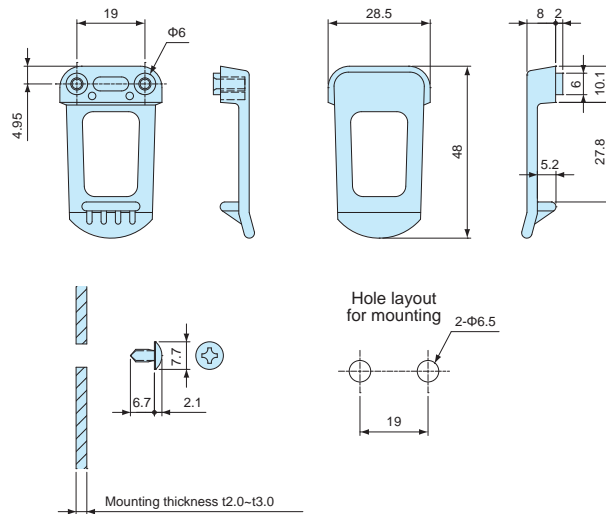

## Components

No.	Part name	Pcs	Material	Color / Finish
1	Clip	1	ABS UL94HB	White • Black
2	Screw	2	Steel M3.5-6	Zinc plated

## Product no. / Details

Product no.		W	H	D
● White	● Black			
GDH-1W	GDH-1B	28.5	10	48

DK series

## STEEL BELT CLIP

## DK dimensions

■ DXF/DWG/PDF drawings available on our website.



DK-1

DK-2

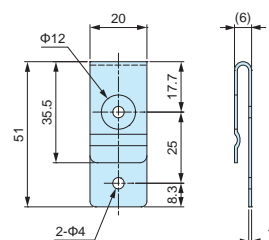
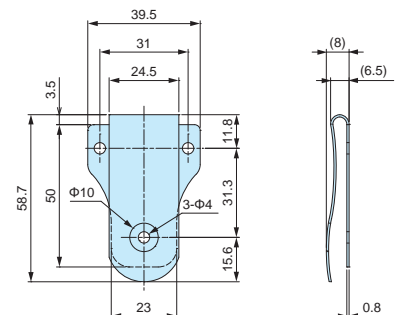
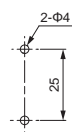
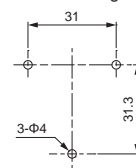
Hole layout  
for mountingHole layout  
for mounting

## Product no. / Details

Product no.	Material	Finish
DK-1	Steel SPCC t=1.0	Chrome plated
DK-2	Steel SPCC t=0.8	Chrome plated

WM series

## SUSPENSION BRACKET

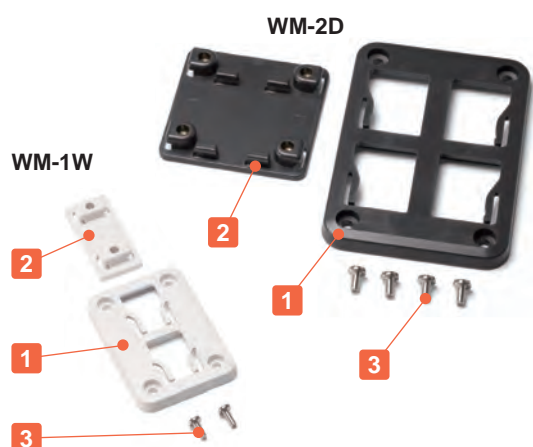

Installation example



How to install

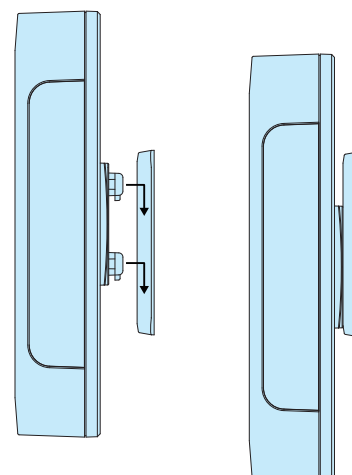

- Plastic wall mounting bracket. Easy attachment and removal.
- Large and small bracket types are available.
- Applicable to be used on plastic or metallic enclosures with a panel thickness of 0.8 ~ 3.5mm.
- To attach the suspension hook onto the enclosure, hole milling is required.
- Please be aware of the insertion direction of the suspension hook against the mounting base when attaching.
- DXF/DWG/PDF/STP drawings available on our website.

## Technical Data

Max load : WM-1 - 2kg  
WM-2 - 5kg

\* The max load values listed are static load values only. Use caution when handling.

## Components

No.	Name	Pcs	Material	Color / Finish
1	Mounting base	1	PC + ABS UL94HB	Off-white • Dark gray
2	Suspension hook	1	PC + ABS UL94HB	Off-white • Dark gray
3	Screw	2 (WM-1) 4 (WM-2)	Steel	Nickel plated

Included Screw

WM-1□ : Bind M3-8  
WM-2□ : Bind M4-88

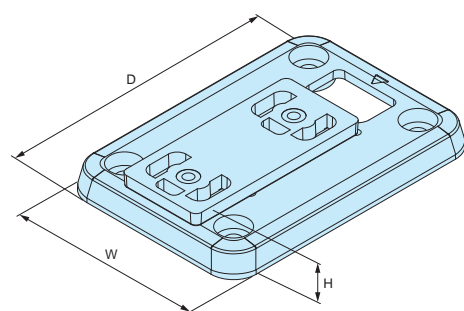

## Product no. / Details

Product no.		W	H	D	Mountable thickness	Weight (g)
● Off-white	● Dark gray					
WM-1W	WM-1D	45	9	65	t0.8~t3.5	11.5
WM-2W	WM-2D	80	11	115	t0.8~t3.5	48

PMB-1

## POLE MOUNTING BRACKET



Installation example



- DXF/DWG/PDF drawings available on our website.

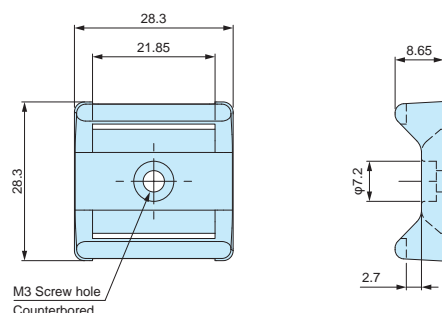

- Small size pole mounting bracket suitable for indoor use.
- Installation screws (M3 size) are separately sold. See page HES • HOS • MT for compatible MT3-4 screws.
- Minimum applicable pole diameter is  $\Phi 35$ .
- Use SNB • PKB • SCT mounting belt to install onto a pole.

## Product no. / Details

Material / Color : PA66+GF (UL94HB) / Black

Product no.	Maximum load (kg)	Weight (g)	Pack of
PMB-1	1	3 (1 piece)	2

DST series

## DOUBLE-SIDED MOUNTING TAPE



- Super strong double-sided mounting tape with excellent cold and heat resistance.
- Allow cases to be attached onto any place.
- Easily attached onto walls where holes cannot be drilled.
- Can be used with a range of products, such as small IoT type enclosures.

- Please ensure that surface is cleaned and grease-free before adhering.
- Once removed, it cannot be adhered on again.

**Notes:**

Due to the strong adhesive strength,  
do ensure that the surface or product is suitable to be adhered onto.

**Technical Data**

Operating temperature:  
-30°C ~ +200°C

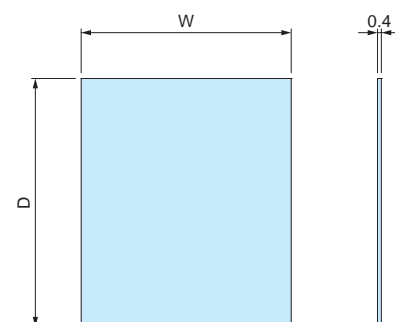
**Adhesion Performance (90° peel adhesion)**

90° direction peel force N/cm	Stainless steel (SUS304BA)	24
	Aluminium (A1050P)	21
	Bonded steel plate (SECC)	30
	ABS	10
	Acrylic (PMMA)	16
	Polypropylene	6
	Polyethylene (HDPE)	3
	Glass	27

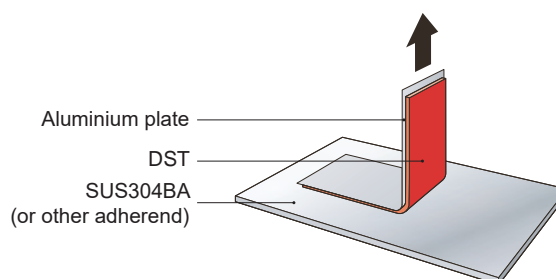
**[Test Method]**

Backed with specially treated Aluminium foil (130 $\mu$ m), crimped with a 10kg steel roller back and forth twice, cured at room temperature for 72 hours, tensile speed 300mm/min.

\*Data values listed are test results based on the test conditions, and are to be used as reference only.

\*Adhesive strength and other physical properties vary depending on the adherend, bonding and curing conditions, and other factors.

**Product no. / Details**

■ Material / Color: Acrylic foam base, acrylic adhesive / gray

Product no.	W	D	Suitable models	Weight (g)	Pack of
NEW DST14-22	14	22	SIC2-4-1 SW-30	0.3 / pc	5
NEW DST14-36	14	36	SIC2-5-1	0.4 / pc	5
DST18-40	18	40	SIC3-5-2 SW-(T)40 • 60	0.7 / pc	5
DST22-26	22	26	SIC3-4-2 SW-(T)40	0.5 / pc	5
DST24-48	24	48	SIC3-6-2 SW-50 • 53 • (N)(T)55 • (N)65 TW/TWN4-2-5 • 4-2-6 • 4-2-8	0.8 / pc	5

## NMG series

## NEODYMIUM MAGNET

## Round magnet

■ DXF/DWG/PDF drawings available on our website.



- Material / Finish: Neodymium / Nickel plated
- Please attach using a strong adhesive.

## Product no. / Details

Product no.	a	b	Weight (g)	Flux Density	Absorption
NMG3-15N	15	3	4	214.4 mT	2.44 kgf
NMG3-20N	20	3	7.1	170.7 mT	3.26 kgf
NMG5-22N	22	5	11.4	247.2 mT	5.91 kgf
NMG5-25N	25	5	18.4	221.9 mT	6.89 kgf

## NMG dimensions

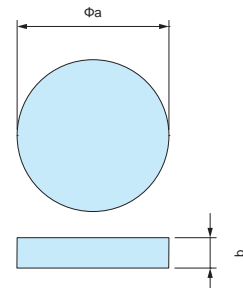

## Round magnet with countersunk hole



- Please fasten with a screw.

## Product no. / Details

Product no.	a	b	c	Countersunk size	Weight (g)	Flux Density	Absorption
NMG3-15M3	15	3.2	3	M3	3.8	214.3 mT	2.33 kgf
NMG3-20M3	20	3.2	3	M3	6.9	170.6 mT	3.17 kgf
NMG5-22M4	22	4.3	5	M4	13.7	247.2 mT	5.68 kgf
NMG5-25M5	25	5.3	5	M5	17.6	221.9 mT	6.58 kgf

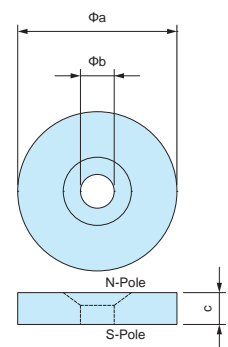

## Rectangular magnet with countersunk holes



- Please fasten with a screw.

## Product no. / Details

Product no.	a	b	c	Countersunk size	Weight (g)	Flux Density	Absorption
NMG3-50M3	50	10	3	M3	11.3	210.0 mT	9.1 kgf

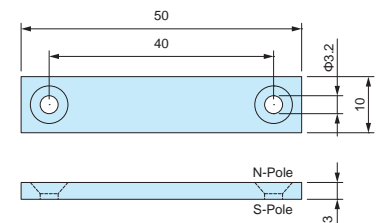

## Example 1 The magnetic force remains strong even through plastic.

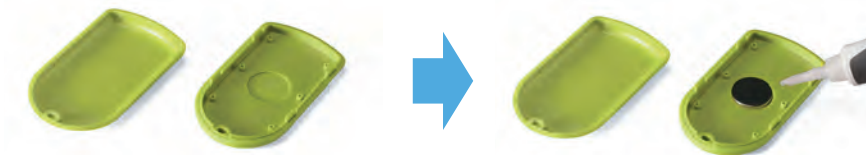

Make recessed pocket on the inside wall.

Glue on.



Attach onto a metallic surface.

## Example 2

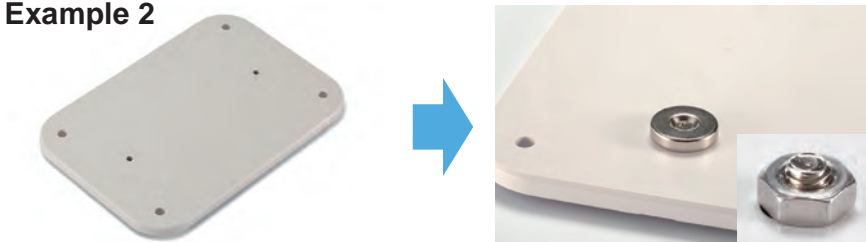

Make holes

Fasten with a screw and nut.



Attach onto a metallic surface.

CAUTION: Handle with care to avoid personal injury or damage to the magnet.



## ULCK series

## SCREWLESS PCB ADHESIVE STANDOFF

Application example

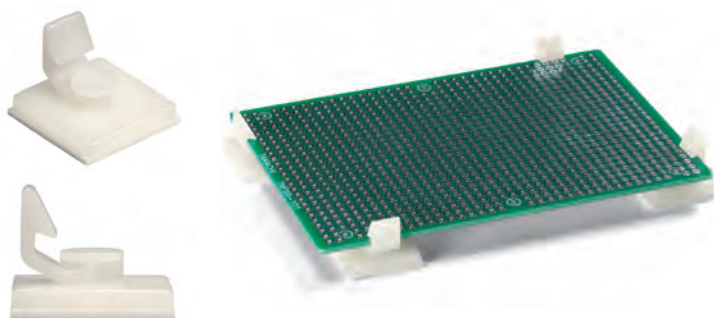

ULCK dimensions

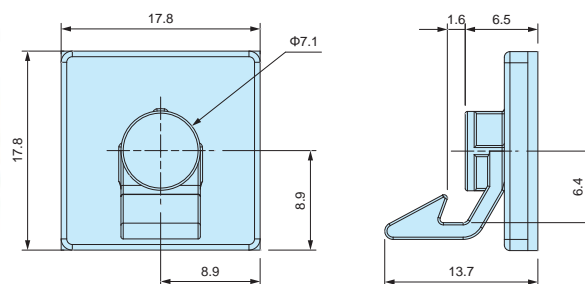

■ DXF/DWG/PDF drawings available on our website.

- Securing of a 1.6mm thick PCB made easy by simply snapping it in.
- Adhesive standoff can be freely and easily affixed on.
- Once removed, it cannot be adhered on again.

## Product no. / Details

■ Material / Color : PA66 UL94V-2 / Natural

Product no.	Weight (g)	Pack of
ULCK-6.4	1.3 (1 pc)	4

## CUBE series

## CUBE STANDOFF

■ DXF/DWG/PDF/STP drawings available on our website.

CUBE10-M3

CUBE10-M4

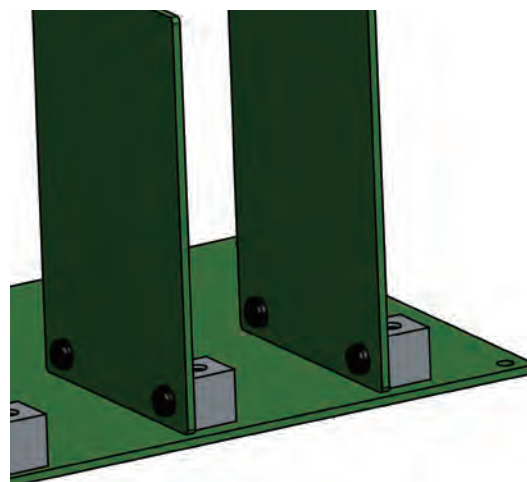
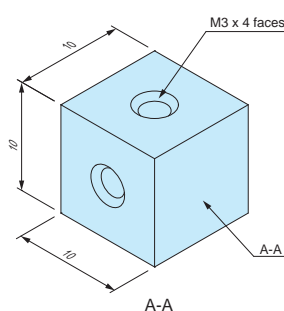

- 10mm threaded cube shape standoff with a thread on 4 faces.
- M3 and M4 thread models available.
- Conveniently usable when installing PCB or metal plate upright.
- CUBE can also be used to make a simple housing by vertically aligning the plates.

## Product no. / Details

■ Zinc diecast : Glossy barrel finish

Product no.	Pack of
CUBE10-M3	2
CUBE10-M4	2
CUBE10-M3-P	20
CUBE10-M4-P	20

## BFL series

## PLASTIC MOUNTING BRACKET



Color G

Color S

- 2 different colored types to match box colors.
- Tough and strong glass fiber filled polycarbonate.

## BFL dimensions

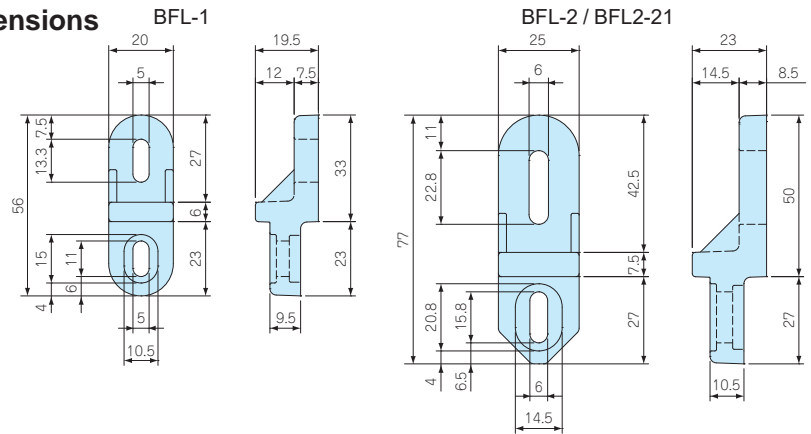

## Color Type

Code	Color	Suitable models
G	White gray	BCAP • BCAR
S	Light gray	BCPC • BCPK • BCPR

## Components

■ DXF/DWG/PDF drawings available on our website.

Part name	Pcs	Material / Finish
Mounting bracket	4	Glass fiber filled polycarbonate • ABS
Screw	4	Stainless steel / Unfinished

## Product no. / Details

Product no.	Suitable models	Screw
BFL-1□	BCAP • R, BCPC • K • R 0912, 1015, 1121, 1126, 1315, 1318, 1621, 1626, 1722, 1727, 212113	Self-tapping M4-12 bind head
BFL-2□	BCAP • R, BCPC • K • R 1928, 2030, 2535, 2828, 2838, 3030, 3040, 3535, 3545, 4050, 4060, 5060	M5-12 bind head
BFL-2-21□	BCAP • R, BCPC • K • R 212110	Self-tapping M4-12 bind head

■ Please suffix color code at the end of the product number.

\*Not suitable for BCAP1515 models. Use CK-35P (Stainless steel) instead.

## CK series

## STAINLESS STEEL MOUNTING BRACKET



## CK dimensions

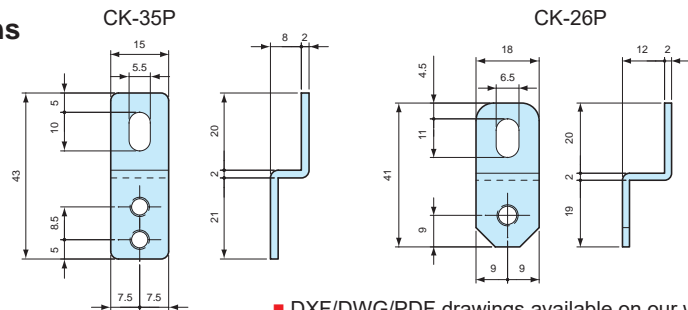

## Components

■ DXF/DWG/PDF drawings available on our website.

Part name	Pcs	Material	Finish
Mounting bracket	4	Stainless steel SUS304	Barrel finish
Screw	4	Stainless steel	Unfinished

## Product no. / Details

Product no.	Suitable models	Screw
CK-35P	BCAP • R, BCPC • K • R 0912, 1015, 1121, 1126, 1315, 1318, 1515, 1621, 1626, 1722, 1727, 2121	Self-tapping M4-10 pan head
CK-26P	BCAP • R, BCPC • K • R 1928, 2030, 2535, 2828, 2838, 3030, 3040, 3535, 3545, 4050, 4060	M5-10 pan head

## MT series

## PCB MOUNTING SCREW

- PCB mounting screws for inner bosses of BCAP • BCAR • BCPC • BCPK • BCPR series.



## Product no. / Details

Product no.	Screw details	Material	Finish	Pack of
MT4-8T	Self-tapping M4-8 bind head	Steel	Trivalent chromate	20
MT5-8T	Self-tapping M5-8 bind head	Steel	Trivalent chromate	20

## Product no. / Details

Product no.	Suitable models	Recommended torque
MT4-8T	BCAP • R, BCPC • K • R 0912, 1015, 1121, 1126, 1315, 1318, 1515, 1621, 1626, 1722, 1727, 1928, 2121	0.7N • m
MT5-8T	BCAP • R, BCPC • K • R 2030, 2535, 2828, 2838, 3030, 3040, 3535, 3545, 4050, 4060, 5060, 5070, 6080	1.4N • m

# WGMB-1W POLE MOUNTING BRACKET for WG • WGPC • WGV



■ DXF/DWG/PDF/STP drawings available on our website.

## WGMB dimensions

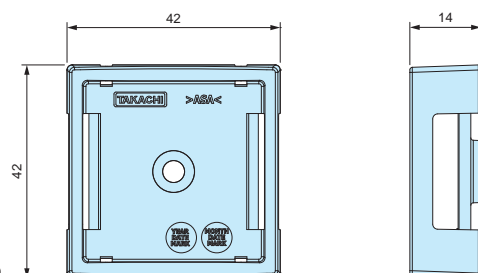

- Pole mount bracket made from weather resistant ASA material.
- Hole milling is not required when installing the mount bracket, thus allowing the enclosure to maintain its IP rating.
- WG • WGPC • WGV10-15-□ and 15-16-□ can be installed in both the W or D direction.
- Pole mount is possible with the use of SNB or PKB series mounting belt. (See website)

\* Operating temperature : -30°C ~ +60°C

## Product no. / Details

■ Mounting stainless steel screw included.

Product no.	Suitable models	Material / Color	Weight (g)	Pack of
WGMB-1W	WG • WGPC • WGV10-15-□ / 1 pc required WG • WGPC • WGV15-16-□ / 1 pc required WG • WGPC • WGV15-21-□ / 2 pcs required	ASA UL94HB / Off-white	9	1

## Installation example

Installation (1 pc)

Installation (2 pcs)



# WPMB-M4-2G POLE MOUNTING BRACKET

■ DXF/DWG/PDF/STP drawings available on our website.

## WPMB-M4-2 dimensions

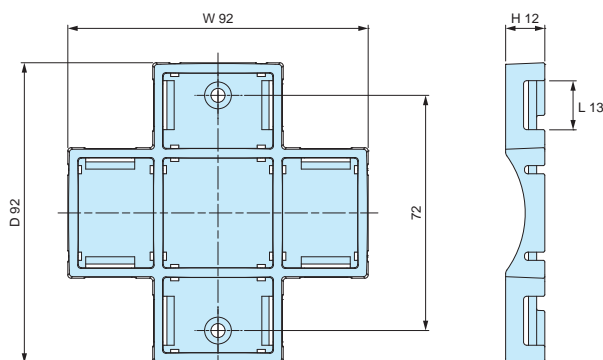

- Pole mount bracket made from weather resistant ASA material.
- Pole mounting belt can be installed in either W or D direction.
- Pole mount is possible with the use of PKB series mounting belt. (See page 208)
- Hole milling is not required when installing the mount bracket, thus allowing the enclosure to maintain its protection class.

\*Stainless steel screw belt SNB series is not usable on WPMB-M4-2 series.

\* Operating temperature : -30°C ~ +60°C

## Color

White gray

## Product no. / Details

■ Mounting stainless steel screw included.

Product no.	Suitable models	Recommended torque (N • m)	Weight (g)	Pack of
WPMB-M4-2G	WG • WGPC • WGV15-21-□	0.45 ~ 0.5	24	1

■ Recommended torque listed is for reference only; actual may differ. Assemble after testing torque.

## WGMB-2N

## DIECAST ALUMINIUM POLE MOUNTING BRACKET for WG • WGPC • WGV

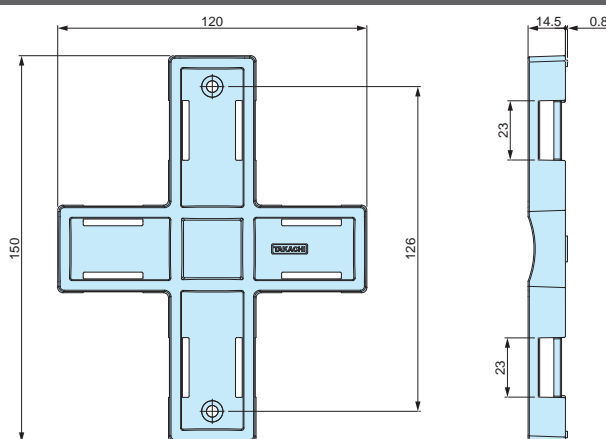

■ DXF/DWG/PDF/STP drawings available on our website.

- Pole mount bracket made from robust diecast aluminium.
- Hole milling is not required when installing the mount bracket, thus allowing the enclosure to maintain its protection class.
- Can be used for WG • WGPC • WGV17-25-□ and 23-25-□ models.
- Pole mounting belt can be installed in either W or D direction.
- Pole mount is possible with the use of SNB or PKB series mounting belt. (See page 207 ~ 208)

## Product no. / Details

■ Stainless steel mounting screws included.

Product no.	Suitable models	Material / Finish	Weight (g)	Pack of
WGMB-2N	WG • WGPC • WGV17-25-□ WG • WGPC • WGV23-25-□	Diecast aluminium ADC12 / Shot blast	126	1

## Installation example

WGMB-2N



Vertical mounting



Horizontal mounting



SSK series (Pole mounting bracket for WG • WGPC • WGV25-33-9 ~ 28-40-15)

SSK series

Vertical mounting



Suitable model

Product no.		Pole mounting bracket product no.		Screw type
		For vertical	For horizontal	
WG WGPC WGV	25-33- 9 25-33-12	SSK-250	SSK-300	Use included screw
	30-33- 9 30-33-13	SSK-300	SSK-300	
	28-40-10 28-40-15	SSK-280	SSK-400	

\* See page 205 for details.



## WPMB series

## POLE MOUNTING BRACKET for WP

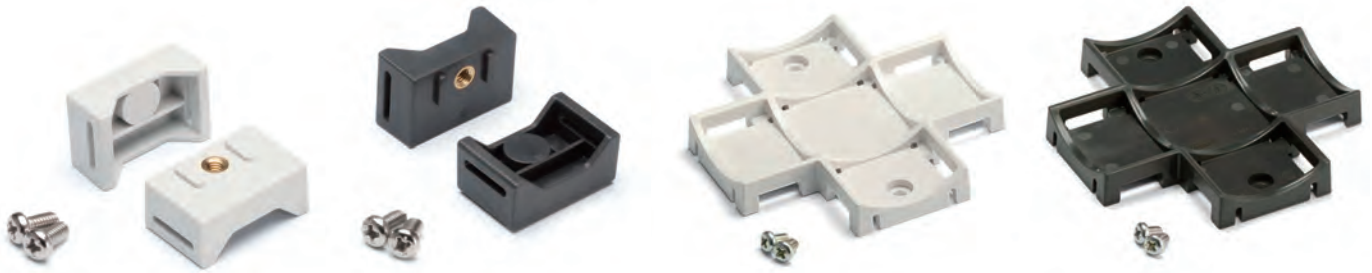

- Pole mount bracket made from weather resistant ASA material.
- Hole milling is not required when installing the mount bracket, thus allowing the enclosure to maintain its IP67 protection.
- WPMB-M4-2 can be used for both vertical and horizontal installation.
- Together with WPMB series, the PKB series mounting belt allows the unit to be mounted onto a pole.

## WPMB dimensions

■ DXF/DWG/PDF/STP drawings available on our website.

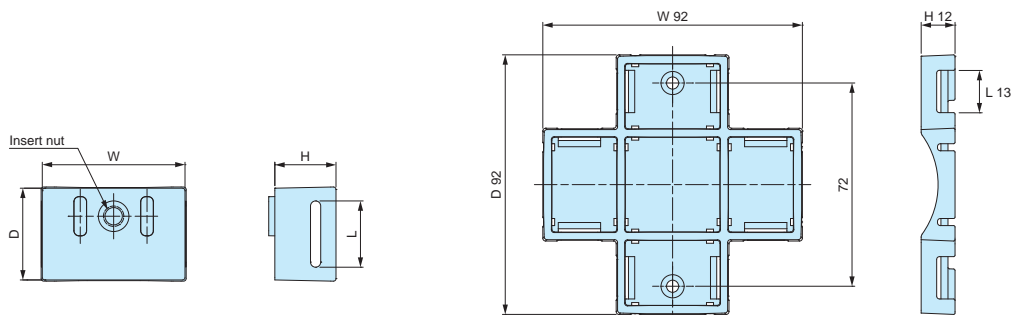

WPMB-M3 • WPMB-M4

WPMB-M4-2

## Color Type

Code	Color
G	White gray
D	Dark gray

## Product no. / Details

■ Please suffix color code at the end of the product number.

Product no.	Dimensions				Screw	Suitable models	Recommended torque (N • m)	Weight (g)	Pack of
	W	D	H	L					
WPMB-M3□	18	14	9.5	11	Stainless steel M3-6 x 2 pcs	WP5-7-2 • 5-7-3 • 6-8-2 • 6-8-3 • 8-8-2 • 8-8-4 • 8-10-2 • 8-10-4	0.4 ~ 0.45	3	2
WPMB-M4□	28	18	12	13	Stainless steel M4-8 x 2 pcs	WP9-13-3 • 9-13-4 • 10-10-3 • 10-10-4 • 11-15-3 • 11-15-4 • 13-18-3 • 13-18-5	0.45 ~ 0.5	10	2
WPMB-M4-2□	92	92	12	13	Stainless steel M4-6 x 2 pcs	WP15-15-4 • 15-15-6 • 15-21-4 • 15-21-6 • 20-20-5 • 20-20-7 • 20-28-5 • 20-28-7	0.45 ~ 0.5	24	1

■ Recommended torque listed is for reference only; actual may differ. Assemble after testing torque.

WPMB-M3 / WPMB-M4

WPMB-M4-2

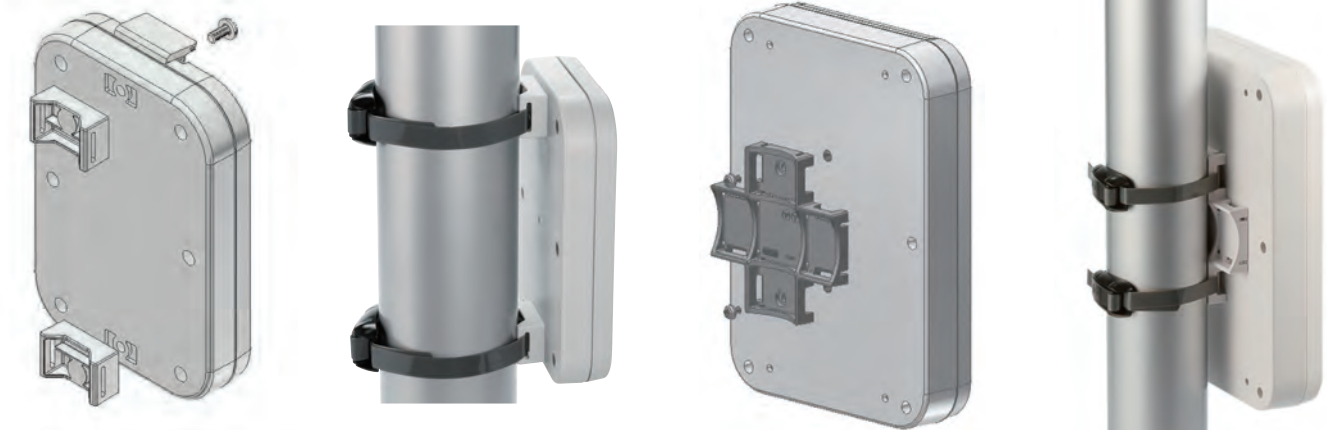

## WGMB-2N

## DIECAST ALUMINIUM POLE MOUNTING BRACKET for DW • DWH

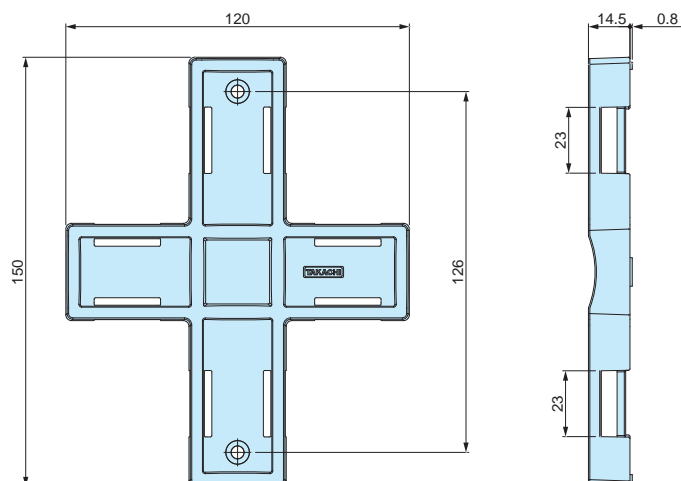
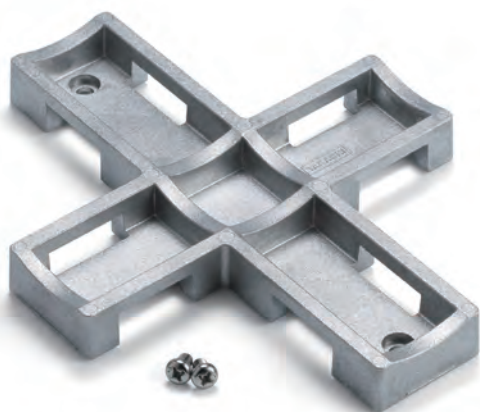

- Pole mount bracket made from robust diecast aluminium.
- DXF/DWG/PDF/STP drawings available on our website.
- Hole milling is not required when installing the mount bracket, thus allowing the enclosure to maintain its protection class.
- Can be used for DW • DWH14-22-□ models.
- Pole mounting belt can be installed in either W or D direction.
- Pole mount is possible with the use of SNB or PKB series mounting belt. See page 207 ~ 208 for more details.

## Product no. / Details

■ Stainless steel mounting screws included.

Product no.	Suitable models	Material / Finish	Weight (g)	Pack of
WGMB-2N	DW • DWH14-22-□	Diecast aluminium ADC12 / Shot blast	126	1

## DWMB-1N

## WALL MOUNTING BRACKET for DW • DWH

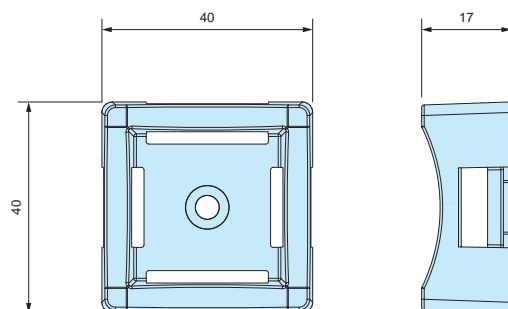

■ Material / Finish : Diecast aluminium ADC12 / Shot blast

- Pole mount bracket made from robust diecast aluminium.
- Hole milling is not required when installing the mount bracket, thus allowing the enclosure to maintain its protection class.
- Can be used for DW • DWH10-15-□ models.
- Pole mounting belt can be installed in either W or D direction.
- Pole mount is possible with the use of SNB or PKB series mounting belt. See page 207 ~ 208 for more details.

■ DXF/DWG/PDF/STP drawings available on our website.

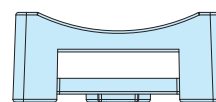

## Product no. / Details

Including 1x screw (Pan head M4-6 Stainless Steel Unfinished)

Product no.	Suitable models	Weight (g)	Pack of
DWMB-1N	DW • DWH10-15-□	24	1

# SSK series

## POLE MOUNTING BRACKET for BCAP • BCAR • BCPC • BCPK • BCPR

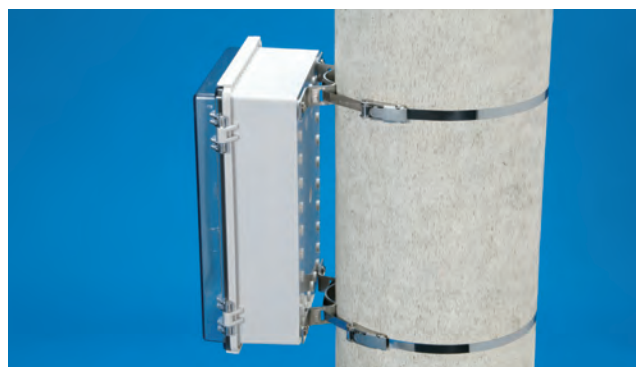
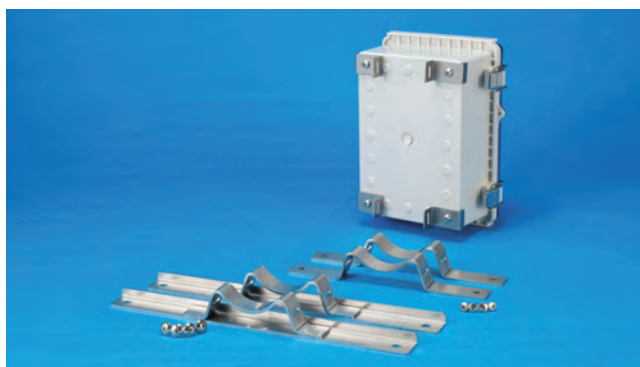

- Stainless steel pole mounting bracket for BCAP • BCAR • BCPC • BCPK • BCPR series.
- No hole milling is required for maintaining the IP rating of the boxes.
- SSK-P models come with plastic brackets.

### APPLICATION EXAMPLE

Weather Station Data Logger

### SSK dimensions

■ DXF/DWG/PDF drawings available on our website.

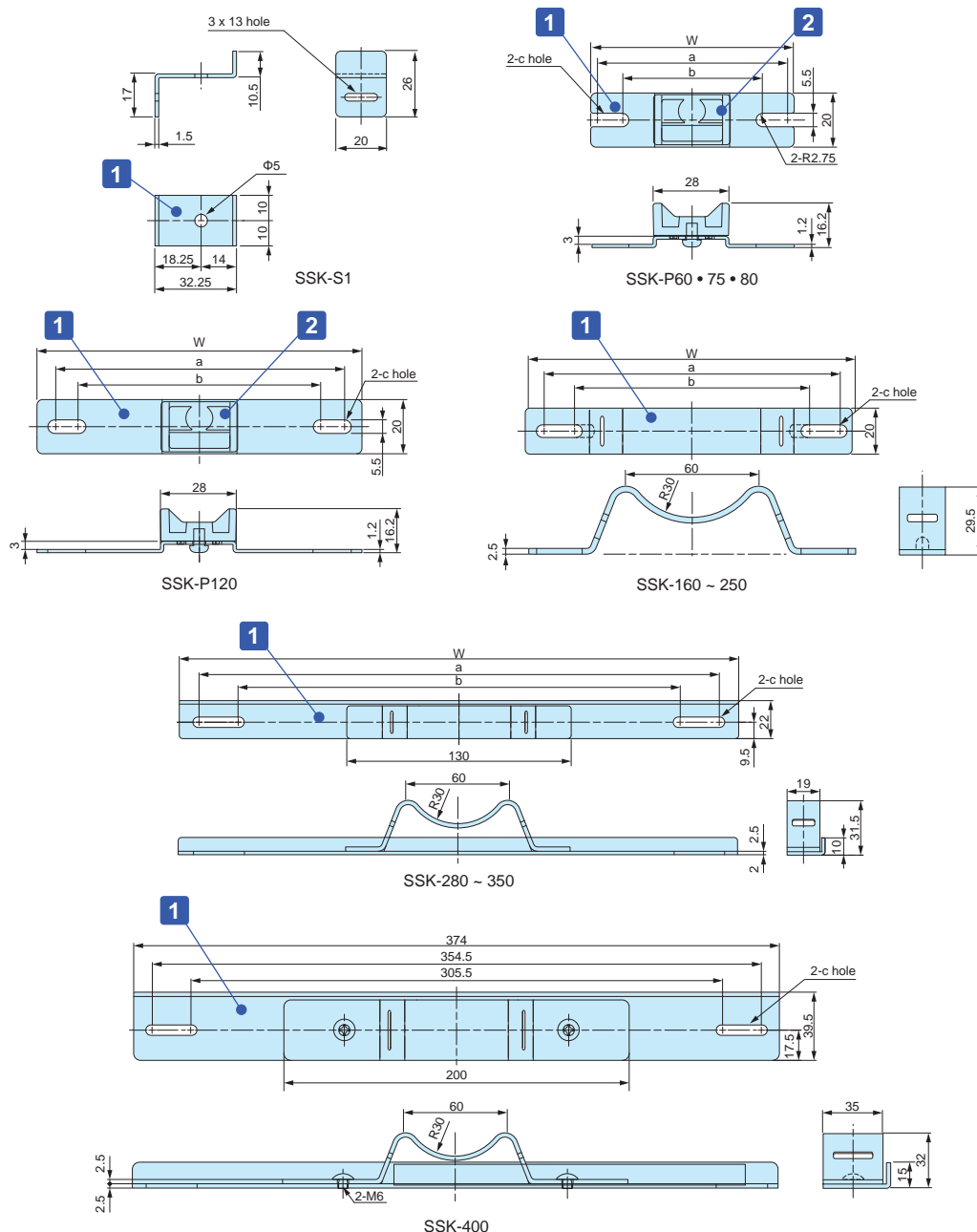

### Water Level Detector



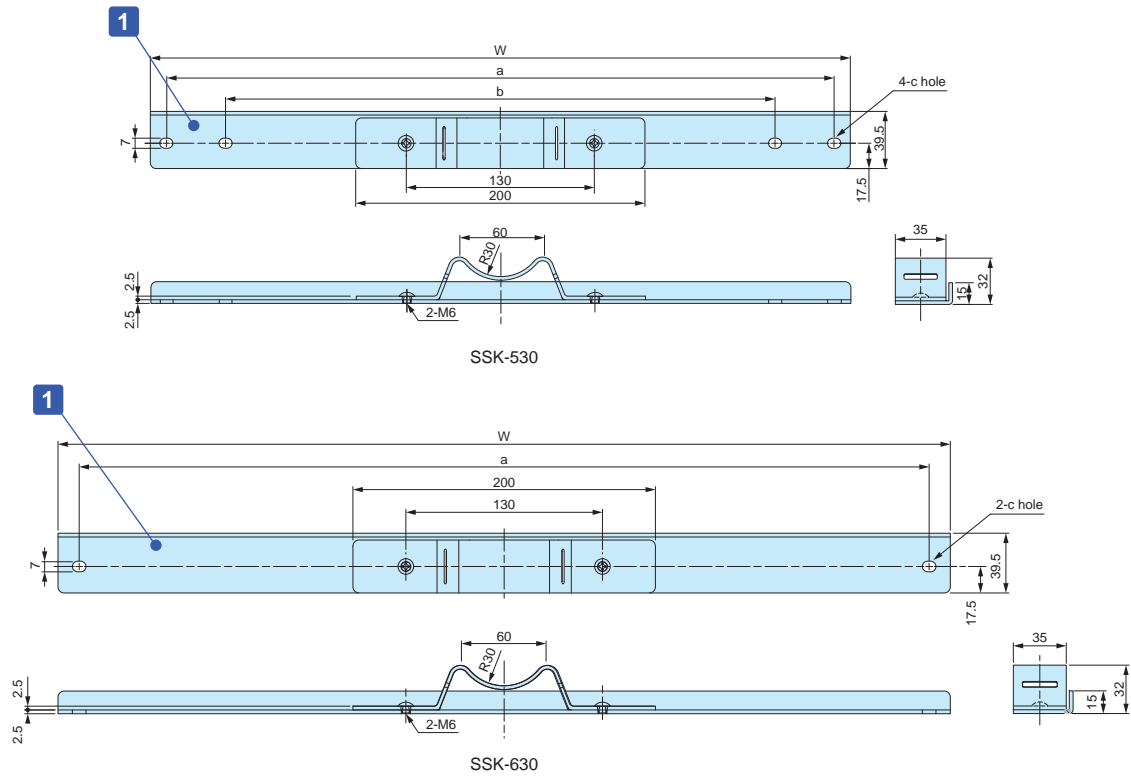

■ DXF/DWG/PDF drawings available on our website.

#### Components

No.	Part name	Pcs	Material	Color / Finish
1	Mounting bracket	2 / 4	Stainless steel SUS304	Barrel finish
2	Plastic bracket (SSK-P only)	2	ASA UL94HB	White gray
-	Screw	4	Stainless steel	Unfinished

#### Product no. / Details

Product no.	W	a	b	c	Suitable models BCAP • BCAR • BCPC • BCPK • BCPR	Belt to use with	Pack of
SSK-S1	—	—	—	—	0912, 1015, 1121, 1126, 1315, 1318, 1621, 1626, 1722, 1727, 2121	PKB10PM, 10P, PKB10S, SNB series	4
SSK-P60	60	54.5	47.5	5.5 x 9	0912	PKB10PM, 10P, PKB10S	2
SSK-P75	75	69.5	55.5	5.5 x 12.5	1015	PKB10PM, 10P, PKB10S	2
SSK-P80	80	74.5	64.5	5.5 x 10.5	1121, 1126	PKB10PM, 10P, PKB10S	2
SSK-P120	120	106.5	88.5	5.5 x 14.5	1315, 1318	PKB10PM, 10P, PKB10S	2
SSK-160	142	129.5	106.5	—	1515, 1621, 1626	PKB10PM, 10P, PKB10S, SNB series	2
SSK-170	152	142.3	101	—	1722, 1727	PKB10PM, 10P, PKB10S, SNB series	2
SSK-200	174	161.5	112.5	5.5 x 30	1928, 2030	PKB10PM, 10P, PKB10S, SNB series	2
SSK-210	192	180.5	131.5	5.5 x 30	2121	PKB10PM, 10P, PKB10S, SNB series	2
SSK-250	230	215.5	166.5	5.5 x 30	2535	PKB10PM, 10P, PKB10S, SNB series	2
SSK-280	260	244.5	195.5	5.5 x 30	2828, 2838	PKB10PM, 10P, PKB10S, SNB series	2
SSK-300	280	264.5	215.5	5.5 x 30	3030, 3040	PKB10PM, 10P, PKB10S, SNB series	2
SSK-350	324	302.5	253.5	5.5 x 30	3535, 3545	PKB10PM, 10P, PKB10S, SNB series	2
SSK-400	374	354.5	305.5	5.5 x 30	4050, 4060	PKB20S, SNB series	2
SSK-530	484	462	380	7 x 9	5060, 5070	PKB20S, SNB series	2
SSK-630	590	562	—	7 x 9	6080	PKB20S, SNB series	2



SNB series



PKB-10PM, 10P



PKB-10S, 20S

■ Pole mounting strap and belt, SNB and PKB series are sold separately. See page 207 ~ 208 for further details.

SNB series

## STAINLESS STEEL POLE MOUNTING STRAP



## SNB dimensions

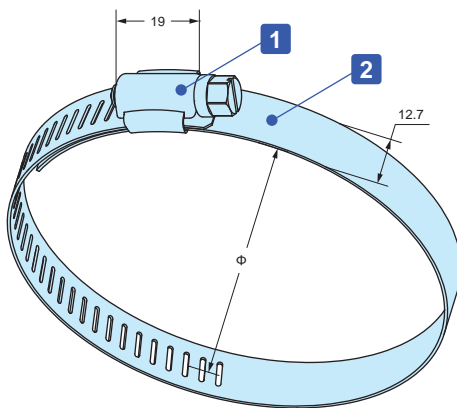

- Corrosion resistant stainless steel (SUS304) belt clamp.
- It can be installed securely by tightening the screw.
- 8 mm nut driver (box driver) is recommended for tightening.  
Flat-bladed screwdrivers can also be used.

## Components

No.	Part name	Pcs	Material	Finish
1	Bracket	1	Stainless steel SUS304	Polished
2	Strap	1	Stainless steel SUS304	Polished

## Product no. / Details

Product no.	Applicable diameter (Φ)	Strap width	Strap thickness	Recommended torque N • m	Weight (g)	Pack of
SNB 52- 76	52 ~ 76	12.7	0.6	0.7 ~ 1.0	27.5	1
SNB 72- 95	72 ~ 95	12.7	0.6	0.7 ~ 1.0	30	1
SNB 91-114	91 ~ 114	12.7	0.6	0.7 ~ 1.0	34.5	1
SNB105-127	105 ~ 127	12.7	0.6	0.7 ~ 1.0	37.5	1
SNB117-140	117 ~ 140	12.7	0.6	0.7 ~ 1.0	39.5	1
SNB130-153	130 ~ 153	12.7	0.6	0.7 ~ 1.0	41.5	1
SNB142-165	142 ~ 165	12.7	0.6	0.7 ~ 1.0	43.5	1
SNB155-178	155 ~ 178	12.7	0.6	0.7 ~ 1.0	46.5	1
SNB168-191	168 ~ 191	12.7	0.6	0.7 ~ 1.0	49	1
SNB181-204	181 ~ 204	12.7	0.6	0.7 ~ 1.0	51	1
SNB194-217	194 ~ 217	12.7	0.6	0.7 ~ 1.0	52.5	1
SNB207-230	207 ~ 230	12.7	0.6	0.7 ~ 1.0	57	1
SNB220-243	220 ~ 243	12.7	0.6	0.7 ~ 1.0	59.5	1
SNB233-256	233 ~ 256	12.7	0.6	0.7 ~ 1.0	62.5	1
SNB246-269	246 ~ 269	12.7	0.6	0.7 ~ 1.0	64	1
SNB259-282	259 ~ 282	12.7	0.6	0.7 ~ 1.0	67.5	1
SNB272-295	272 ~ 295	12.7	0.6	0.7 ~ 1.0	70	1
SNB285-308	285 ~ 308	12.7	0.6	0.7 ~ 1.0	71	1

■ Recommended torque listed is for reference only; actual may differ. Assemble after testing torque.

## SNB Strap required

Suitable series	Suitable models						Required
SSK series	SSK-S1	SSK-160	SSK-170	SSK-200	SSK-210	SSK-250	2
	SSK-280	SSK-300	SSK-350	SSK-400	SSK-530		
WGMB series	WGMB-1W						1



PKB series

## POLE MOUNTING BELT



PKB-10PM, 10P



PKB-10S, 20S

- Pole mounting belt for attachment of enclosures with suitable pole mount brackets or construction onto poles.
- Designed for one time use only (not reusable).
- Strong stainless steel clamping type and easy installation plastic type are available.

## PKB dimensions

■ DXF/DWG/PDF drawings available on our website.

PKB-10PM, 10P

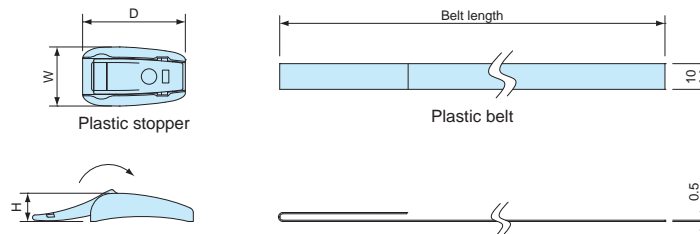

PKB-10S

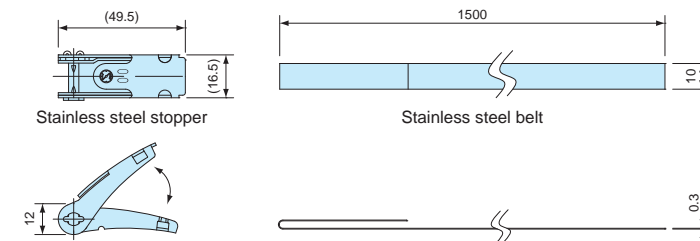

PKB-20S

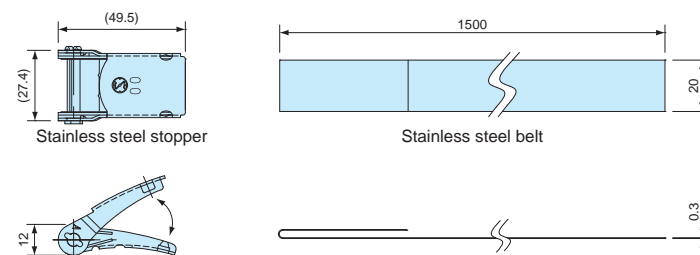

## Components

Part name	Material	Color / Finish
Stopper	Stainless steel SUS304 • POM	Barrel finish • Black
Belt	Stainless steel SUS430 • PET	Bright annealed finish • Gray

## Product no. / Details

Product no.	W	D	H	Belt length	Belt material	Tensile strength (horizontal)	Weight (g)	Pack of
PKB-10PM	23	24	11	500 mm	PET	0.8kN	14	2
PKB-10P	23	40	11	1,500 mm	PET	1.3kN	31.8	2
PKB-10S	—	—	—	1,500 mm	Stainless steel SUS304	1.4kN	101.6	2
PKB-20S	—	—	—	1,500 mm	Stainless steel SUS430	2.9kN	182.2	2

MAR series

## WALL MOUNT SUPPORT ARM



- Wall mount support arm move easily to the preferred positions.
- Suitable for command panel on machinery and touch panel controller. Easy installation onto the wall as well.
- Hole pitch on the monitor bracket is compatible with VESA mount standards. Possible to mount PC display without modification.

## MAR specifications

## MAR-312W

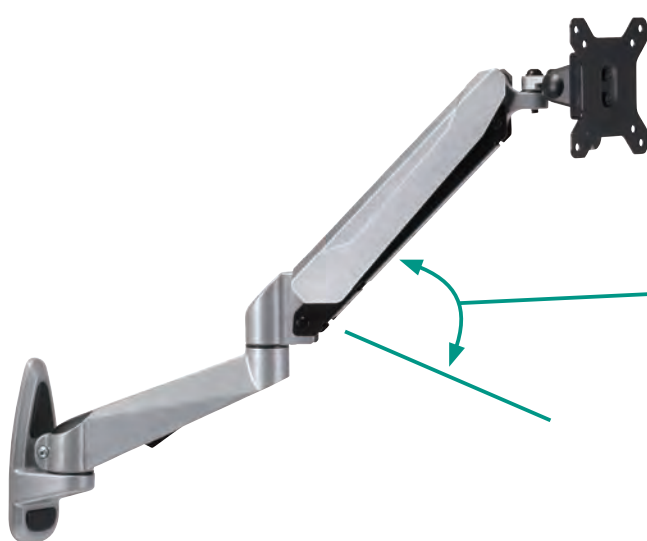

Adjustable bolt for up/down direction on arm is firmly set initially.  
Adjust the movement according to the installed device.

Arm can move in up/down direction.

Arm full length ~ 612mm

Max load : 6.5kg (including product weight, adjustable bolt firmly locked)

Material : Steel • Plastic • Aluminium diecast

\*Wall mounting screws included.

Pan-Tilt bracket dimensions

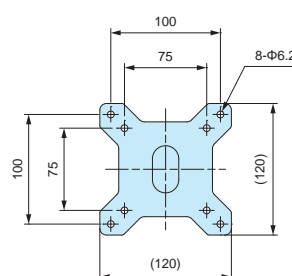

Wall mounting bracket dimensions

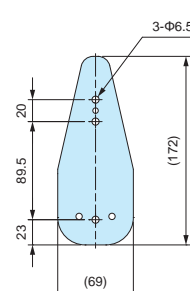

## MAR-111W

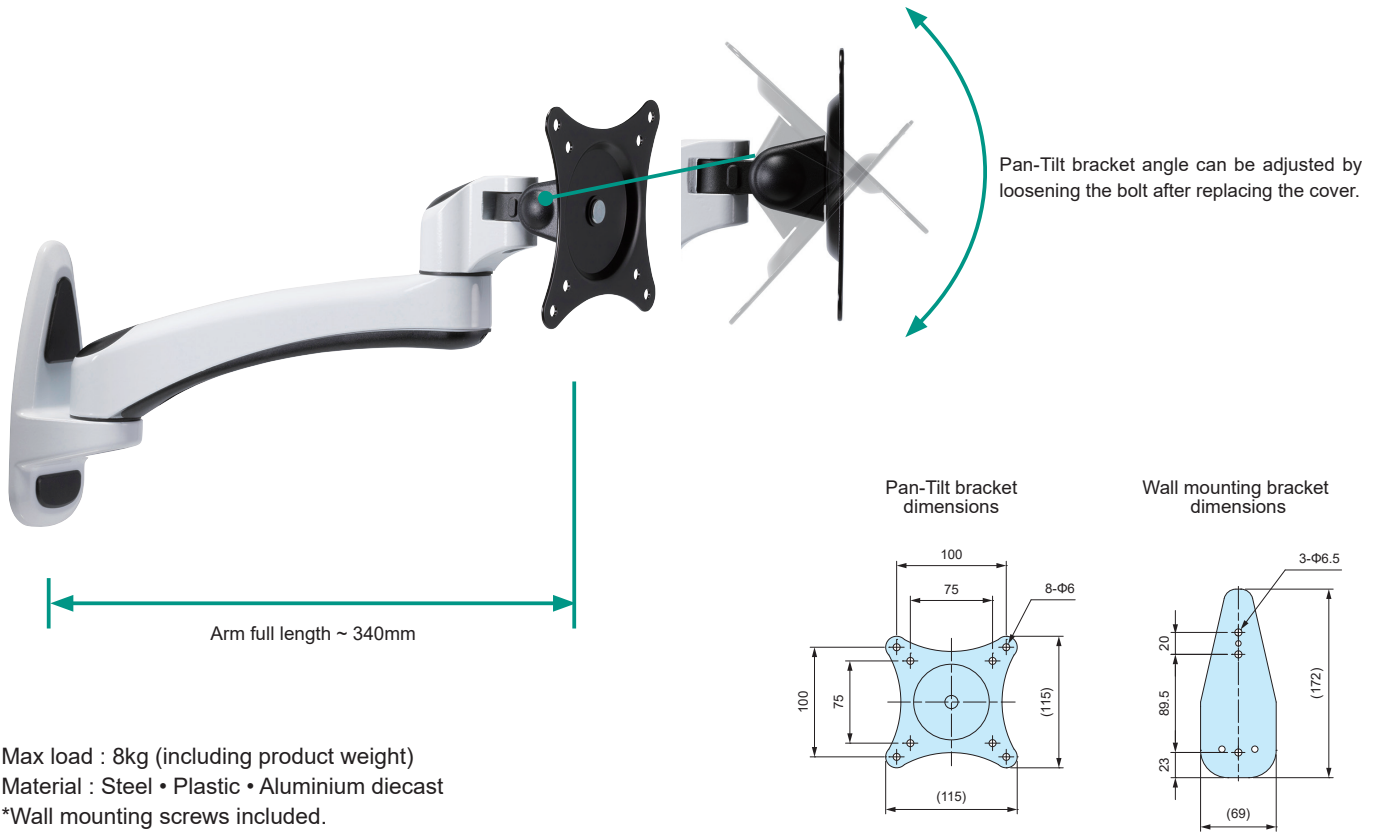

## MAR-110W

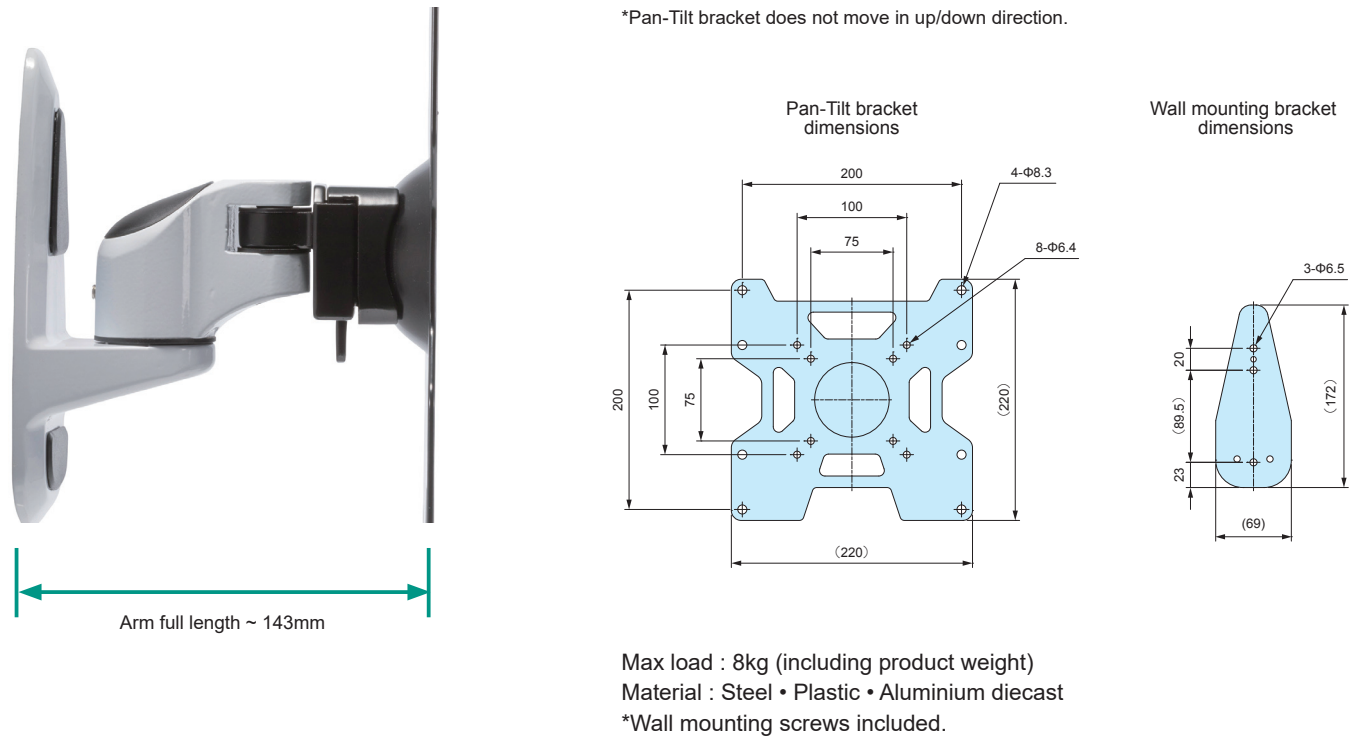

### Product no. / Details

Product no.	Arm full length	Arm color	Weight (kg)
MAR-312W	~ 612mm	Metallic gray	2.2
MAR-111W	~ 340mm	White / Black	1.0
MAR-110W	~ 143mm	White / Black	1.0