



- L-shape cable gland with M type threads.
- Allow wires to be routed vertically.
- Equivalent to IP67 protection class.

Technical Data	
Protection class :	Equivalent to IP67*
Operating temperature :	-20°C ~ +80°C

*In-house test



Components

No.	Part name	Material
1	Cap	PA66
2	Sealing Insert	NBR/PA66
3	Connector	PA66
4	O-ring	NBR
5	Lock Nut	PA66

REL dimensions

■ DXF/DWG/PDF drawings available on our website.

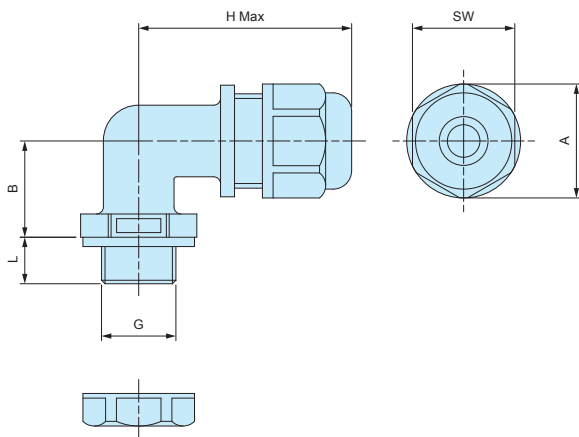

Installation example



Product no. / Details

Product no.	G		Cable range		H Max	L	SW	A	B	Pack of
	Thread size	Mounting hole	Min	Max						
● Black										
REL16- 7B	M16×1.5	Φ16.1	5	7	45.8	10	22	24.5	20.7	1
REL16-10B	M16×1.5	Φ16.1	8	10	45.8	10	22	24.5	20.7	1
REL20-11B	M20×1.5	Φ20.1	7	11	52.4	15	27.3	30.8	24.9	1
REL20-14B	M20×1.5	Φ20.1	11	14	52.4	15	27.3	30.8	24.9	1
REL25-16B	M25×1.5	Φ25.1	12	16	58	15	33.2	36.8	29.5	1
REL25-18B	M25×1.5	Φ25.1	15	18	58	15	33.2	36.8	29.5	1
REL32-22B	M32×1.5	Φ32.1	18	22	70	15	41	45.7	33.9	1