

**WM** series**SUSPENSION BRACKET**

Installation example

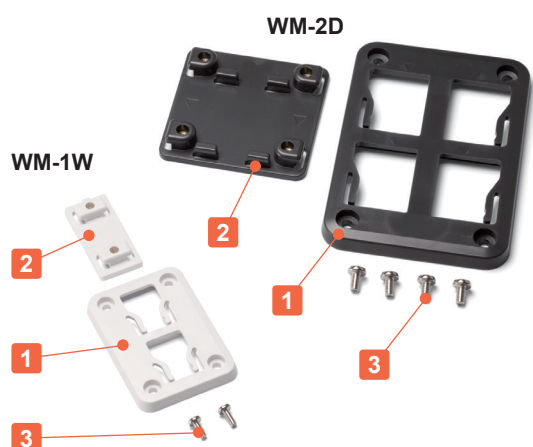

How to install

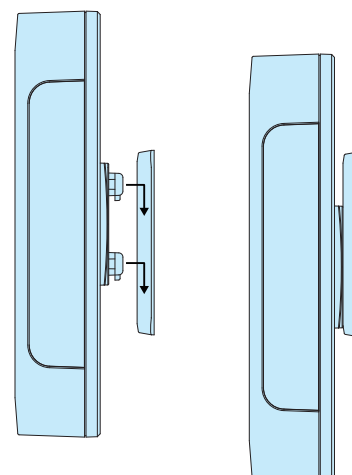

- Plastic wall mounting bracket. Easy attachment and removal.
- Large and small bracket types are available.
- Applicable to be used on plastic or metallic enclosures with a panel thickness of 0.8 ~ 3.5mm.
- To attach the suspension hook onto the enclosure, hole milling is required.
- Please be aware of the insertion direction of the suspension hook against the mounting base when attaching.
- DXF/DWG/PDF/STP drawings available on our website.

**Technical Data**

Max load : WM-1 - 2kg  
WM-2 - 5kg

\* The max load values listed are static load values only. Use caution when handling.

**Components**

No.	Name	Pcs	Material	Color / Finish
1	Mounting base	1	PC + ABS UL94HB	Off-white • Dark gray
2	Suspension hook	1	PC + ABS UL94HB	Off-white • Dark gray
3	Screw	2 (WM-1) 4 (WM-2)	Steel	Nickel plated

Included Screw

WM-1□ : Bind M3-8  
WM-2□ : Bind M4-88

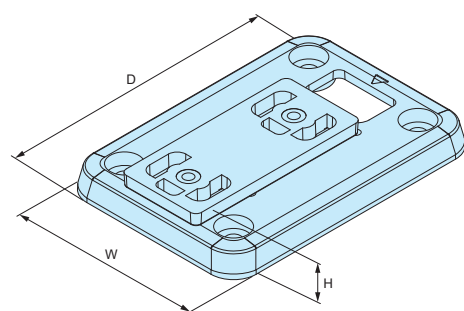
**Product no. / Details**

Product no.		W	H	D	Mountable thickness	Weight (g)
● Off-white	● Dark gray					
WM-1W	WM-1D	45	9	65	t0.8~t3.5	11.5
WM-2W	WM-2D	80	11	115	t0.8~t3.5	48

**PMB-1****POLE MOUNTING BRACKET**

Installation example



- DXF/DWG/PDF drawings available on our website.

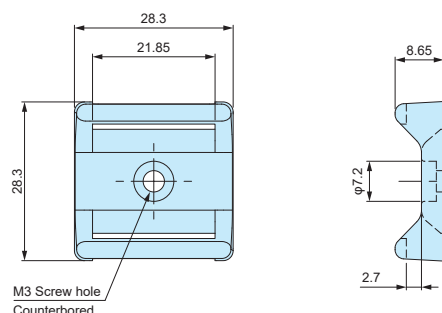

- Small size pole mounting bracket suitable for indoor use.
- Installation screws (M3 size) are separately sold.  
See page HES • HOS • MT for compatible MT3-4 screws.
- Minimum applicable pole diameter is  $\Phi 35$ .
- Use SNB • PKB • SCT mounting belt to install onto a pole.

**Product no. / Details**

Material / Color : PA66+GF (UL94HB) / Black

Product no.	Maximum load (kg)	Weight (g)	Pack of
PMB-1	1	3 (1 piece)	2

**WPMB-M4-3** series**POLE MOUNTING BRACKET**

- Pole mount bracket made from weather resistant ASA material.
- Suitable for both vertical and horizontal mounting.
- IPX7 protection can be maintained through the use of sealing washers.
- Hole milling is required for bracket installation.
- Pole mount is possible with the use of PKB series mounting belt. (see page 324 for PKB series)

**WPMB-M4-3 dimensions**

■ DXF/DWG/PDF/STP drawings available on our website.

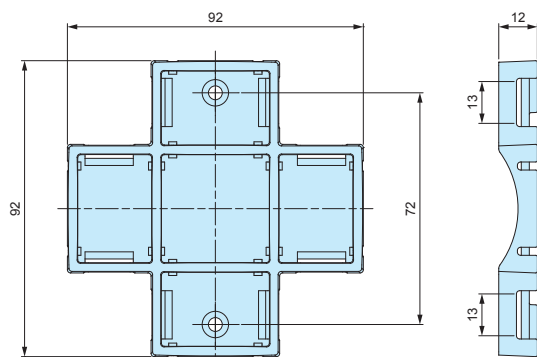
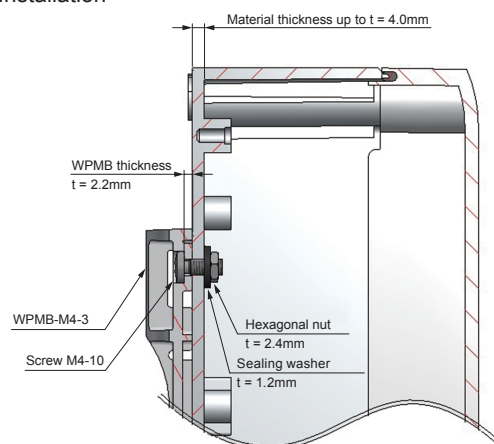
**Installation****Components**

No.	Part name	Pcs	Material	Color / Finish
1	Bracket	1	ASA UL94HB	White gray • Dark gray
2	Sealing washer	2	NBR, SPCC	Black
3	Screw (M4-10 Pan head)	2	Stainless steel	Unfinished
4	Hexagonal nut (M4 - JIS Type 3)	2	Stainless steel	Unfinished

**Product no. / Dimensions**

Product no.		Material thickness to install	Recommended torque	Max load (kg)	Weight (g)
● White gray	● Dark gray				
WPMB-M4-3G	WPMB-M4-3D	Up to t = 4.0mm	0.45N • m	5	26.5

■ Recommended torque listed is for reference only; actual may differ. Assemble after testing torque.

**PKB** series**POLE MOUNTING BELT**

PKB-10PM, 10P



PKB-10S, 20S

- Pole mounting belt for attachment of enclosures with suitable pole mount brackets or construction onto poles.
- Designed for one time use only (not reusable).
- Strong stainless steel clamping type and easy installation plastic type are available.

**PKB dimensions**

■ DXF/DWG/PDF drawings available on our website.

PKB-10PM, 10P

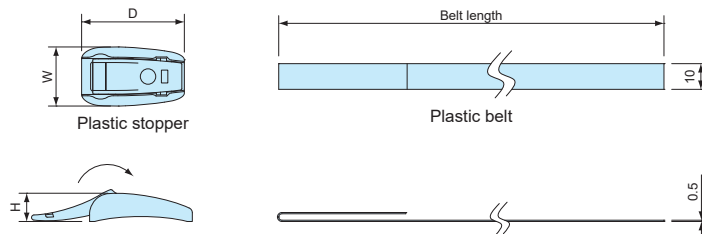

PKB-10S

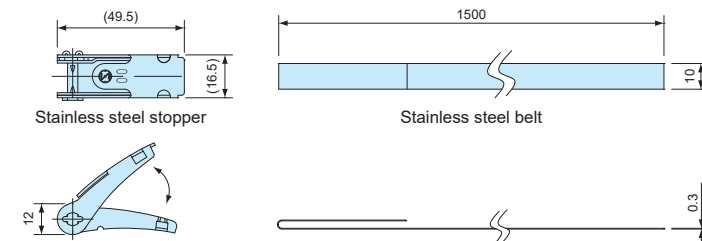

PKB-20S

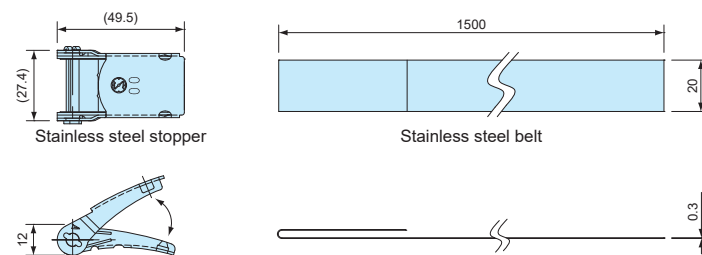
**Components**

Part name	Material	Color / Finish
Stopper	Stainless steel SUS304 • POM	Barrel finish • Black
Belt	Stainless steel SUS430 • PET	Bright annealed finish • Gray

**Product no. / Details**

Product no.	W	D	H	Belt length	Belt material	Tensile strength (horizontal)	Weight (g)	Pack of
PKB-10PM	23	24	11	500 mm	PET	0.8kN	14	2
PKB-10P	23	40	11	1,500 mm	PET	1.3kN	31.8	2
PKB-10S	—	—	—	1,500 mm	Stainless steel SUS304	1.4kN	101.6	2
PKB-20S	—	—	—	1,500 mm	Stainless steel SUS430	2.9kN	182.2	2