

NOTICE

Changes to Aluminium Material / Finish

- Change: Aluminium material, material finish
- Purpose: To ensure consistent quality throughout via streamlined supply chain and materials.

① ALUMINIUM CONTROL BOX

■ Affected series · color · parts

Product	Series	Color	Parts
SLOPED ENCLOSURE	CF series	GS	Slide panel · Screwed panel
ALUMINIUM CONTROL BOX	FC series	BS·BX·GS	Slide panel · Screwed panel
CONTROL BOX with CARRYING HANDLE	FCH series	GS	Slide panel · Screwed panel
OPEN-CLOSING CONTROL BOX	FCW series	BS·BX·GS	Slide panel · Open-closing panel
		BB	Open-closing panel

■ Details

Current (Old) Panel

Material	Finish
A1050P	Silver Hairline-brushed & Anodized
	Black Anodized



New Panel

Material	Finish
A1100P	Silver Anodized
	Black Anodized

② ALUMINIUM ENLOSURE

■ Affected series · color · parts

Product	Series	Color	Parts
DESKTOP ENCLOSURE	MS series	B·BS·G	Front panel · Rear panel
DESKTOP ENCLOSURE with STAND HANDLE	MSN series	B·BS·G	Front panel · Rear panel
RACK MOUNT ENCLOSURE	MSR series	B·BS·G	Front panel · Rear panel
DESKTOP ENCLOSURE with CARRYING HANDLE	MSY series	B·BS·G	Front panel · Rear panel

■ Details

Current (Old) Panel

Parts	Material	Finish
Front panel	A1050P	Silver Hairline-brushed & Anodized
		Black Hairline-brushed & Anodized
Rear panel	A1050P	Silver Anodized
		Black Anodized



New Panel

Parts	Material	Finish
Front Panel	A1100P	Silver Anodized
		Black Anodized
Rear Panel	A1100P	Silver Anodized
		Black Anodized

③ HEAT-SINK ENCLOSURES

■ Affected series · color · parts

Product	Series	Color	Parts
HEAT-SINK ALUMINIUM CASE	HIT series	SS	Front · Rear panel & Top · Bottom cover

■ Details

Current (Old) Parts

Parts	Material	Finish
Front · Rear panel	A1050P	Silver Hairline-brushed & Anodized
Top · Bottom cover	A1050P	Silver Hairline-brushed & Anodized



New Parts

Parts	Material	Finish
Front · Rear panel	A1100P	Silver Anodized
Top · Bottom cover	A1100P	Silver Anodized

- This change would be carried out as soon as current inventory has been depleted.
- There are no changes to the product number and / or dimensions.
- Pricing for each affected series / product shall remain the same.
- Current (old) parts and new parts may be mixed and shipped together in a bulk order.

Thank you for your understanding.

For more information, kindly contact us at: sales@takachi-el.co.jp



- Heat dissipation and cooling via the utilization of extruded aluminium heat-sink side plates.
- Rounded corners gives it an elegant feel.
- Aluminium extrusion parts provides high structural durability.
- Suitable for use as small-type fanless PC, digital audio equipment, and so on.
- Available in both Silver and Black color types.

- Optional aluminium isolation feet, AFS and AFM series are available. See page AFS•AFM-1 ~ AFS•AFM-2 for more details.

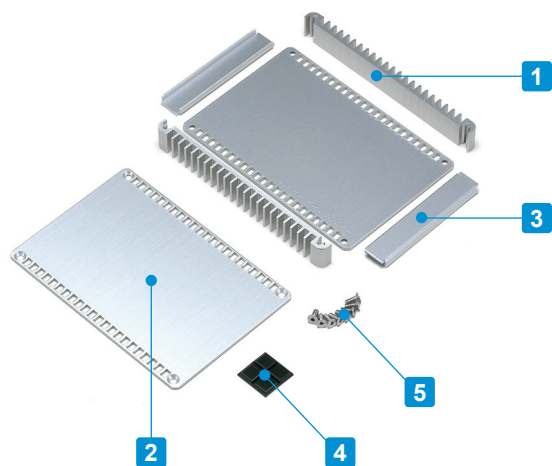

Application example



Included screws

Enclosure (Silver) M3-8 Hexagonal countersunk : Stainless steel : Unfinished x 8 pcs

Enclosure (Black) M3-8 Hexagonal countersunk : Steel : Black trivalent chromate x 8 pcs

※Hexagonal wrench included

Components

No.	Part name	Pcs	Material	Color / Finish
1	Heat-sink side plate	2	Extruded aluminium A6063S-T5	Silver • Black / Anodized
2	Top • Bottom cover	2	Aluminium A1050P t=2.0	Silver • Black / Hairline brushed & Anodized
3	Front • Rear panel	2	Aluminium A1050P t=1.5	Silver • Black / Hairline brushed & Anodized
4	Rubber feet	1 set	Polyurethane	Black
5	Screw	8	Stainless steel (SS color type) Steel (BB color type)	Unfinished Black trivalent chromate (Steel)

HIT dimensions

■ Drawings below are reference examples only.
DXF/DWG/PDF drawings available on our website.

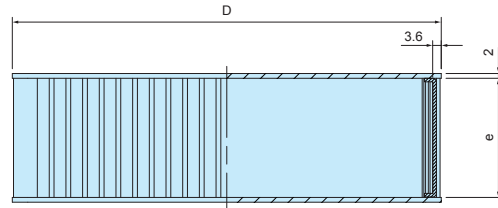
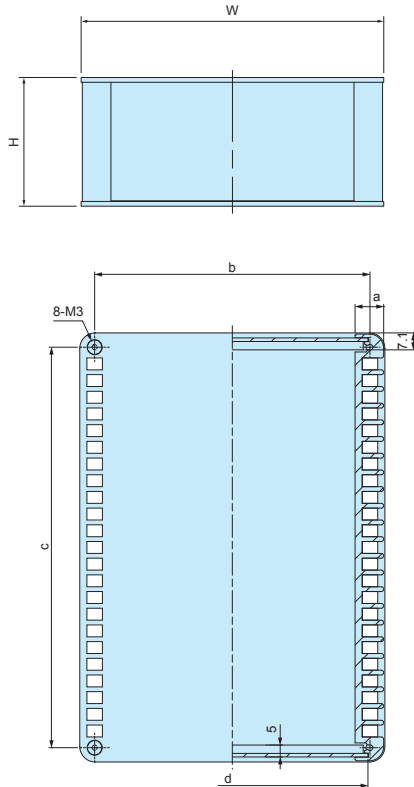

APPLICATION EXAMPLE

FIBER OPTICS EXTENSION UNIT

Product by Sanritz Automation (Japan)



AUDIO POWER SUPPLY for MacBook

Product by AY-densi (Japan)



Product no. / Dimensions

■ Thermal resistance calculation is based on the fins being perpendicular to the ground with temperature at 60°C.

Product no.		W	H	D	a	b	c	d	e	※ Thermal resistance rate (°C/W)	Weight (g)
● Silver	● Black										
HIT 9-2-13SS	HIT 9-2-13BB	89	20	130	8	81	118.6	78.8	16	9.14	183
HIT 9-4-13SS	HIT 9-4-13BB	89	40	130	8	81	118.6	78.8	36	5.6	255
HIT13-3-13SS	HIT13-3-13BB	130	30	130	8	122	118.6	119.8	26	6.82	289
HIT13-5-13SS	HIT13-5-13BB	130	50	130	8	122	118.6	119.8	46	4.83	370
HIT18-4-13SS	HIT18-4-13BB	180	40	130	8	172	118.6	169.8	36	5.6	414
HIT18-6-13SS	HIT18-6-13BB	180	60	130	8	172	118.6	169.8	56	4.29	503
HIT13-3-18SS	HIT13-3-18BB	128	30	180	12	115.5	168	113.8	26	4.38	411
HIT13-5-18SS	HIT13-5-18BB	128	50	180	12	115.5	168	113.8	46	3.1	535
HIT17-4-18SS	HIT17-4-18BB	174	40	180	12	161.5	168	159.8	36	3.6	578
HIT17-6-18SS	HIT17-6-18BB	174	60	180	12	161.5	168	159.8	56	2.76	719
HIT23-5-18SS	HIT23-5-18BB	228	50	180	12	215.5	168	213.8	46	3.1	772
HIT23-7-18SS	HIT23-7-18BB	228	70	180	12	215.5	168	213.8	66	2.5	928

AFS•AFM series

ALUMINIUM ISOLATION FEET



External type / Shot blast finish AFS series



Internal type / Reflective finish AFM series

- The surface treatment and finish allows the feet to exhibit a polished and luxurious feel.
- Non-slip NBR O-ring is located on the underside of the feet.

Product no. / Details

Product no.		D	H	Installation type	C	a	b	Pack of
● Silver	● Black							
AFS20- 8S	AFS20- 8B	20	8	External	Φ3.4	3	9	4
AFS25-10S	AFS25-10B	25	10	External	Φ4.5	4	12	4
AFS30-12S	AFS30-12B	30	12	External	Φ4.5	5	12	4
AFS35-14S	AFS35-14B	35	14	External	Φ4.5	5	12	4
AFS39-16S	AFS39-16B	39	16	External	Φ4.5	5	15	4
AFS44-18S	AFS44-18B	44	18	External	Φ4.5	5	20	4
AFS55-20S	AFS55-20B	55	20	External	Φ5.5	5	20	4
AFM15- 7S	—	15	7	Internal	M3	4	—	4
AFM20- 9S	—	20	9	Internal	M3	5	—	4
AFM25-12S	—	25	12	Internal	M4	7	—	4
AFM30-14S	—	30	14	Internal	M4	8	—	4
AFM35-16S	—	35	16	Internal	M4	10	—	4
AFM39-18S	—	39	18	Internal	M4	10	—	4
AFM44-20S	—	44	20	Internal	M4	10	—	4
AFM55-22S	—	55	22	Internal	M5	15	—	4

AFS • AFM dimensions

AFS series

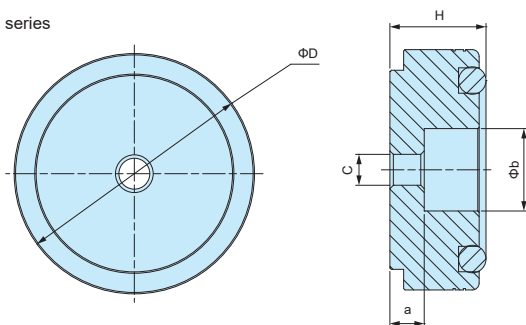

- DXF/DWG/PDF/STP drawings available on our website.

AFM series

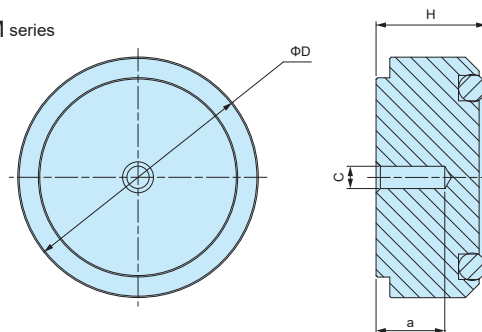

APPLICATION EXAMPLE

