

FC series ALUMINIUM CONTROL BOX

FC and FCW series are applicable for various purposes such as control and switch box, touch panel display, monitor box, and more.

APPLICATION EXAMPLE

Ultrasonic Flow Detector

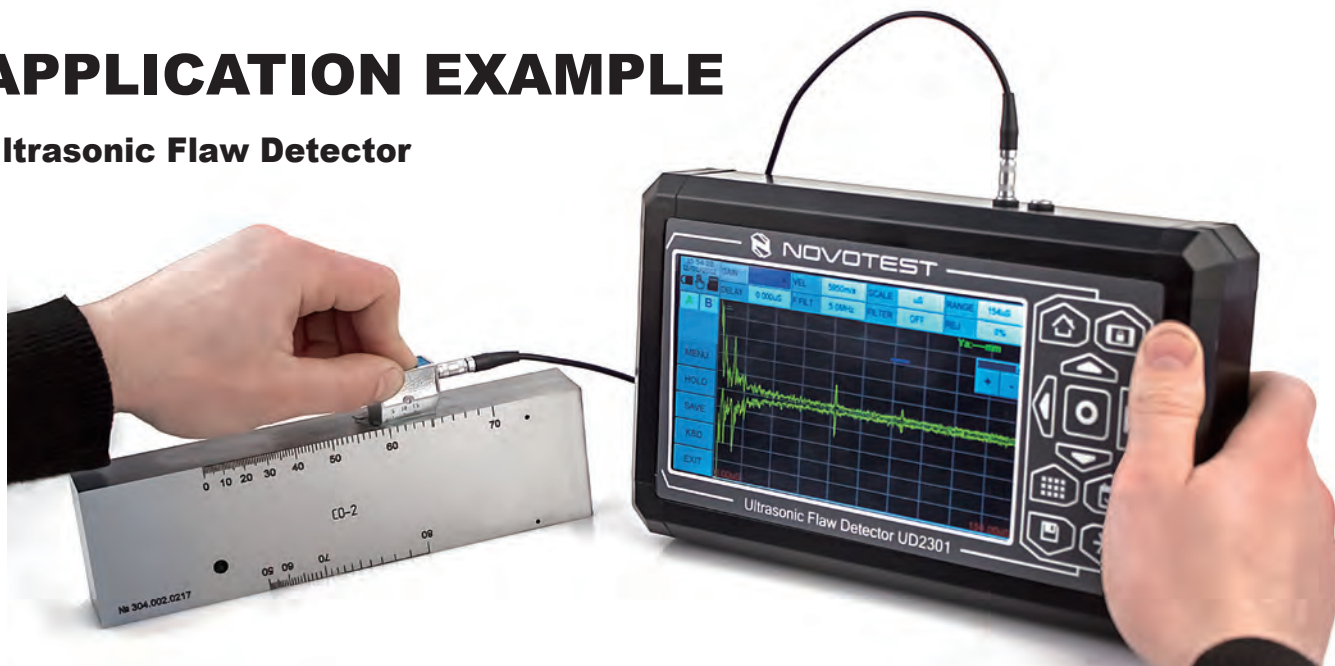

Coil Winding Machine

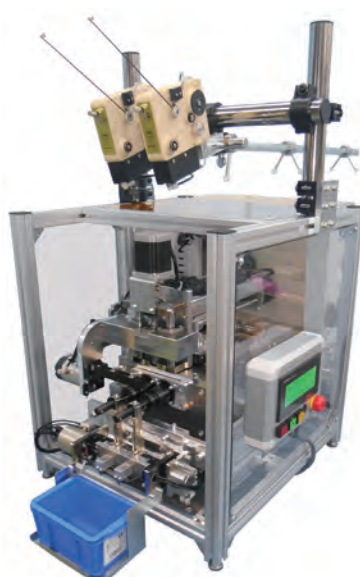

Remote Control Logger



Streaming Video Provider



Linux Data Logger



Solar Monitoring System

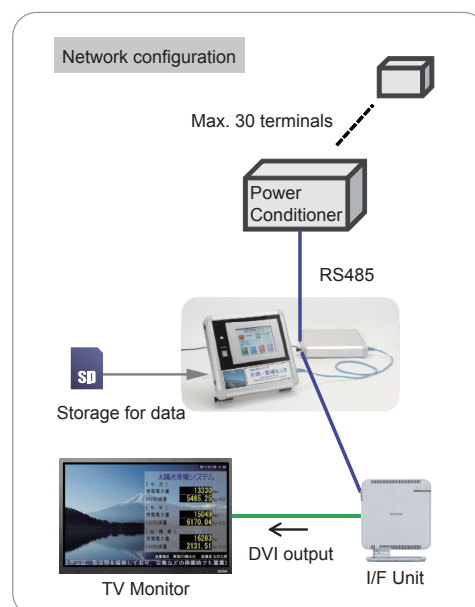
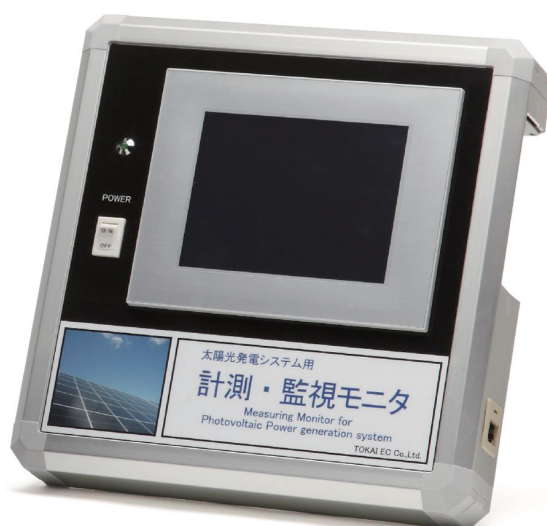

4 Channel Edge Node



Active RFID Tag Reader • Trigger



Hands-free type

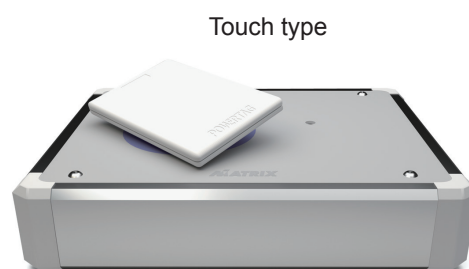

Touch type

Compact Solar Power Supply



VARIETY OF CUSTOM SIZED ENCLOSURES

Extruded models are adjustable in extrusion length (depth) in 0.1mm or 1.0mm intervals.
Sheet-metal models are adjustable in W/D/H dimensions in 1.0mm intervals.

EXTRUDED ALUMINIUM MODEL

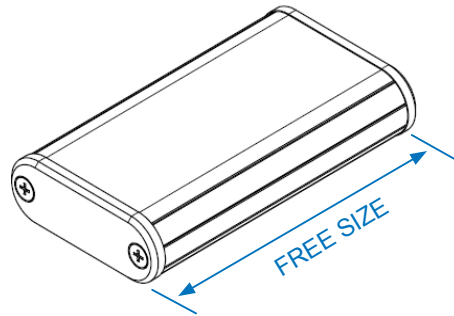
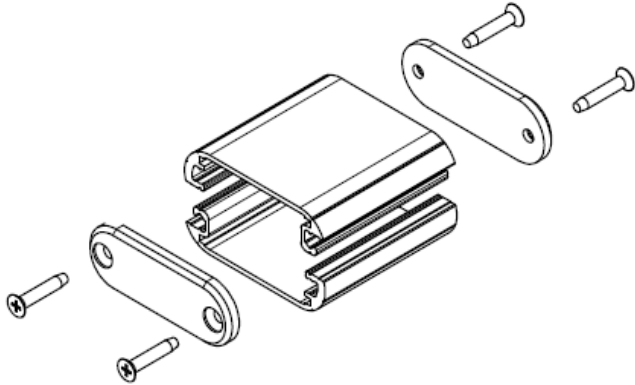

4 SIDE-EXTRUDED ALUMINIUM MODEL

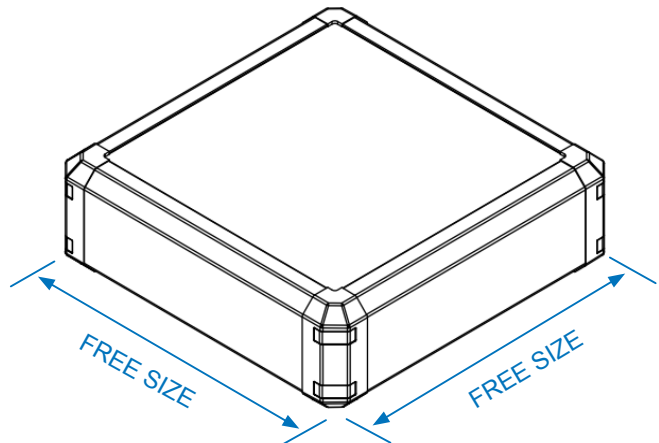
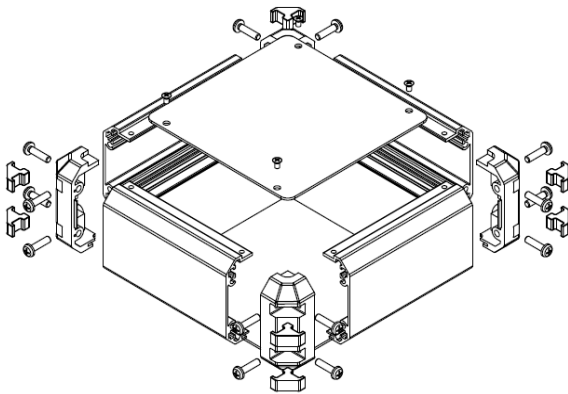

SHEET METAL MODEL

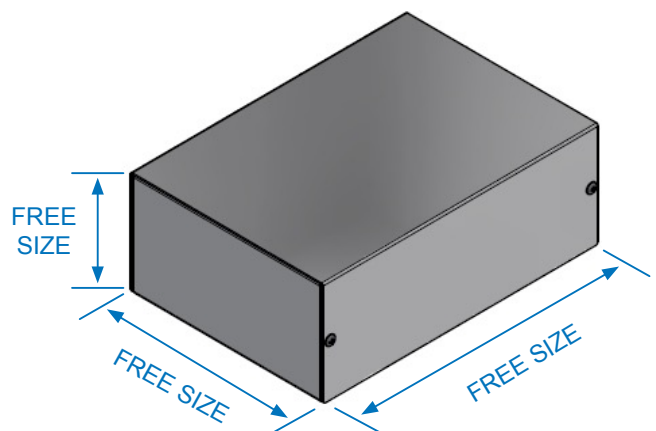
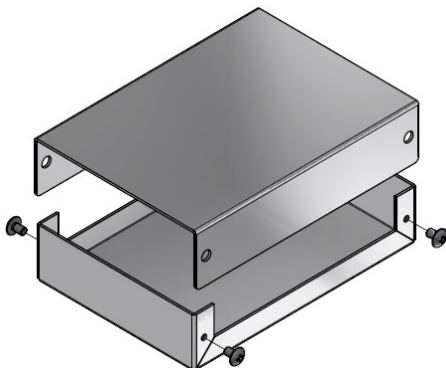

More custom sized models are available.

https://www.takachi-enclosure.com/cat/flexible_size

INQUIRING CUSTOM SIZED ENCLOSURES

- 1 Navigate to the free-size product page you wish to inquire on our website and click on the button indicated by the → arrow.



Custom sized shock-proof design instrument enclosure.
Corner guards are designed to be both aesthetically pleasing, and impact resistant.

Selectable 22 different Width/Height profiles and specified length (depth) from 40 to 500mm in 1mm intervals.
16 different color combinations can be specified.



CUSTOM SIZE WEB QUOTATION	3D View - Silver/Navy	3D View - 16 color types
3D View - With tilt legs	Exploded view	Color code

■ If there is no "WEB QUOTATION" click button, please send us your inquiry from the "INQUIRY FORM" on the CONTACT tab on our website.

- 2 Go to the CUSTOM SIZE WEB QUOTATION page and enter your preferred dimensions.

STEP1 Select required width / height.

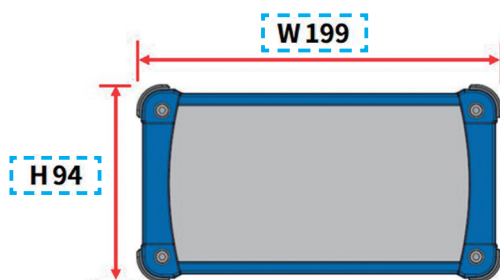

Select	W	H	Select	W	H
<input type="checkbox"/>	69	34	<input type="checkbox"/>	151	81
<input type="checkbox"/>	69	44	<input type="checkbox"/>	151	101
<input type="checkbox"/>	69	59	<input type="checkbox"/>	199	56
<input type="checkbox"/>	89	39	<input type="checkbox"/>	199	74
<input type="checkbox"/>	89	49	<input checked="" type="checkbox"/>	199	94
<input type="checkbox"/>	89	64	<input type="checkbox"/>	199	119
<input type="checkbox"/>	116	41	<input type="checkbox"/>	244	64
<input type="checkbox"/>	116	56	<input type="checkbox"/>	244	89
<input type="checkbox"/>	116	71	<input type="checkbox"/>	244	114
<input type="checkbox"/>	151	46	<input type="checkbox"/>	300	90
<input type="checkbox"/>	151	61	<input type="checkbox"/>	300	140

STEP2 Specify size D(depth) ... Enter dimensions in 1mm intervals.

Available from 40 to 500mm



*NOTE: Specified size D(depth) ≠ available internal dimension

Available internal dimension = **D dimension - 20mm**

Please take caution when calculating required D dimension.

- 3 After entering the quantity, click on the button indicated by the → arrow to generate a Product No.

STEP4 **Quantity** ※Quantity can be specified up to 5 slots.

pcs

▶Add quantity



▶ **GENERATE PRODUCT NO.**

Product No. **EXPS199 – 94 – 345SN** ※Please use this model number when ordering.

- 4 After entering your details and the message in our INQUIRY FORM, click on the CONFIRM button.

STEP5 **INQUIRY FORM**

Fill out the inquiry form and send it. We will give you quotation by Email.
Inquiry from the country where the distributor is located will be answered by the distributor.

Fields marked with ★ are required

Product No. **EXPS199-94-345SN** Quantity ★

E-mail ★

Company ★

Your name ★ ☐ Mr. ☒ Ms. First name Last name

Country ★

Message



▶ **CONFIRM**

Our privacy policy have been designed to ensure that personal information is not misused or used for purposes other than it is intended for.
[PRIVACY POLICY](#)

- 5 A TAKACHI sales representative will get in touch with you with a quote via e-mail.



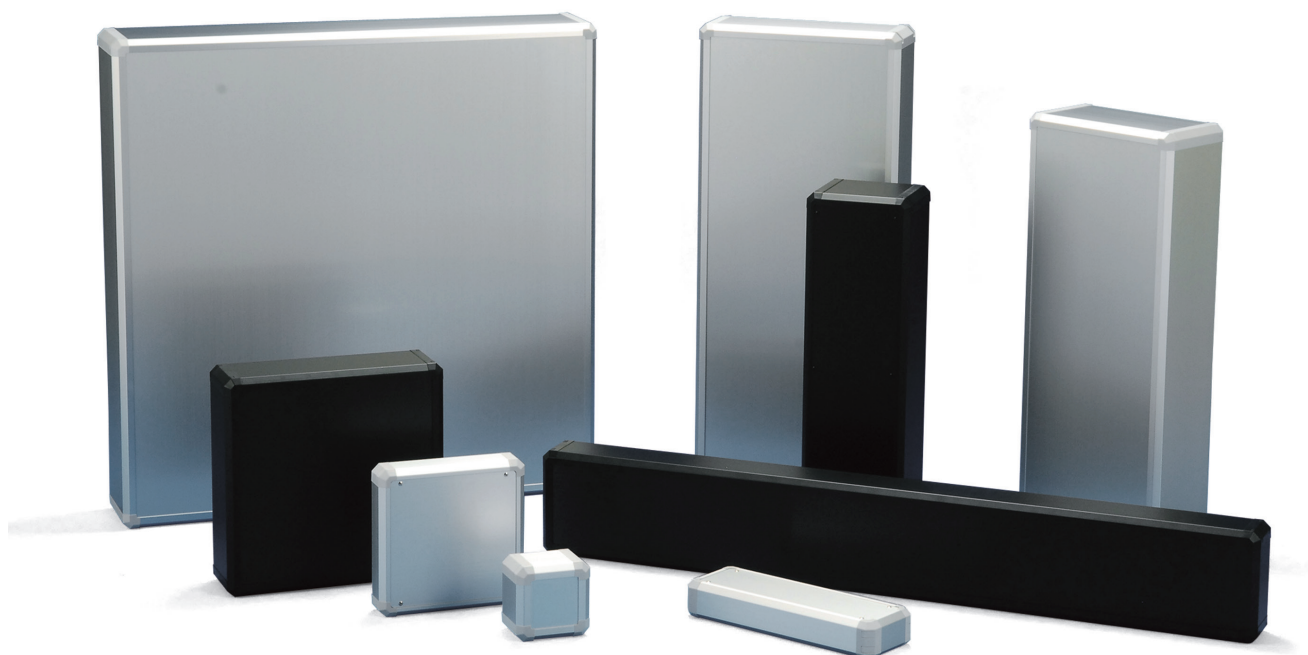

- Custom sized aluminium control box with available width and depth from 75mm to 1,000mm in 1mm intervals.
- Selectable in 7 different height: 38, 50, 63, 75, 100, 125 and 150mm.
- 4 different color combinations are available for selection.



- Standard size FC series are also available.
See FC series product pages for more information.



- Optional wall mount support arm MAR series is available.
See page 181 ~ 182 for further details.

Included screws :

M4-15 pan head & Trivalent chromate x 16 pcs

(M3-15 for H = 38 models)

M3-5 original trapezoid head (plus) & Nickel plated / Black trivalent chromate x 8 pcs or 12 pcs

Components

No.	Part name	Pcs	Material	Color / Finish
1	Frame	4	Extruded aluminium A6063S-T5	Silver • Black / Anodized with clear coating
2	Corner block	4	ABS UL94HB	Light gray • Black
3	Blind plug	8	Elastomer	Light gray • Black
4	Slide panel	1	Aluminium A1100P	Silver / Anodized • Black / Painted
-	Screwed panel	1	Aluminium A1100P	Silver / Anodized • Black / Painted

- Panels are covered with a protective film on one side

Lead Time

Custom Size Only
Custom Size + Hole Milling

4 business days (1 ~ 10 pcs)
9 business days (1 ~ 10 pcs)

Order Inquiry

For more information, contact us here at sales@takachi-el.co.jp

CUSTOM SIZE WEB QUOTATION

Send your inquiry via our online form now!

Visit the FCS product page on our website, click on the "CUSTOM SIZE WEB QUOTATION" button, and fill in the required details. The product number will be generated, and once your information have been filled in, simply click on SUBMIT and await for our sales team's contact!

1 Dimensions

■ W (Width) • D (Depth) : To select W and D dimensions from the table below in 1mm intervals.

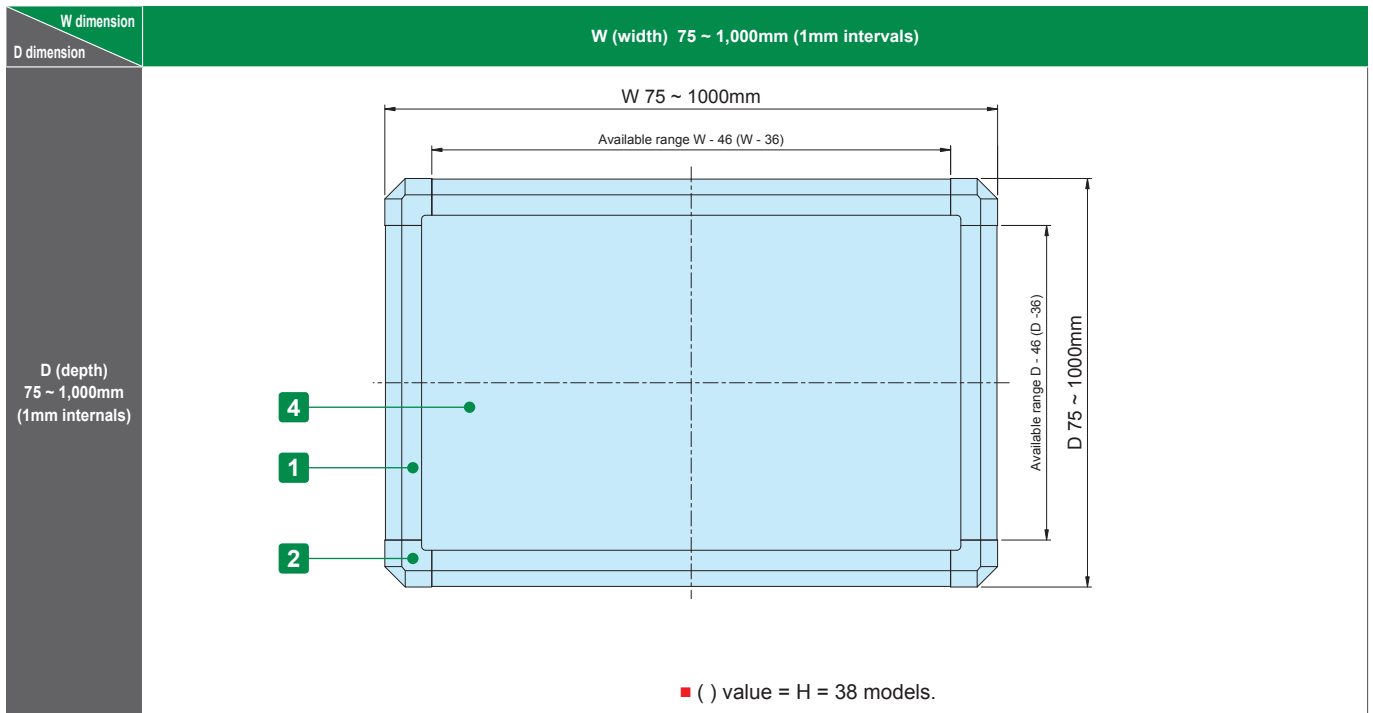

■ H (Height) : To select frame type from the table below.

H = 38	H = 50	H = 63	H = 75
H = 100	H = 125	H = 150	

2 Color

To select color code from the table below.

Code	GS	BS	BX	BB
Color				

Product Number

To determine a product number, fill W, H, D and select Color code in the following blank boxes.

Product no. FCS - -

1 W 1 D 1 H 2 Color code

Numbering example: W:770 x D:550 x H:75 and GS color code → **FCS770-550-75GS**

FCS dimensions

■ DXF/DWG/PDF drawings available on our website.

FCS○-○-38

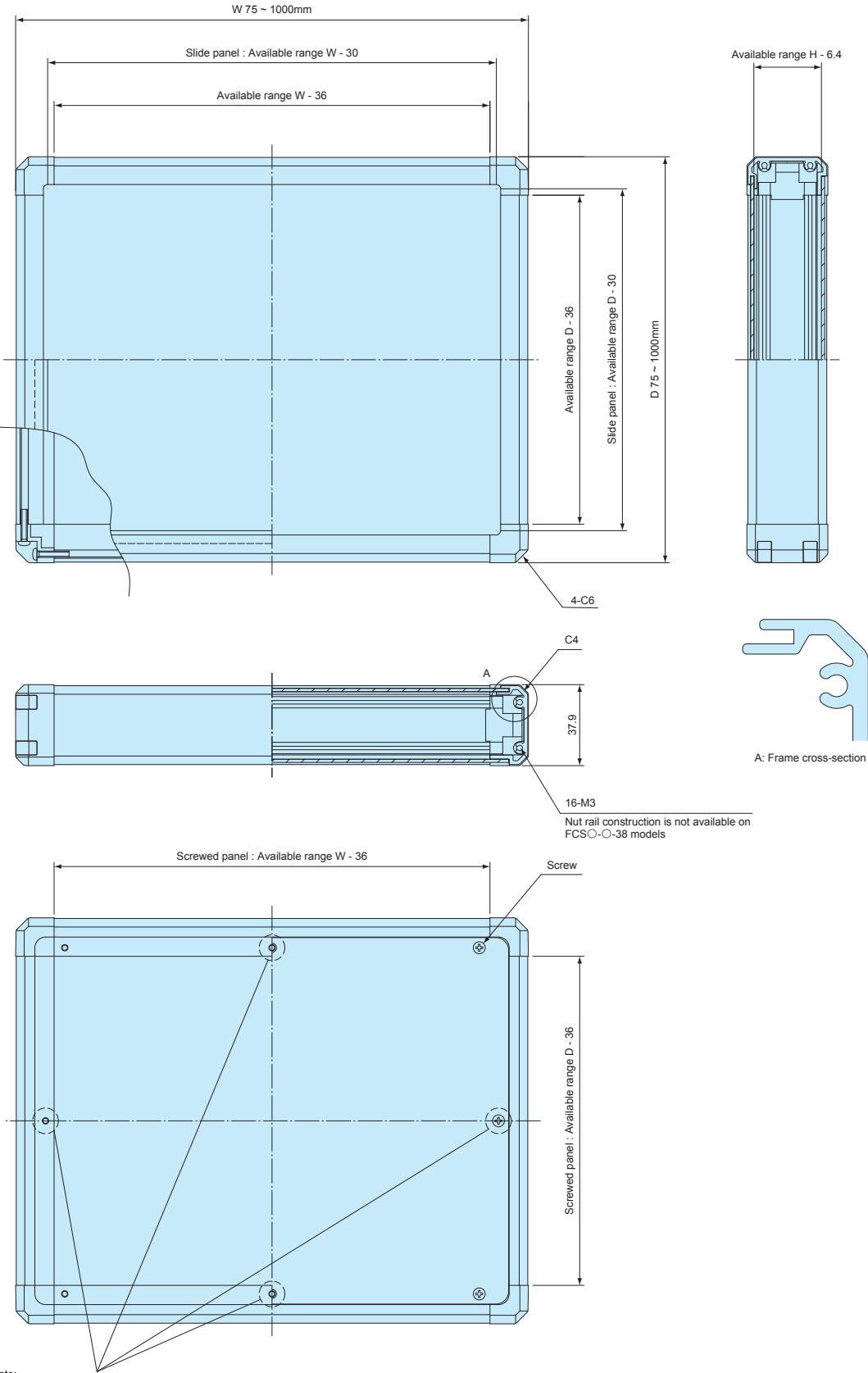

*Note:
1 set of screw holes (on each corresponding side) will be required for assembly if W or D dimension is 390mm or larger.
2 sets of screw holes (on each corresponding side) will be required for assembly if W or D dimension is 591mm or larger.

Screw Number Chart for Screwed Panel

D dimension W dimension	D dimension		
	75 ~ 389mm	390 ~ 590mm	591 ~ 1000mm
75 ~ 389mm	4	6	8
390 ~ 590mm	6	8	10
591 ~ 1000mm	8	10	12

FCS○-○-50
○-○-63
○-○-75

FCS○-○-100
○-○-125
○-○-150

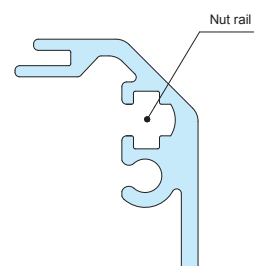
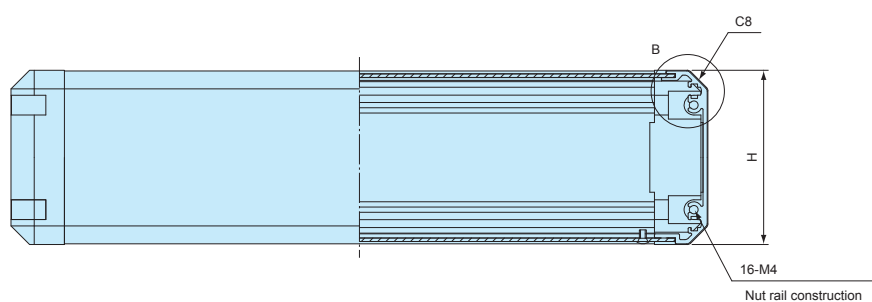
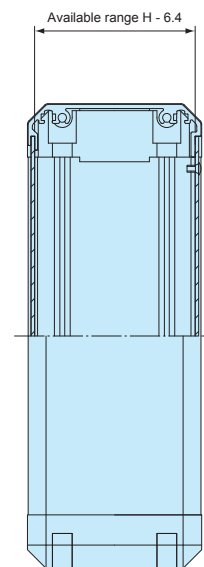
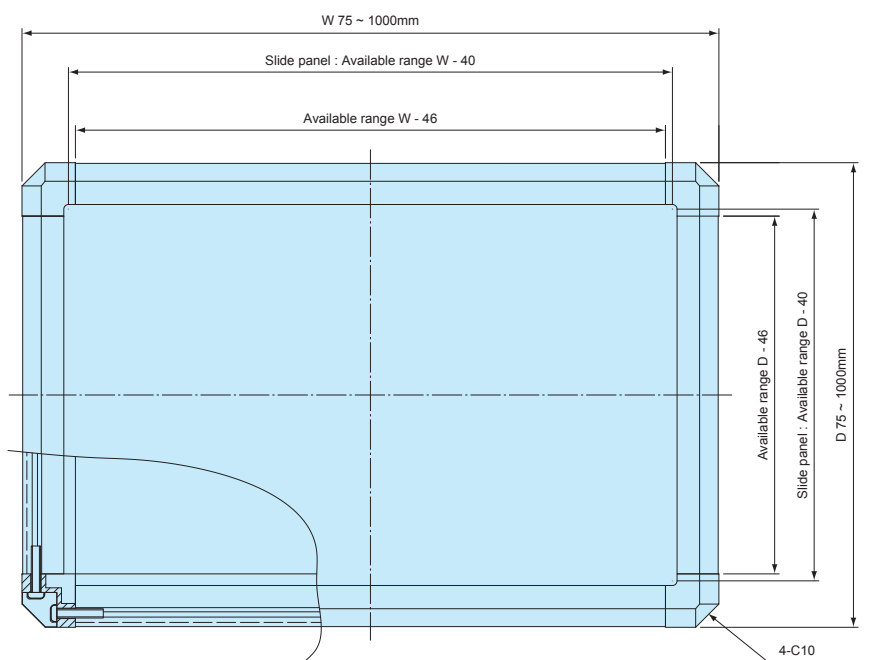

B: Frame cross-section

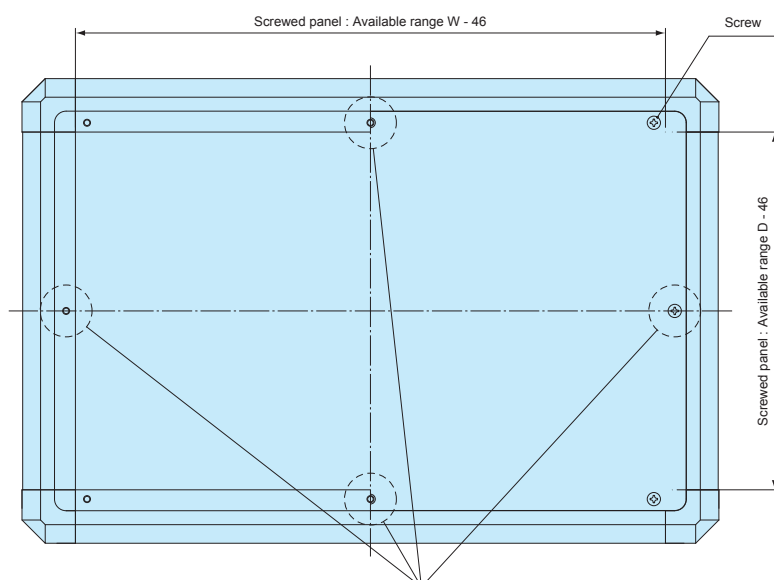

*Note:

- 1 set of screw holes (on each corresponding side) will be required for assembly if W or D dimension is 400mm or larger.
- 2 sets of screw holes (on each corresponding side) will be required for assembly if W or D dimension is 601mm or larger.

Screw Number Chart for Screwed Panel

D dimension W dimension	D dimension		
	75 ~ 399mm	400 ~ 600mm	601 ~ 1000mm
75 ~ 399mm	4	6	8
400 ~ 600mm	6	8	10
601 ~ 1000mm	8	10	12

FCWS SERIES

CUSTOM SIZED ALUMINIUM BOX WITH HINGED DOOR



- Custom sized aluminium box with available width from 150 to 400mm, and depth from 150mm to 600mm in 1mm intervals.
- Selectable in 6 different height types: 50, 63, 75, 100, 125 and 150mm.
- Selectable in 4 different color combinations, with Normal type, or with key lock type handle.
- Standard size FCW series are also available (width and depth available in 50mm intervals).



■ See FCW series product pages for more information.

Included screws :

M4-15 pan head, trivalent chromate x 16 pcs

M3-5 pan head, trivalent chromate / black trivalent chromate x 2 pcs or 3 pcs

M3-5 countersunk trivalent chromate / black trivalent chromate x 2 pcs or 3 pcs

M4-8 trivalent chromate with washer x 2 pcs or 4 pcs

M4-6 trivalent chromate with washer x 2 pcs or 4 pcs

Components

No.	Part name	Pcs	Material	Color / Finish
1	Frame	4	Extruded aluminium A6063S-T5	Silver • Black / Anodized
2	Corner block	4	ABS UL94HB	Light gray • Black
3	Blind plug	8	TPE	Light gray • Black
-	Slide panel	1	Aluminium A 1100P t =1.5	Silver / Anodized
			Aluminium A 1100P t =1.5	Black / Painted
4	Open-closing panel	1	Aluminium A 1100P t =2.0	Silver • Black / Anodized
5	Flat handle	1 set	Diecast zinc	Silver • Black / Painted
6	Hinge	1 set	Diecast zinc	Silver • Black / Painted
-	Panel protection pad	6	Polyolefin foam	Black

Confirm Product No.

Confirm product no. with **1**~**3** values on page FCWS-2.

Product no. FCWS

- -
W **D** **H** **Handle Code** **Color Code**

Example : W = 255mm, D = 352 mm, H = 125.4mm, Normal type handle, and GS color.

FCWS 255 - 352 - 125 N GS

1 Specify Dimensions

Specify W and D dimensions refer to the below chart and select H (height).

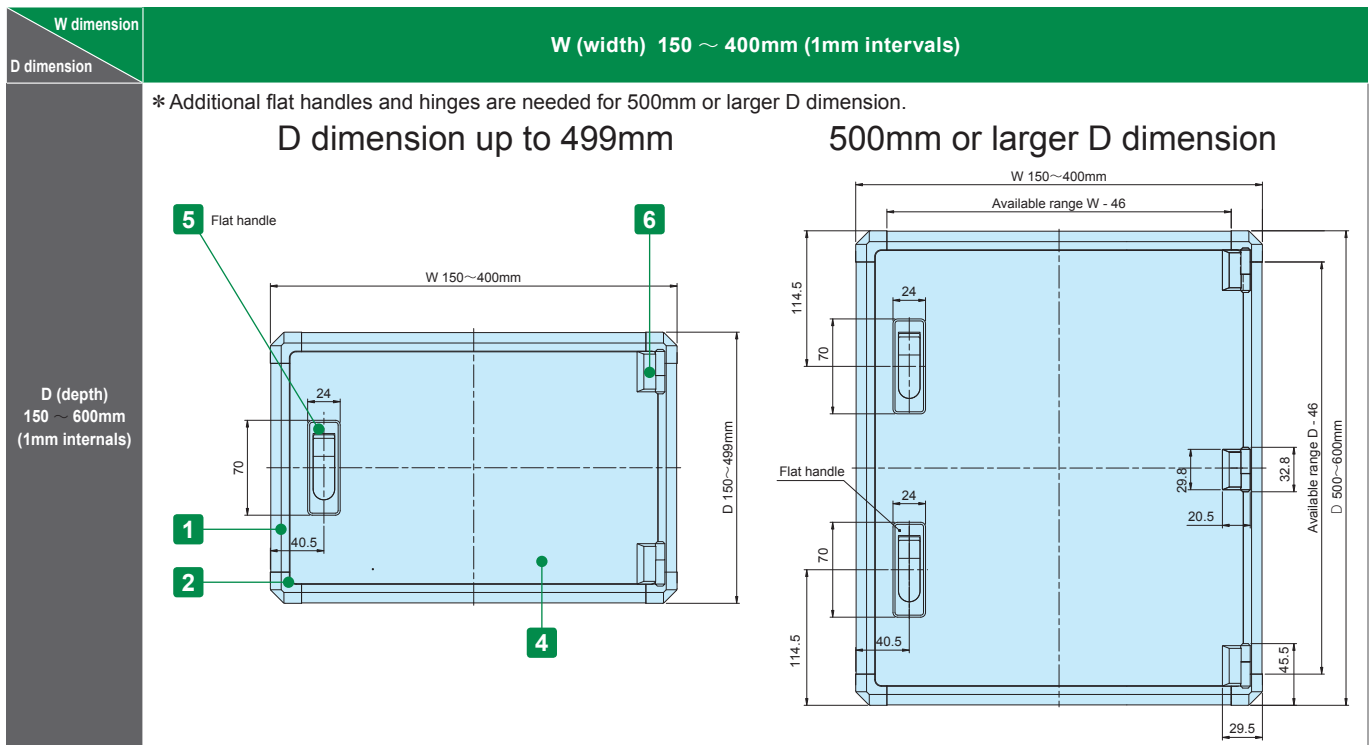

■ Select from 6 available height types.

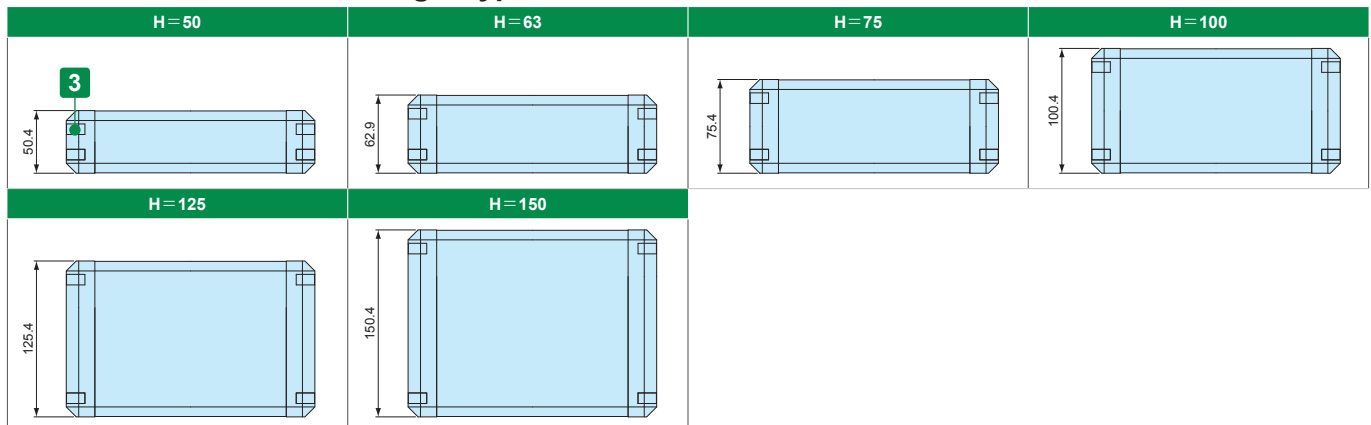

2 Select Flat Handle Type

Select normal or key lock type

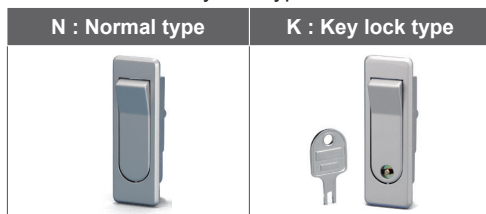

3 Select Color

Select from 4 available colors



Lead time

Custom Size Only
Custom Size + Hole Milling

6 business days (1 ~ 5 pcs)
12 business days (1 ~ 5 pcs)

Order Inquiry

For more information, contact us here at sales@takachi-el.co.jp

FCWS dimensions

Models with D dimension up to 499mm have 2 hinges and 1 flat handle.

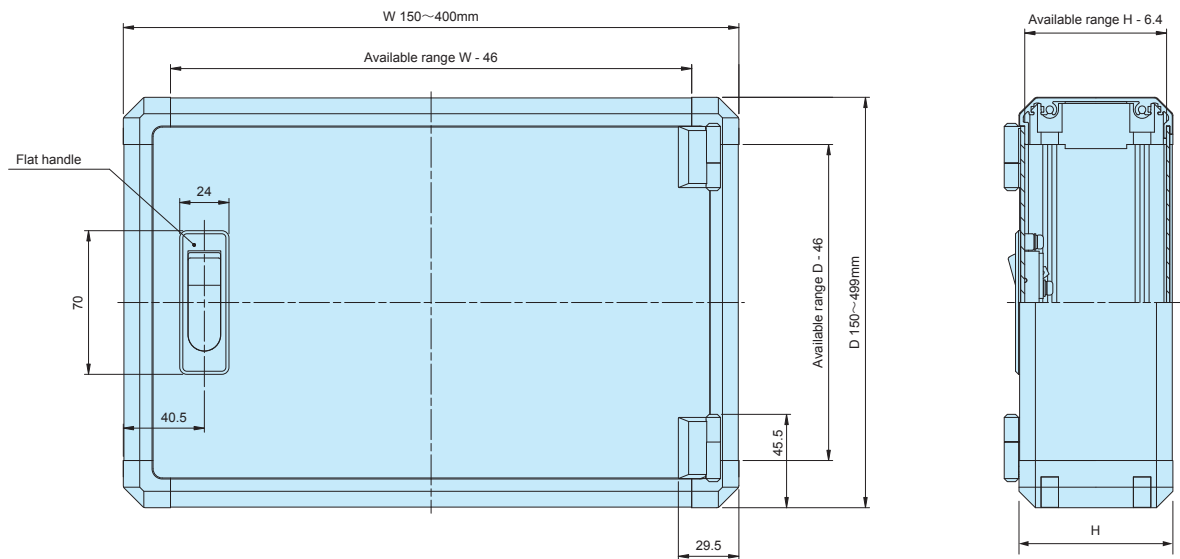

Models with 500mm or larger D dimension have 3 hinges and 2 flat handles.

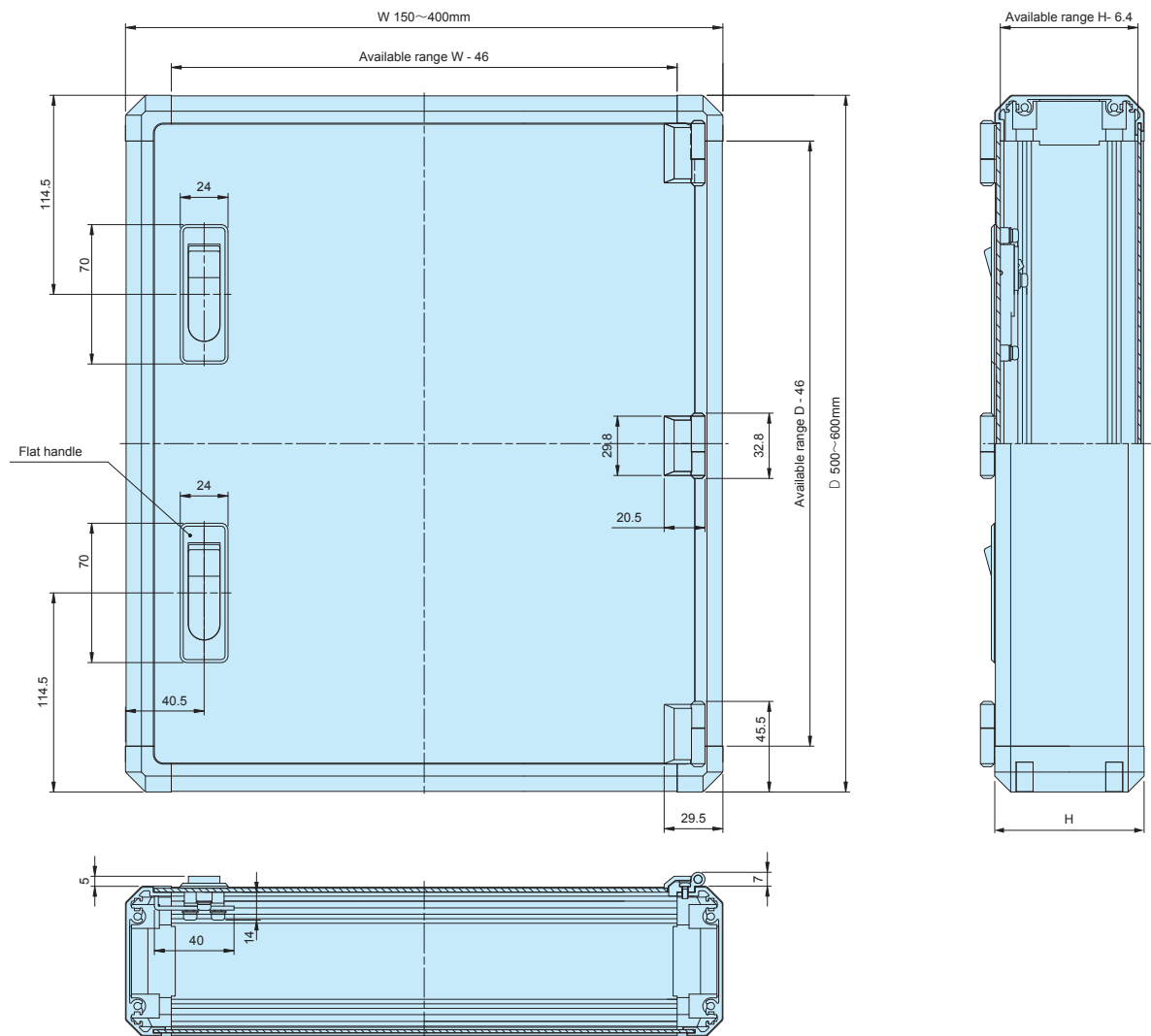

Cross-section Veiw

FCWS

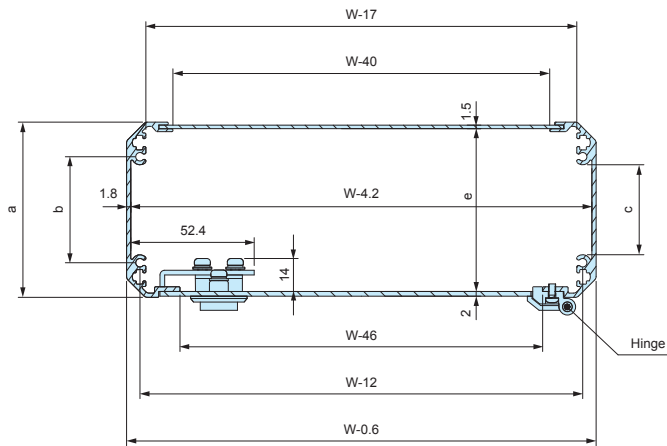

View from W side

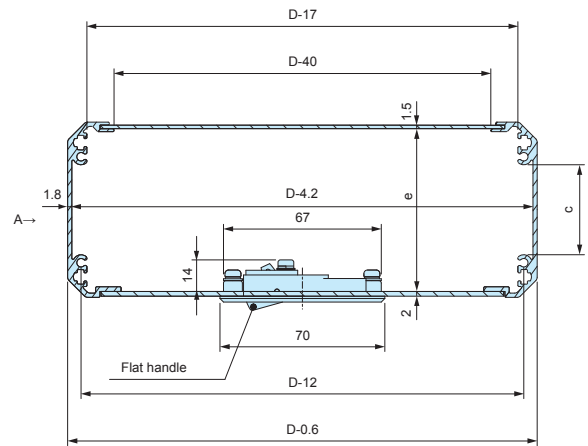

View from D side

H (Box height)	a	b	c	e
50.4	49.4	20	13.2	44
62.9	61.9	32.5	25.7	56.5
75.4	74.4	45	38.2	69
100.4	99.4	70	63.2	94
125.4	124.4	95	88.2	119
150.4	149.4	120	113.2	144

FCWS SERIES

CUSTOM SIZED ALUMINIUM BOX WITH HINGED DOOR



- Custom sized aluminium box with available width from 150 to 400mm, and depth from 150mm to 600mm in 1mm intervals.
- Selectable in 6 different height types: 50, 63, 75, 100, 125 and 150mm.
- Selectable in 2 different color combinations, with Normal type, or with key lock type handle.
- Standard size FCW series are also available (width and depth available in 50mm intervals).



- See FCW series product pages for more information.

Included screws :
 M4-15 pan head, trivalent chromate x 16 pcs
 M3-5 pan head, trivalent chromate x 2 pcs or 3 pcs
 M3-5 countersunk trivalent chromate x 2 pcs or 3 pcs
 M4-8 trivalent chromate with washer x 2 pcs or 4 pcs
 M4-6 trivalent chromate with washer x 2 pcs or 4 pcs

Components

No.	Part name	Pcs	Material	Color / Finish
1	Frame	4	Extruded aluminium A6063S-T5	Silver / Anodized
2	Corner block	4	ABS UL94HB	Light gray • Black
3	Blind plug	8	TPE	Light gray • Black
–	Slide panel	1	Aluminium A 1100P t=1.5	Silver / Anodized
4	Open-closing panel	1	Aluminium A 1100P t=2.0	Silver / Anodized
5	Flat handle	1 set	Diecast zinc	Silver / Painted
6	Hinge	1 set	Diecast zinc	Silver / Painted
–	Panel protection pad	6	Polyolefin foam	Black

Confirm Product No.

Confirm product no. with **1**~**3** values on page FCWS-2.

Product no. FCWS

- -
W **D** **H** **Handle Code** **Color Code**

Example : W = 255mm, D = 352 mm, H = 125.4mm, Normal type handle, and GS color.

FCWS - -

1 Specify Dimensions

Specify W and D dimensions refer to the below chart and select H (height).

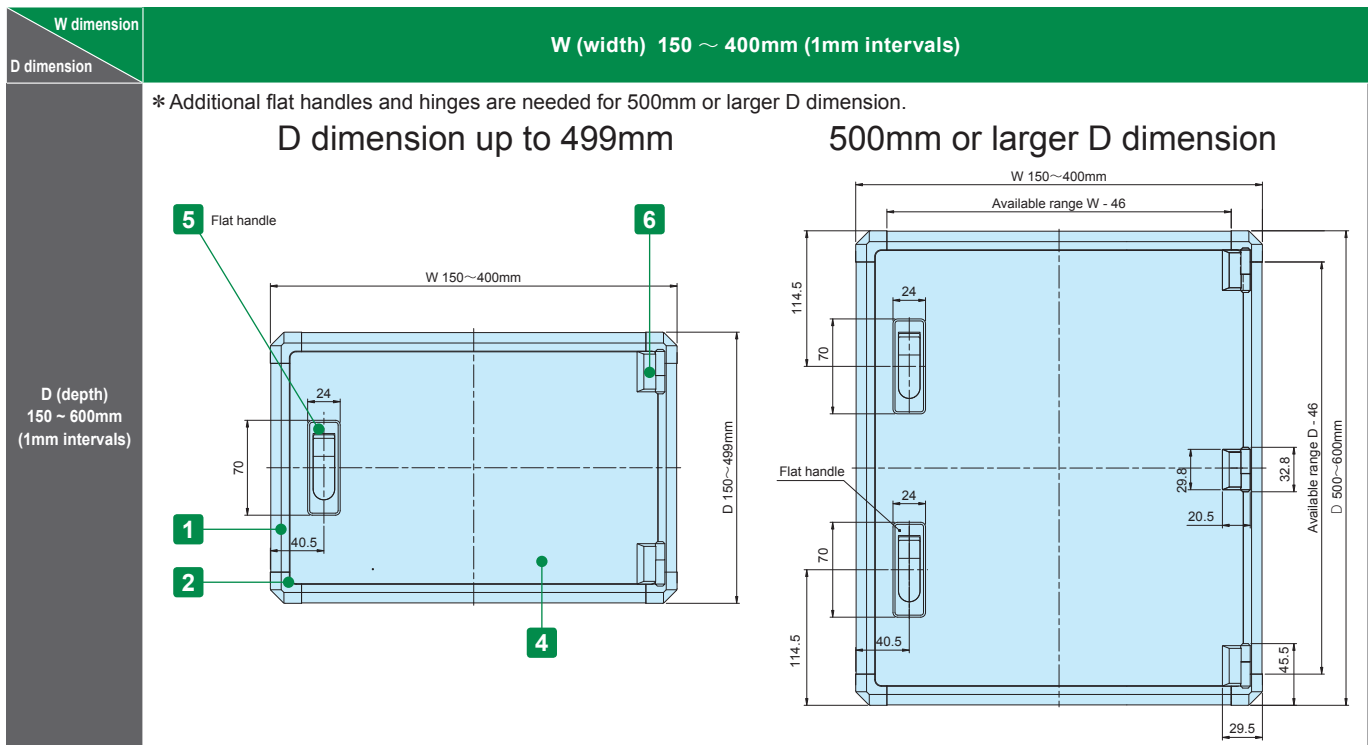

■ Select from 6 available height types.

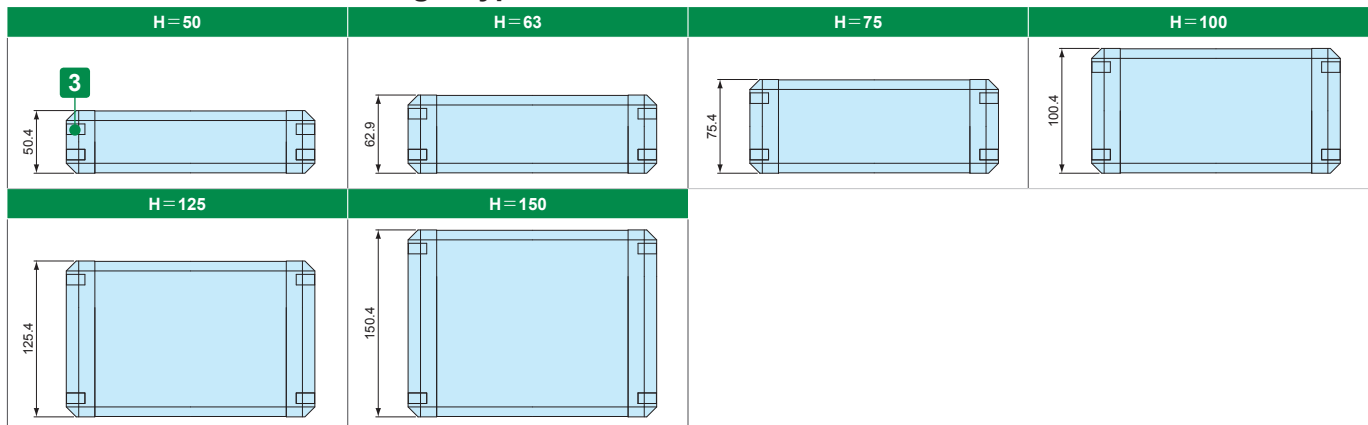

2 Select Flat Handle Type

Select normal or key lock type

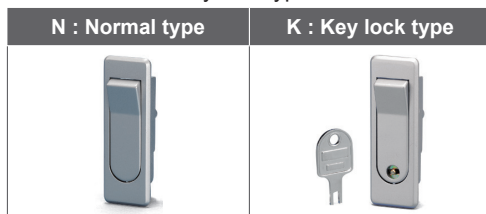

3 Select Color

Select from 2 available colors

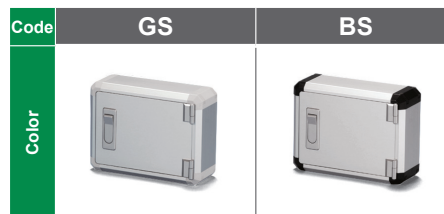

Lead time

Custom Size Only
Custom Size + Hole Milling

6 business days (1 ~ 5 pcs)
12 business days (1 ~ 5 pcs)

Order Inquiry

For more information, contact us here at sales@takachi-el.co.jp

FCWS dimensions

Models with D dimension up to 499mm have 2 hinges and 1 flat handle.

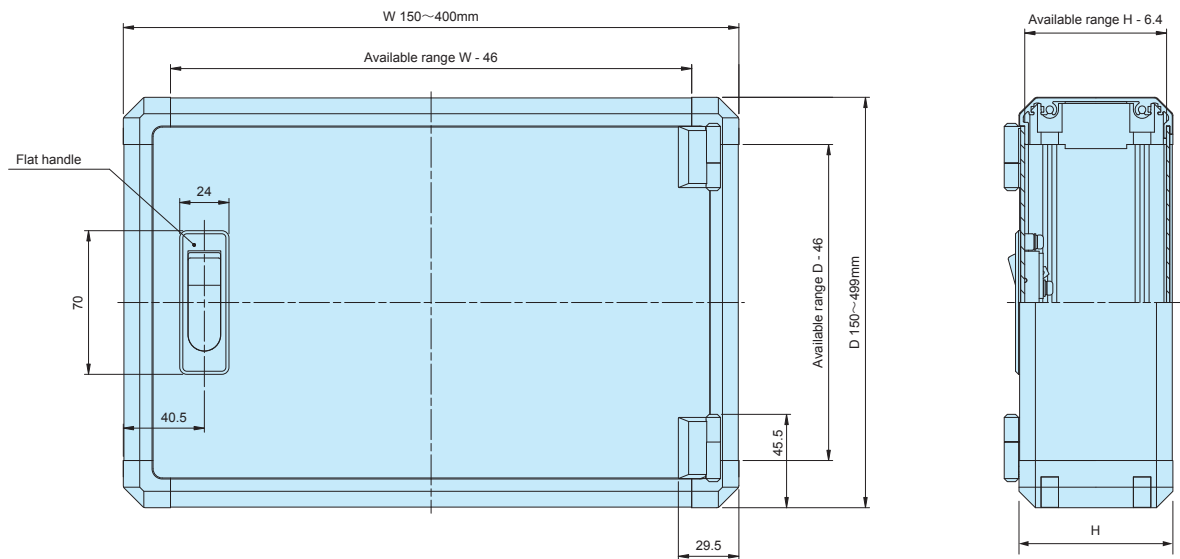

Models with 500mm or larger D dimension have 3 hinges and 2 flat handles.

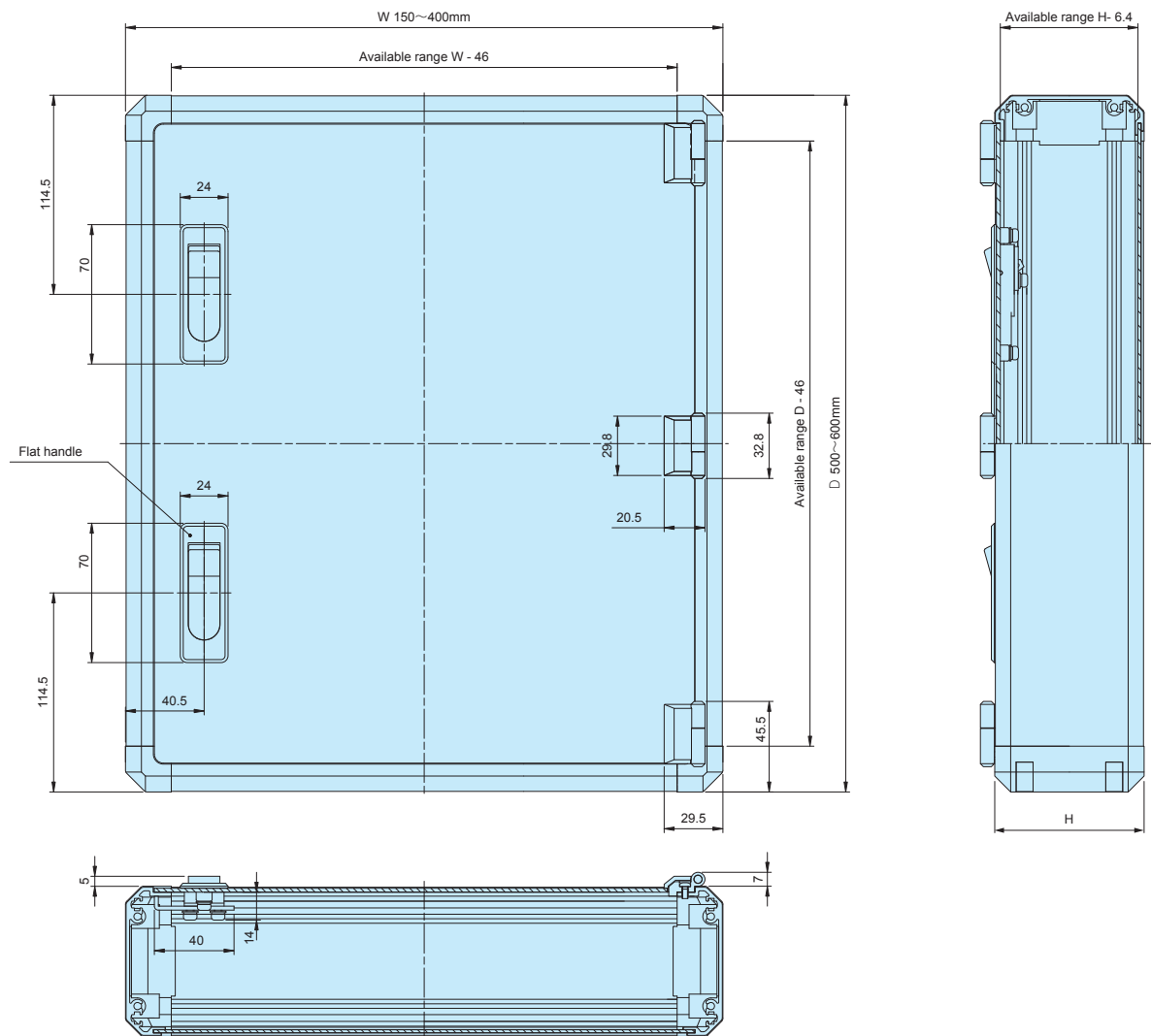

FCS•FCWS SERIES CUSTOM SIZED ALUMINIUM BOX

APPLICATION EXAMPLES

Custom sized FCS•FCWS series aluminium box is extremely versatile and can be used in various applications.

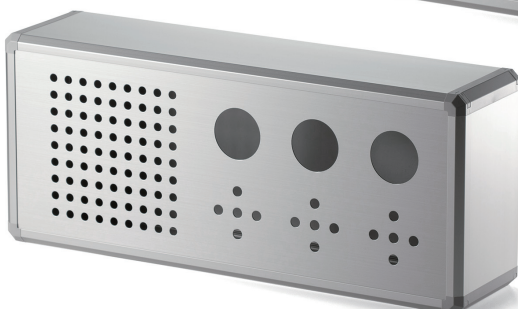
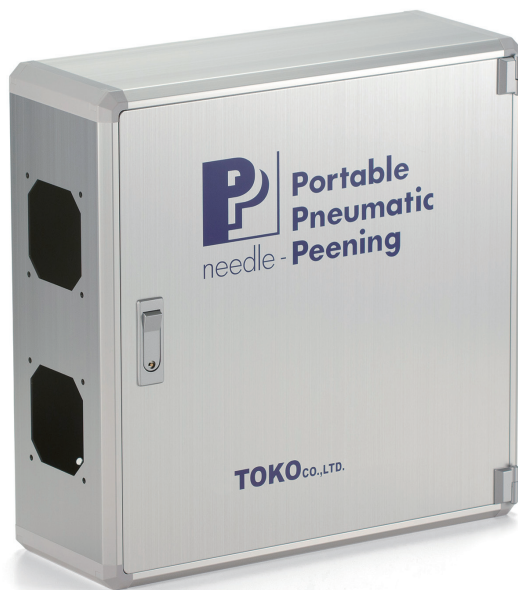

FCSC SERIES

CUSTOM SIZED ALUMINIUM MOUNTING PLATE for FCS • FCWS

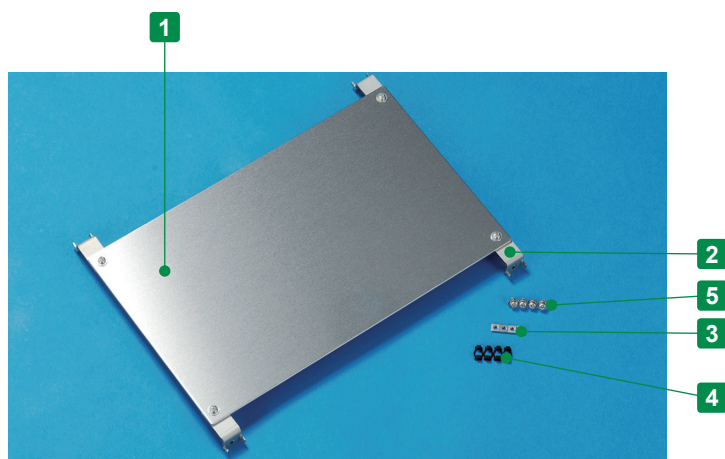

- Custom sized mounting plate can be made for FCS • FCWS custom sized box.
- Mounting bracket is selectable in 2 types: [1] H = 12mm, or [2] H = 22mm.
- Not suitable for FCS□-□-38 or FCWS□-□-38 models. (H = 37.9mm)
- Use 22mm height type when used in the FCWS series, open/close panel side.

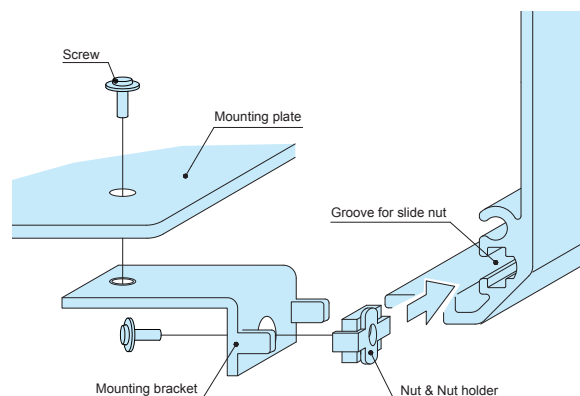

How to assemble

- ① Slide a M3 Nut and Nut holder into the groove on the FCS • FCWS frame.
- ② Screw the mounting bracket into the nut holder.
- ③ Screw the mounting plate onto the mounting bracket.

Components

No.	Part name	Material	Color / Finish
1	Mounting plate	Aluminium A1050P	Unfinished
2	Mounting bracket	Steel SECC	Zinc coated
3	M3 Nut	Steel SPCC	Trivalent chromate
4	Nut holder	POM	Black
5	Screw	Steel M3-6	Trivalent chromate

Select Bracket Height

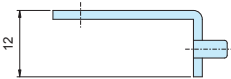
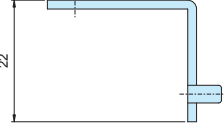
Code	1	2
Height		

Confirm Product No. Specify box dimensions and bracket height.

Product no. FCSC - -

Box W dimension Box D dimension Bracket height (1 or 2)

Example : Box W dimension = 450 mm, Box D dimension = 200 mm and Mounting Bracket type [1] H = 12mm.

FCSC - -

Lead time

Custom Size Only
Custom Size + Hole Milling

4 business days (1 ~ 10 pcs)
8 business days (1 ~ 10 pcs)

Order Inquiry

For more information, contact us here at sales@takachi-el.co.jp

FCSC dimensions

Available dimensions range : $W = 75 \sim 600\text{mm} \times D = 75 \sim 600\text{mm}$

※Caution For W and D dimensions larger than 300mm, 2 additional mounting holes will be added.
For W and D dimensions = 600mm, 4 additional mounting holes will be added.)

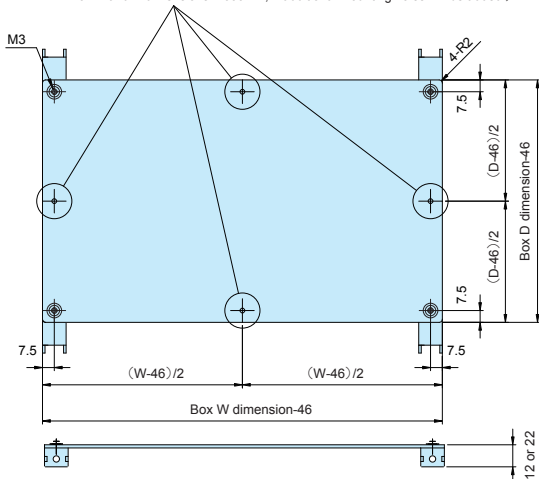

Box W dimension	Box D dimension	Number of holes
75~399mm	75~399mm	4
75~399mm	400~600mm	6
400~600mm	75~399mm	6
400~600mm	400~600mm	8

Included screws: M3-6 pan head trivalent chromate with flat washer x 8 or x 16 pcs

For W and D dimensions :
 $W = 400 \sim 600\text{mm} \times D = 601 \sim 1,000\text{mm}$

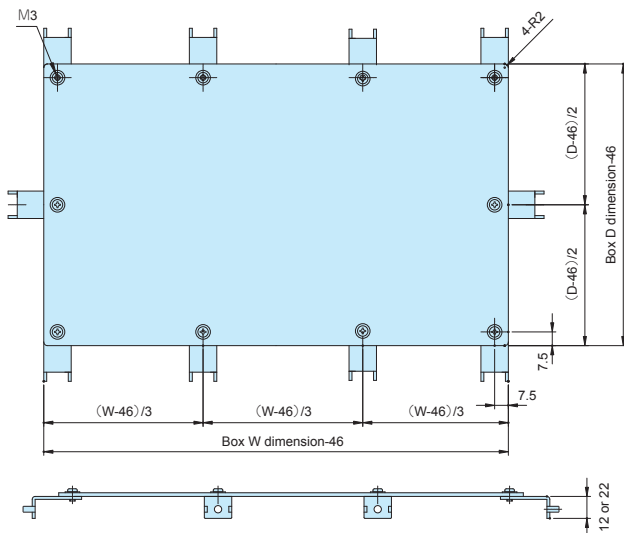

Included screws: M3-6 pan head trivalent chromate with flat washer x 20 pcs

Box W dimension	Box D dimension	Number of holes
601~1000mm	400~ 600mm	10
400~ 600mm	601~1000mm	10

For W and D dimensions :
 $W = 601 \sim 1,000\text{mm} \times D = 601 \sim 1,000\text{mm}$

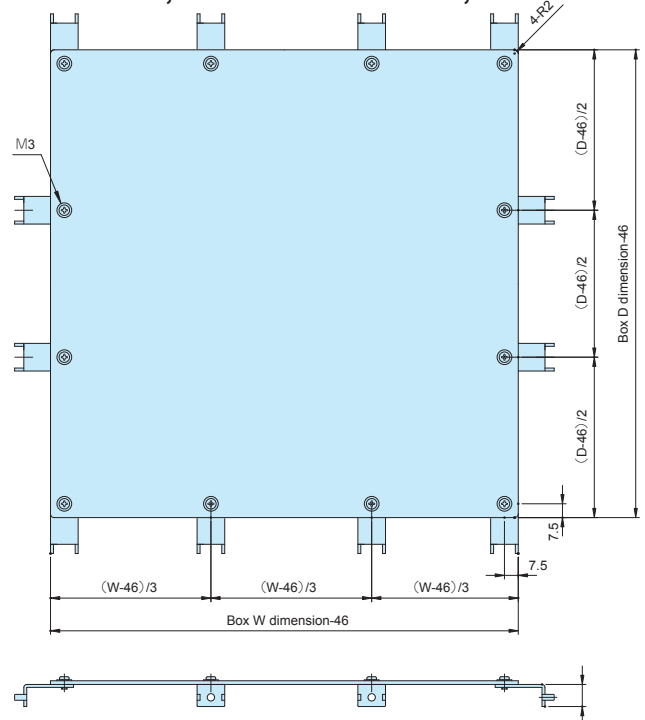

Included screws: M3-6 pan head trivalent chromate with flat washer x 24 pcs

Box W dimension	Box D dimension	Number of holes
601~1000mm	601~1000mm	12

FCC-K SERIES

MOUNTING PLATE REINFORCING BRACKET

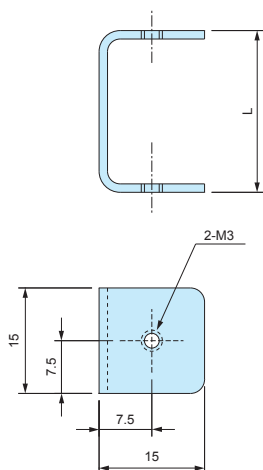

- Recommended to be used when a heavy load is attached onto the mounting plate.
- Requires 2 - $\Phi 3.5$ hole milling on the mounting plate for installation.
- Can be freely installed based on your requirements.
- Not suitable for FCS□-□-38 or FCWS□-□-38 models. (H = 37.9mm)
- Use FCC-K-1 for the mounting plate with FCK-1 brackets and use FCC-K-2 for the mounting plate with FCK-2 brackets.

INSTALLATION EXAMPLE

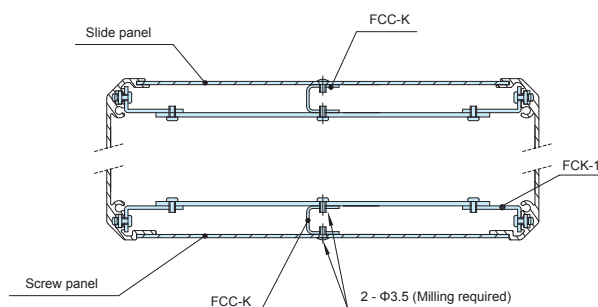

Product no. / Dimensions

Product no.	L	Matching bracket	Pack of
FCC-K-1	13	FCK-1	2
FCC-K-2	23	FCK-2	2

Included screws : M3-6 pan head trivalent chromate with flat washer x 2 pcs

M3-5 slotted raised countersunk nickel plated / black trivalent chromate x 2 pcs each

Accessories (Optional parts)

MR3-5Z SERIES

SLOTTED RAISED COUNTERSUNK TORX SCREW



- For use with panels.
- Recommended for aesthetic purposes, or for resistance against tampering.
- Requires the use of a specialized screwdriver.

Product no. / Dimensions

Product no.	M	L	TORX head no.	Material	Color / Finish	Pack of
MR3-5ZS	3	5	T10	Steel	Nickel plated	20
MR3-5ZB	3	5	T10	Steel	Black trivalent chromate	20

FCC drawings

■ DXF/DWG/PDF/STP drawings available on our website.

For box size (W x D or D x W) 400/500/600 x 400mm

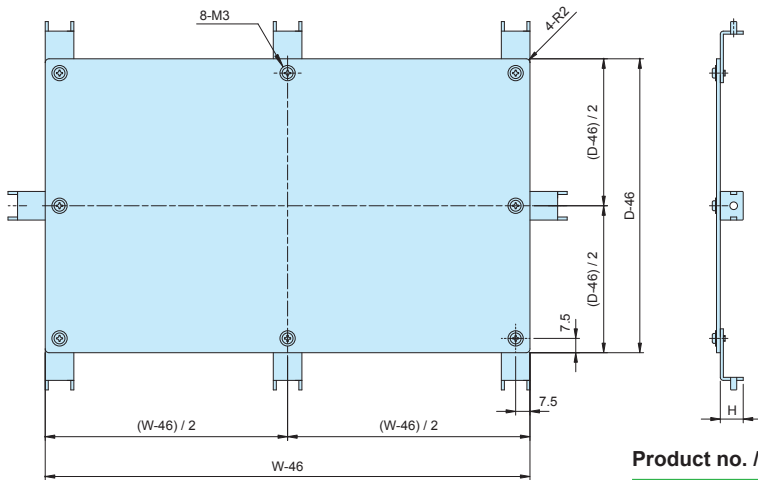

Product no. / Details

Product no.	H	Box W x D or D x W	Product no.	H	Box W x D or D x W
FCC40-40-1	12	400 × 400	FCC40-40-2	22	400 × 400
FCC50-40-1	12	500 × 400	FCC50-40-2	22	500 × 400
FCC60-40-1	12	600 × 400	FCC60-40-2	22	600 × 400

Included screws: M3-6 pan head trivalent chromate with flat washer x 16 pcs

Accessories (Optional parts)

FCK series

MOUNTING BRACKET

FCK drawings

■ DXF/DWG/PDF drawings available on our website.

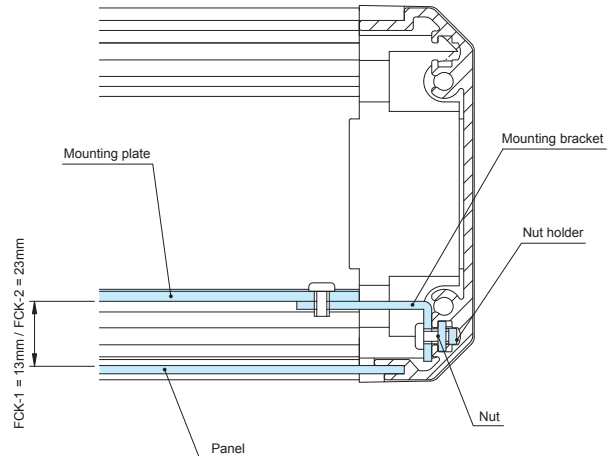
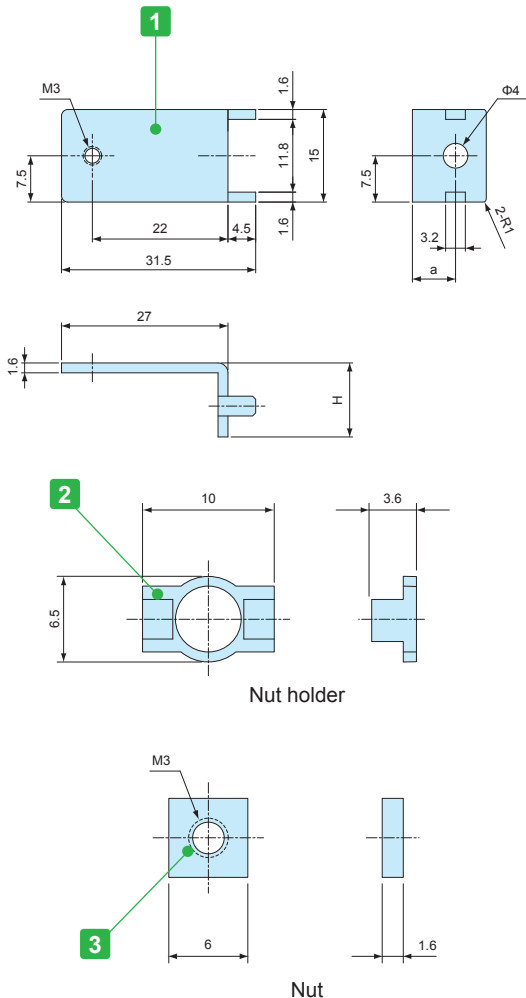

- 2 mounting brackets for PCB or DIN-Rail.
- FCK mounting bracket comes with FCC mounting plate.
Additional FCK is not required when purchasing FCC series.
- Not suitable for FC4 (H = 37.9mm).

Components

No.	Part name	Material	Color / Finish
1	Mounting bracket	Steel SECC t=1.6	Zinc coated
2	Nut holder	POM	Black
3	M3 nut	Steel SPCC t=1.6	Trivalent chromate

Product no. / Details

Product no.	H	a	Pack of
FCK-1	12	7	10
FCK-2	22	17	10

Included screws: M3-6 pan head trivalent chromate with flat washer x 20 pcs

FCC-K SERIES

MOUNTING PLATE REINFORCING BRACKET

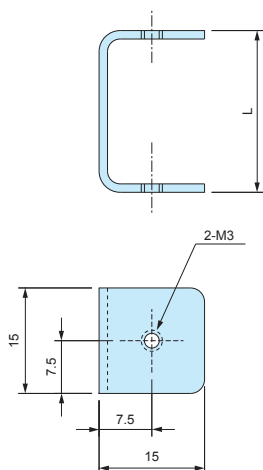

- Recommended to be used when a heavy load is attached onto the mounting plate.
- Requires 2 - $\Phi 3.5$ hole milling on the mounting plate for installation.
- Can be freely installed based on your requirements.
- Not suitable for FCS□-□-38 or FCWS□-□-38 models. (H = 37.9mm)
- Use FCC-K-1 for the mounting plate with FCK-1 brackets and use FCC-K-2 for the mounting plate with FCK-2 brackets.

INSTALLATION EXAMPLE

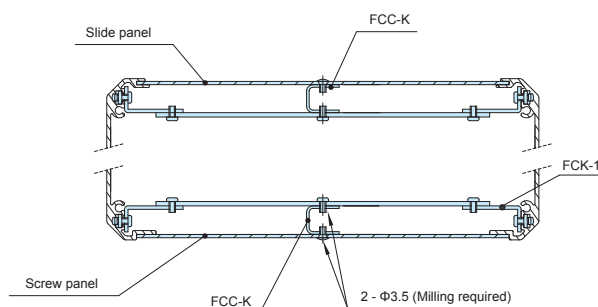

Product no. / Dimensions

Product no.	L	Matching bracket	Pack of
FCC-K-1	13	FCK-1	2
FCC-K-2	23	FCK-2	2

Included screws : M3-6 pan head trivalent chromate with flat washer x 2 pcs

M3-5 slotted raised countersunk nickel plated / black trivalent chromate x 2 pcs each

Accessories (Optional parts)

MR3-5Z SERIES

SLOTTED RAISED COUNTERSUNK TORX SCREW



- For use with panels.
- Recommended for aesthetic purposes, or for resistance against tampering.
- Requires the use of a specialized screwdriver.

Product no. / Dimensions

Product no.	M	L	TORX head no.	Material	Color / Finish	Pack of
MR3-5ZS	3	5	T10	Steel	Nickel plated	20
MR3-5ZB	3	5	T10	Steel	Black trivalent chromate	20

MAR series**WALL MOUNT SUPPORT ARM**

- Wall mount support arm move easily to the preferred positions.
- Suitable for command panel on machinery and touch panel controller. Easy installation onto the wall as well.
- Hole pitch on the monitor bracket is compatible with VESA mount standards. Possible to mount PC display without modification.

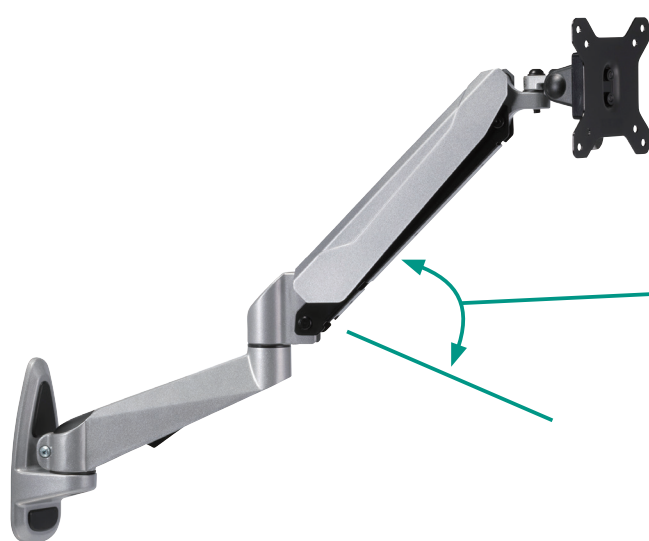
MAR specifications**MAR-312W**

Adjustable bolt for up/down direction on arm is firmly set initially.
Adjust the movement according to the installed device.

Arm can move in up/down direction.

Arm full length ~ 612mm

Max load : 6.5kg (including product weight, adjustable bolt firmly locked)

Material : Steel • Plastic • Aluminium diecast

*Wall mounting screws included.

Pan-Tilt bracket dimensions

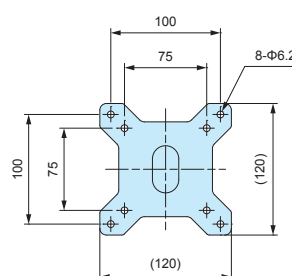

Wall mounting bracket dimensions

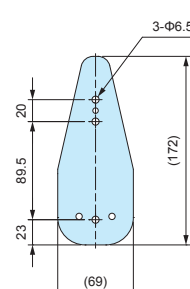

MAR-111W

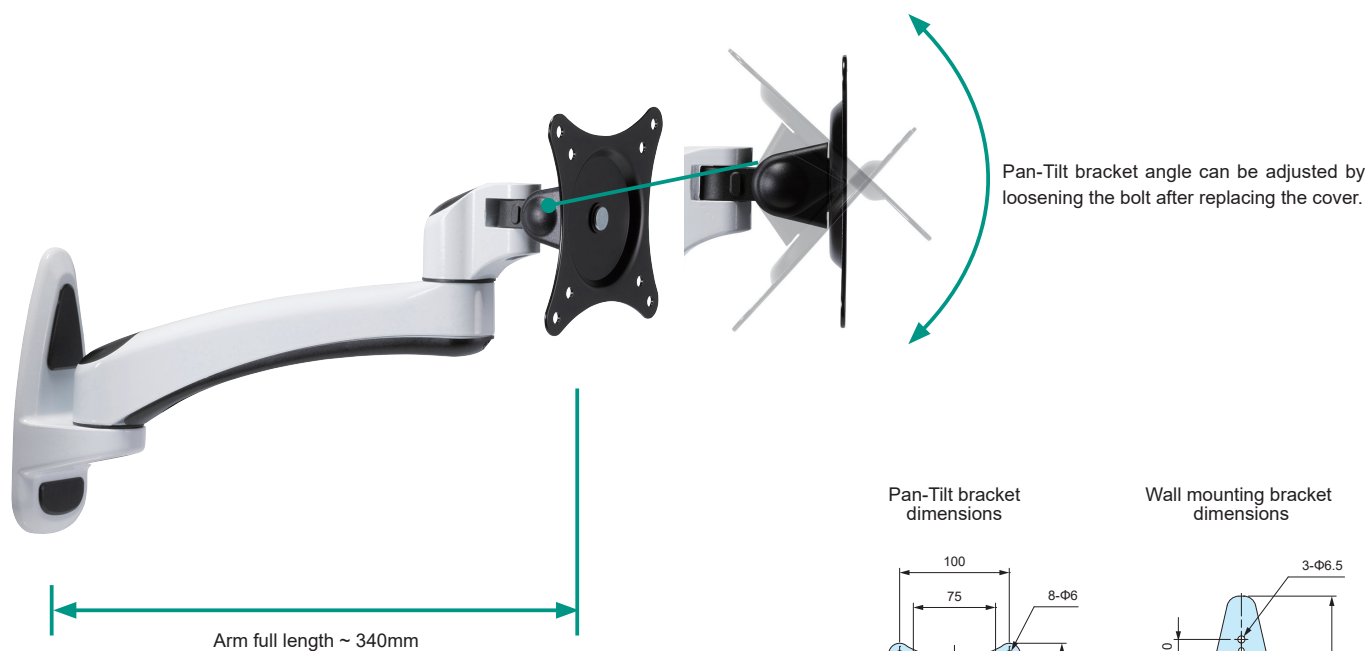

Max load : 8kg (including product weight)
 Material : Steel • Plastic • Aluminium diecast
 *Wall mounting screws included.

Pan-Tilt bracket dimensions

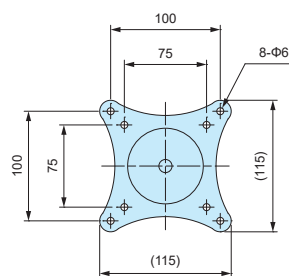

Wall mounting bracket dimensions

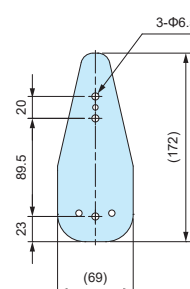

MAR-110W



*Pan-Tilt bracket does not move in up/down direction.

Pan-Tilt bracket dimensions

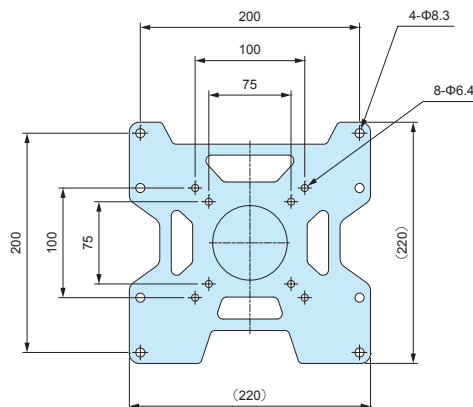

Wall mounting bracket dimensions

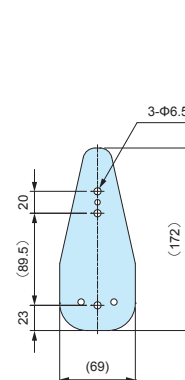

Max load : 8kg (including product weight)
 Material : Steel • Plastic • Aluminium diecast
 *Wall mounting screws included.

Product no. / Details

Product no.	Arm full length	Arm color	Weight (kg)
MAR-312W	~ 612mm	Metallic gray	2.2
MAR-111W	~ 340mm	White / Black	1.0
MAR-110W	~ 143mm	White / Black	1.0