

PORTABLE ALUMINIUM INSTRUMENT CASE with HANDLE

AUGH series Assembly instructions

Please read this instructions carefully before assembly.

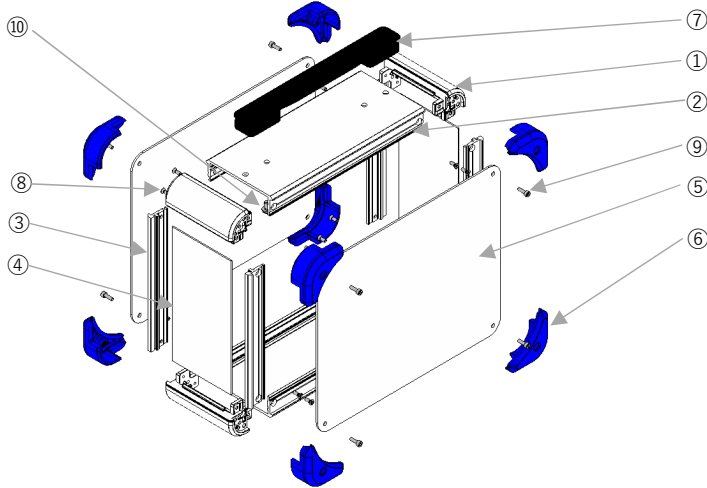

Before Assembly

1. Ensure that the ordered model and the product label on the package matches.
2. Some parts may have unused holes or leftover screws due to the parts standardization.
3. During assembly, ensure screw holes align perfectly. If not, loosen all screws and re-assemble.

Components

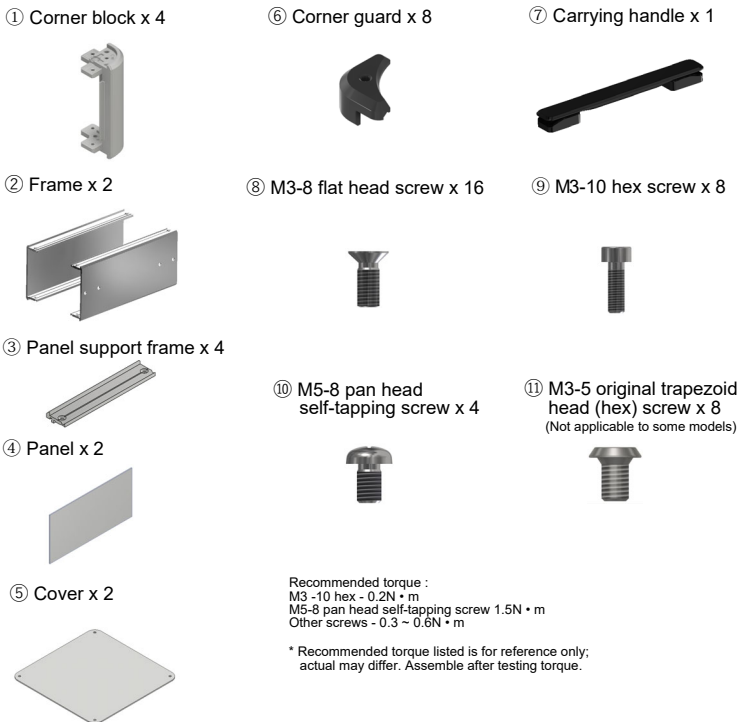

A Side Panels

Align ⑦ carrying handle to the ② frame part with holes on the body, and secure with ⑩ M5-8 pan head self-tapping screws.

Connect ① corner blocks onto the ② frames and secure with ⑧ M3-8 flat head screws.

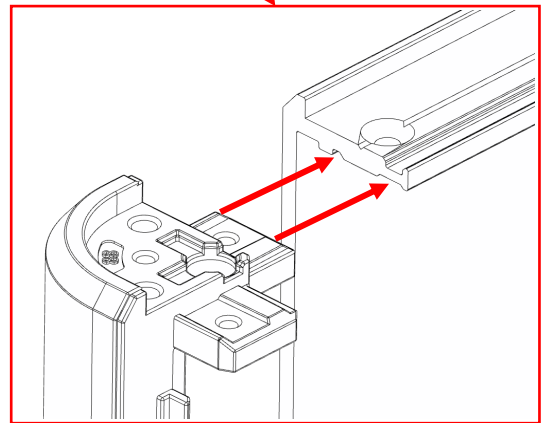
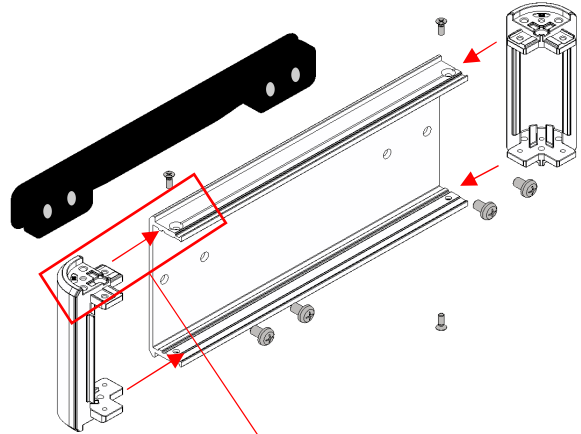

* Check that the ribs on ① corner block and the grooves on ② frame are aligned. Ensure the same for the opposite / bottom side.

B

Once the two ② frames are assembled as shown in the figure below, proceed to step C.

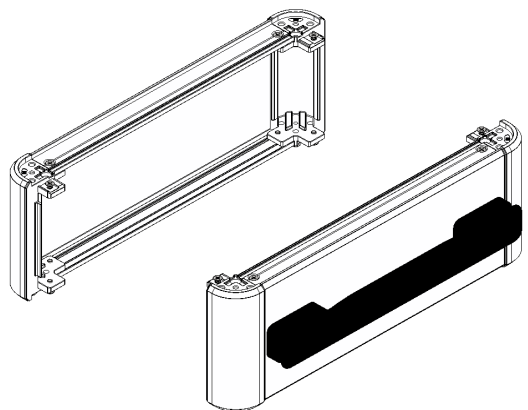

C Frame and Panels

Place ③ panel support frame onto ② assembled frames and secure with ⑧ M3-8 flat head screws.

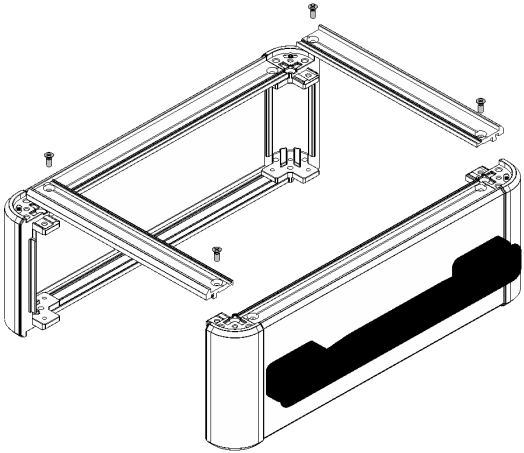

D Flip the assembled unit over and insert ④ panels into the groove of ③ frames.

Note: Remove the protective sheet from ④ panels before use.

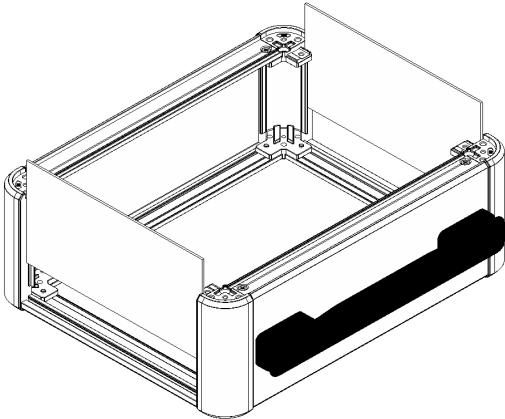

E Secure ④ panels with ③ panel support frame using ⑧ M3-8 flat head screws.

Note: If using an optional mounting plate, insert it before securing ④ panels.

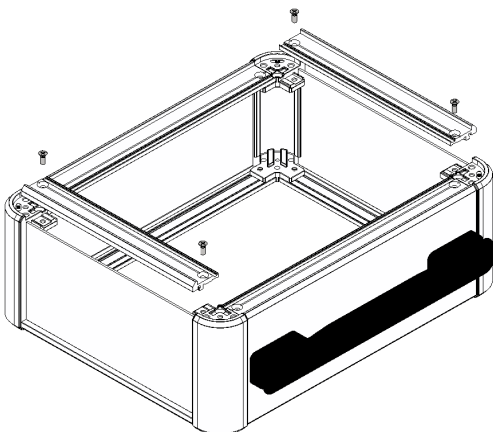

F Cover and Corner Guard

Set ⑤ cover onto the assembled unit and align mounting holes on ⑤ cover and ⑥ corner guards. Secure the parts together using ⑨ M3-10 hex screws.

Note:

Avoid over-tightening and damaging ⑥ corner guards. Remove the protective sheet from ⑤ cover before use.

Note :

If either W or D dimensions is 400mm or greater, an additional mounting hole is present. For this additional hole, use ⑪ M3-5 original trapezoid head (hex) screw.

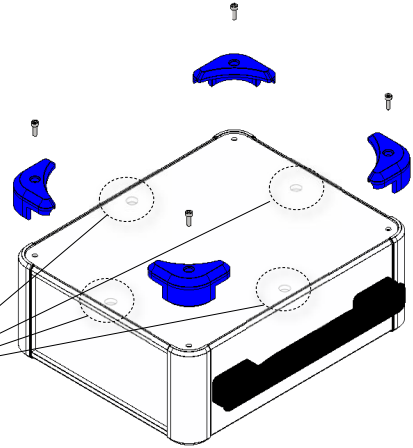

G Repeat step F to install remaining ⑥ corner guards (8 total) on the opposite side.

Note:

Avoid over-tightening and damaging ⑥ corner guards. Remove the protective sheet from ⑤ cover before use.

Note :

If either W or D dimensions is 400mm or greater, an additional mounting hole is present. For this additional hole, use ⑪ M3-5 original trapezoid head (hex) screw.

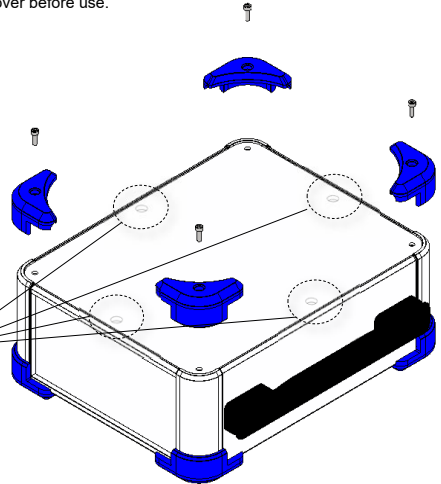

H

Completed!

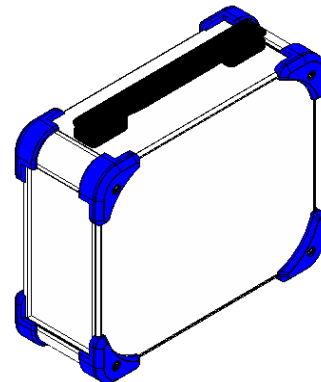

Customer Support

For any questions regarding assembly, please contact
TAKACHI ELECTRONICS ENCLOSURE CO., LTD. :
TEL : +81-48-222-5409 E-mail : sales@takachi-el.co.jp