

NOTICE

FCW and FCWS Series Changes to Panel Protection Pad

■ Affected series / models :

FCW Series : GS · BS · BX Color Type (Both key latch and keyless latch types)

FCWS Series : GSS · BSS · BBS Color Type (Both key latch and keyless latch types)

■ Changes : Discontinuation of Panel Protection Pad.

Current (Old) Design

New Design

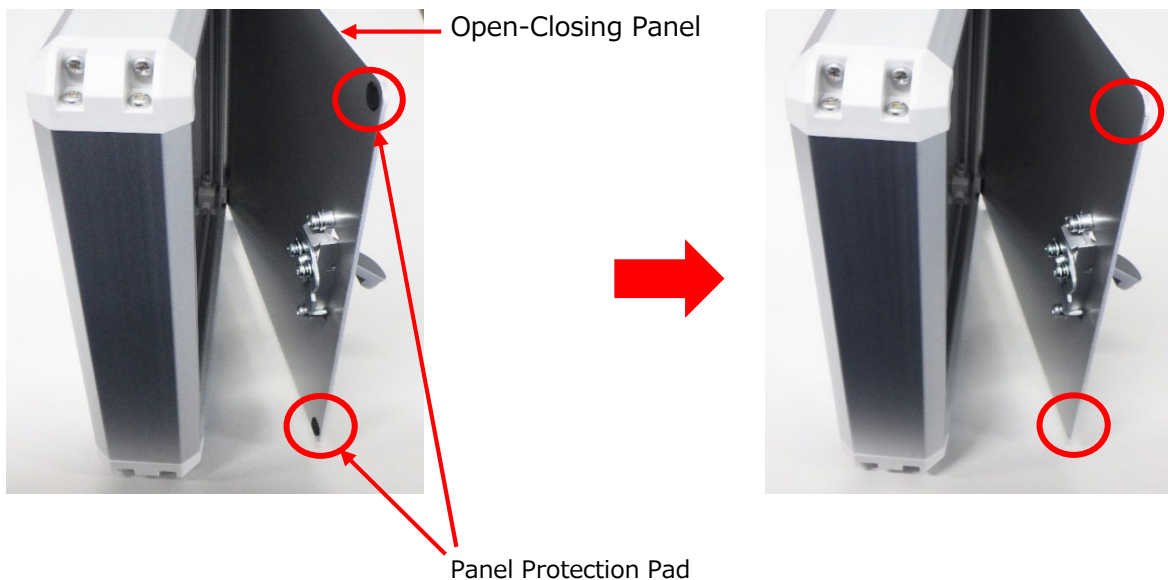

※Discontinuation of panel protection pad for FCW series BB color type, and FCWS series BBB color type was previously announced.

■ Purpose: To ensure consistent quality throughout via streamlined supply chain and materials.

■ Effective date : FCW Series : Once present inventory has run out / been depleted.

FCWS Series : Changes will take place from orders received after October 1, 2021.

■ Note 1: No changes to product's dimensions and surface finish.

■ Note 2: No changes to item product number or pricing.

Thank you for your understanding.

For more information, kindly contact us at: sales@takachi-el.co.jp